

# PLASTIC HOOD STRAIGHT EXIT WITH SPRING LATCHES FOR HALF PITCH CABLE FEMALE & MALE CONNECTORS

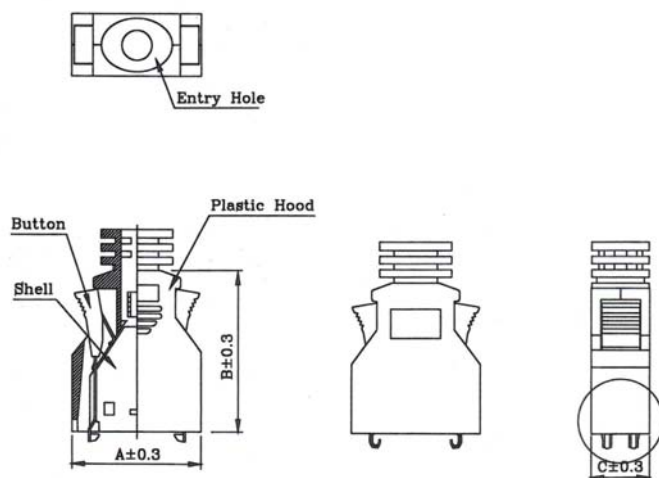

**14P**

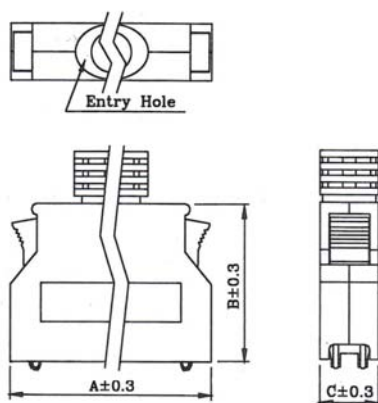

**20P, 26P, 36P, 50P**

## MATERIALS

**Housing:** Plastic Thermoplastic PC

**Screw:** Steel, Nickel Plated Over Copper

**Latch:** Stainless Steel

**Latch Cover:** Plastic Thermoplastic P.B.T. UL94V-0

**Nuts:** Steel, Nickel Plated Over Copper

**Cable Clipper:** Steel, Nickel Plated Over Copper

**\*RoHS & REACH compliant.**

No. of Contacts	A	B	C
14	26.00	30.30	12.00
20	30.00	31.50	12.50
26	33.70	31.40	12.50
36	40.00	31.40	11.50
50	49.20	31.40	12.50

## ORDERING INFORMATION:

**P/N PHL  $\frac{x}{1} \frac{x}{2} \frac{x}{3}$**

### 1. NO. OF CONTACTS:

14, 20, 26, 36, 50

### 2. ENTRY HOLE SIZES:

"4A" Ø4.5MM (14P)

"6" Ø6MM (14P, 20P)

"6A" Ø6.5MM (14P, 20P)

"7" Ø7MM (14P, 20P, 26P, 36P)

"7A" Ø7.5MM (14P, 20P)

"8" Ø8MM (14P, 20P, 26P, 36P)

"8A" Ø8.5MM (26P, 36P)

"9" Ø9MM (36P, 50P)

"10A" Ø10.5MM (50P)

### 3. HOOD COLOR:

"V" BEIGE

"B" BLACK

# PLASTIC HOOD STRAIGHT EXIT WITH JACK SCREWS FOR HALF PITCH CABLE FEMALE & MALE CONNECTORS

## MATERIALS

**Housing:** Plastic Thermoplastic PC

**Screw:** Steel, Nickel Plated Over Copper

**Latch:** Stainless Steel

**Latch Cover:** Plastic Thermoplastic P.B.T. UL94V-0

**Nuts:** Steel, Nickel Plated Over Copper

**Cable Clipper:** Steel, Nickel Plated Over Copper

**\*RoHS & REACH compliant.**



No. of Contacts	A	B	C
20	33.04	27.40	12.60
26	36.74	31.26	12.60
36	43.20	37.61	12.30

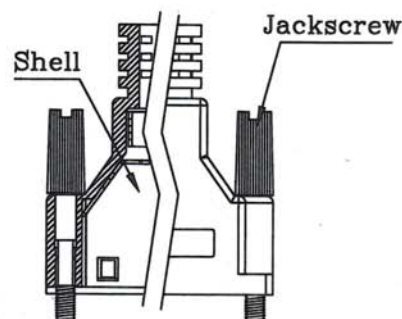
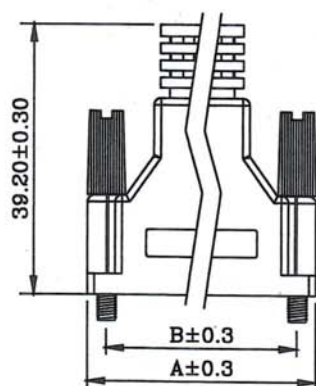

## ORDERING INFORMATION:

P/N PHS  $\frac{xx}{1} - \frac{xx}{2} \frac{xx}{3} \frac{xx}{4}$

### 1. NO. OF CONTACTS:

20, 26, 36

### 2. ENTRY HOLE SIZES:

"6" Ø6MM (20P)

"6A" Ø6.5MM (20P)

"7" Ø7MM (20P, 26P, 36P)

"7A" Ø7.5MM (20P)

"8" Ø8MM (26P, 36P)

"8A" Ø8.5MM (26P, 36P)

"9" Ø9MM (36P)

### 3. HOOD COLOR:

"V" BEIGE

"B" BLACK

### 4. THREADED FINISH:

"1" JACKSCREWS #2-56

"2" JACKSCREWS #4-40

"3" JACKSCREWS M2.6

# PLASTIC HOOD STRAIGHT EXIT WITH LATCHES & SCREWS FOR HALF PITCH CABLE FEMALE & MALE CONNECTORS

## MATERIALS

**Housing:** Plastic Thermoplastic PC

**Screw:** Steel, Nickel Plated Over Copper

**Latch:** Stainless Steel

**Latch Cover:** Plastic Thermoplastic P.B.T. UL94V-0

**Nuts:** Steel, Nickel Plated Over Copper

**Cable Clipper:** Steel, Nickel Plated Over Copper

**\*RoHS & REACH compliant.**

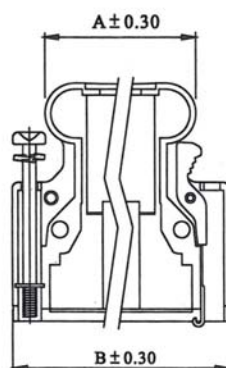
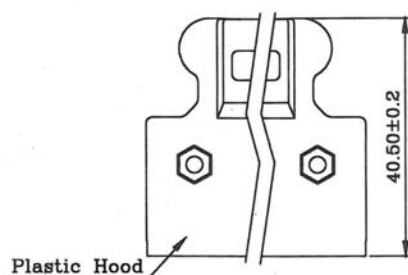
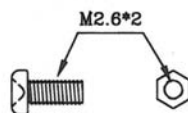
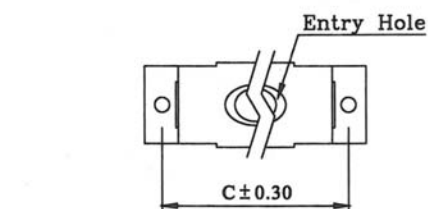

No. of Contacts	A	B	C
14	18.20	29.50	23.60
20	22.00	33.30	27.40
26	26.00	37.00	31.50
36	32.20	43.50	37.60
50	41.10	52.40	46.50

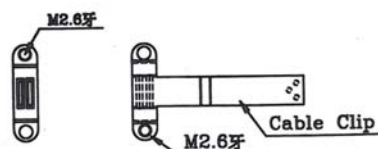
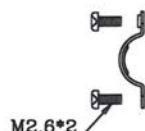
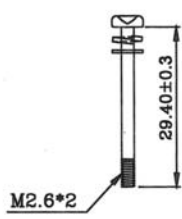
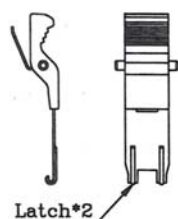

## ORDERING INFORMATION:

P/N P H L S  $\frac{x}{1} - \frac{x}{2} \frac{x}{3}$

### 1. NO. OF CONTACTS:

14, 20, 26, 36, 50

### 2. ENTRY HOLE SIZES:

"9" Ø9MM

"11" Ø11MM

"12" Ø12MM

"15A" Ø15.5MM

### 3. HOOD COLOR:

"V" BEIGE

"B" BLACK

# METAL HOOD STRAIGHT EXIT WITH SPRING LATCHES FOR HALF PITCH CABLE FEMALE & MALE CONNECTORS

## MATERIALS

**Backshell:** Zinc Alloy, Nickel Plated Over Copper

**Spring Latches:** Stainless Steel

**Flat Screws:** Steel, Nickel Plated Over Copper

**Cable Clipper:** Steel, Nickel Plated Over Copper

**\*RoHS & REACH compliant.**

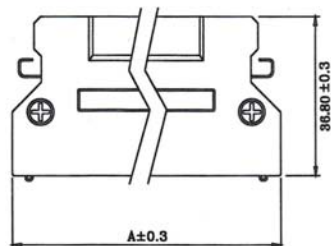
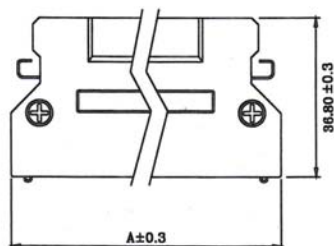

No. of Contacts	A
20	31.60
26	35.20
36	41.50
40	44.15
50	50.50
68	61.30

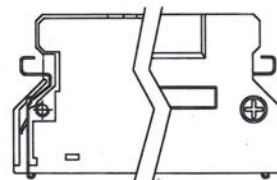
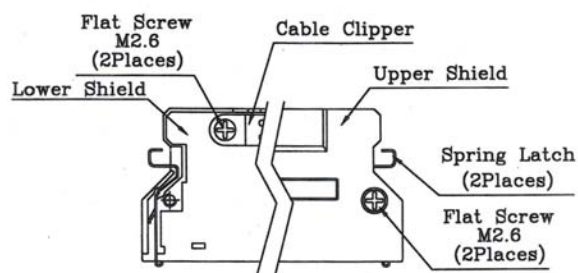
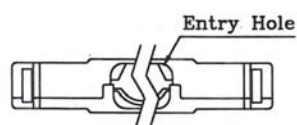

## CLOSE TYPE

(For Clip S.M.T. Connector With Terminator)

## ORDERING INFORMATION:

P/N M H L  $\frac{xx}{1} - \frac{xxx}{2} \frac{x}{3}$

### 1. NO. OF CONTACTS:

20, 26, 36, 40, 50, 68

### 2. ENTRY HOLE SIZES:

"0" CLOSE TYPE (50P, 68P)

"7" Ø7MM (20P, 26P)

"7A" Ø7.5MM (36P)

"8" Ø8MM (20P, 26P)

"9" Ø9MM (36P, 40P, 50P)

"10A" Ø10.5MM (40P)

"11" Ø11MM (50P, 68P)

"14" Ø14MM (68P)

### 3. BACKSHELL FINISH:

"N" NICKEL PLATED (STANDARD)

"G" GOLD PLATED

## METAL HOOD ANGLED EXIT WITH SPRING LATCHES FOR HALF PITCH CABLE FEMALE & MALE CONNECTORS

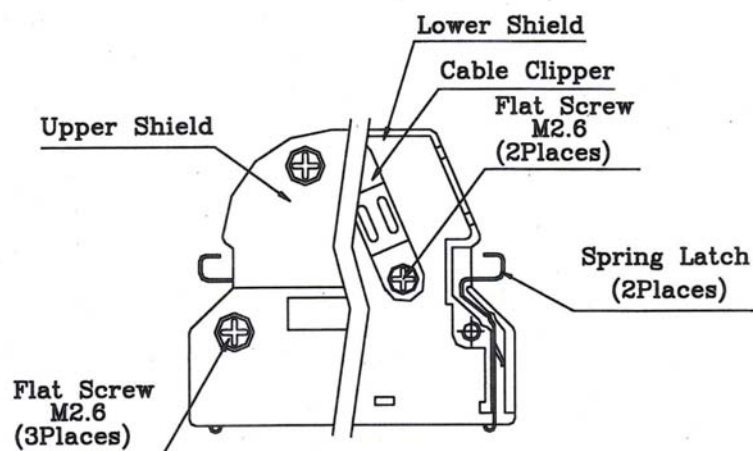

### MATERIALS

Backshell: Zinc Alloy, Nickel Plated Over Copper

Spring Latches: Stainless Steel

Flat Screws: Steel, Nickel Plated Over Copper

Cable Clipper: Steel, Nickel Plated Over Copper

\*RoHS & REACH compliant.

No. of Contacts	A	B	C
26	35.40	48.60	13.20
36	41.50	46.30	13.00
50	50.50	46.25	13.30
68	61.30	46.30	15.60

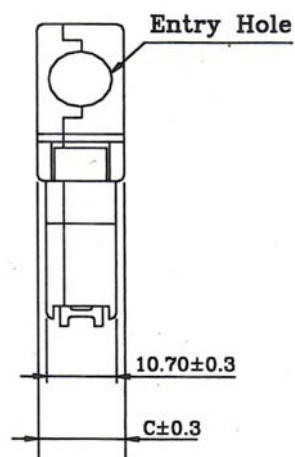
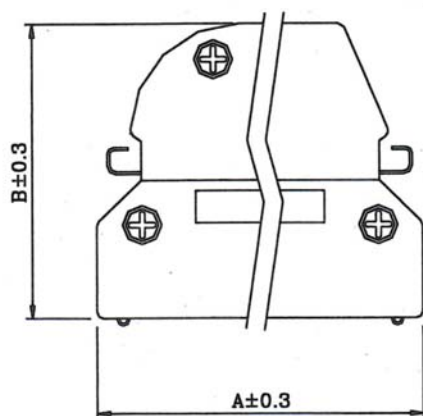

### ORDERING INFORMATION:

P/N M H R  $\frac{xx}{1} - \frac{xxx}{2\ 3}$

#### 1. NO. OF CONTACTS:

"26" 60°  
"36" 67°  
"50" 67°  
"68" 70°

#### 2. ENTRY HOLE SIZES:

"8" Ø8MM (26P)  
"9" Ø9MM (26P, 36P, 50P)  
"10" Ø10MM (36P)  
"11" Ø11MM (50P, 68P)  
"12" Ø12MM (68P)

#### 3. BACKSHELL FINISH:

"N" NICKEL PLATED (STANDARD)  
"G" GOLD PLATED

# METAL HOOD STRAIGHT EXIT WITH JACKSCREWS FOR HALF PITCH CABLE FEMALE & MALE CONNECTORS

No. of Contacts	A	B	C	D
40	46.60	38.70	11.70	13.00
50	53.30	38.60	11.70	13.60
68	64.10	38.30	11.90	13.90
100	84.20	38.20	12.10	17.50

## MATERIALS

**Backshell:** Zinc Alloy, Nickel Plated Over Copper

**Spring Latches:** Stainless Steel

**Flat Screws:** Steel, Nickel Plated Over Copper

**Cable Clipper:** Steel, Nickel Plated Over Copper

\*RoHS & REACH compliant.

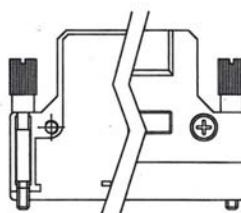
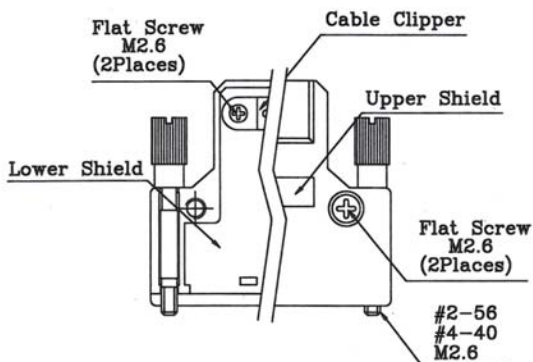
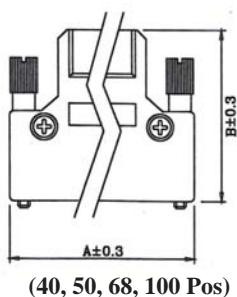
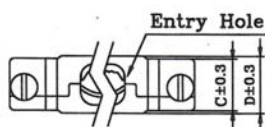
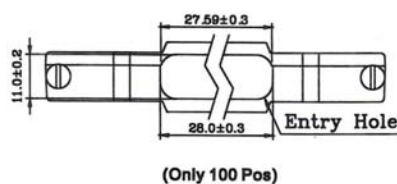

## CLOSE TYPE

(For Clip S.M.T. Connector With Terminator)

## ORDERING INFORMATION:

P/N M H S  $\frac{x}{1} - \frac{x}{2} \frac{x}{3} \frac{x}{4}$

### 1. NO. OF CONTACTS:

40, 50, 68, 100

### 2. ENTRY HOLE SIZES:

"0" CLOSE TYPE (50P, 68P)

"9" Ø9MM (40P, 50P)

"11" Ø11MM (50P, 68P, 100P)

"14" Ø14MM (68P, 100P)

"Y" ONLY 100 POS.

### 3. BACKSHELL FINISH:

"N" NICKEL PLATED (STANDARD)

"G" GOLD PLATED

### 4. THREADED FINISH:

"1" JACKSCREWS #2-56

"2" JACKSCREWS #4-40

"3" JACKSCREWS M2.6

## METAL HOOD STRAIGHT EXIT WITH LATCHES & SCREWS FOR HALF PITCH CABLE FEMALE & MALE CONNECTORS

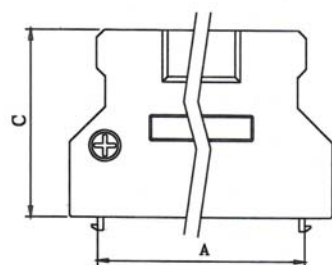
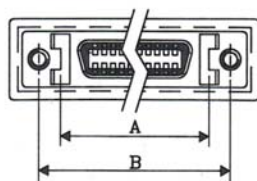
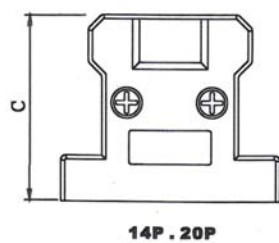

**L Type**  
(26.36.50.68)

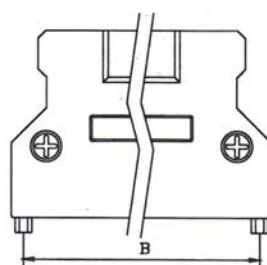

**S Type**  
(26.36.50.68)

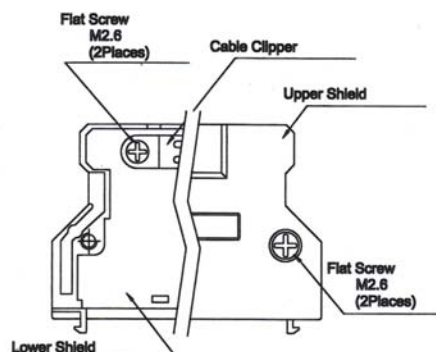
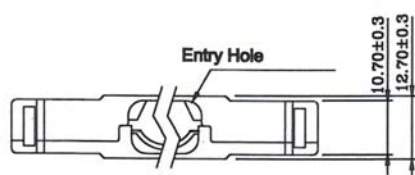

### MATERIALS

**Backshell:** Zinc Alloy, Nickel Plated Over Copper

**Spring Latches:** Stainless Steel

**Flat Screws:** Steel, Nickel Plated Over Copper

**Cable Clipper:** Steel, Nickel Plated Over Copper

\*RoHS & REACH compliant.

No. of Contacts	A	B	C
14	17.08	23.64	26.00
20	20.60	27.45	27.50
26	24.64	31.26	36.70
36	31.05	37.61	36.70
50	39.88	46.50	36.70
68	51.32	57.90	36.70

### ORDERING INFORMATION:

P/N M H E  $\frac{x}{1} \frac{x}{2} \frac{x}{3} - \frac{x}{4} \frac{x}{5} \frac{N}{x}$

#### 1. BRACKET TYPE:

"L" LATCH BRACKET

"S" SCREW BRACKET

#### 2. NO. OF CONTACTS:

14, 20, 26, 36, 50, 68

#### 3. ENTRY HOLE SIZES:

"7" Ø7MM (14P, 20P)

"7A" Ø7.5MM (26P, 36P)

"9" Ø9MM (26P, 36P, 50P)

"11" Ø11MM (50P, 68P)

"12" Ø12MM

"14" Ø14MM

"15" Ø15.5MM

#### 4. BACKSHELL FINISH:

"N" NICKEL PLATED (STANDARD)

#### 5. THREADED FINISH:

(ONLY FOR SCREW BRACKET)

"1" JACKSCREWS #2-56

"2" JACKSCREWS #4-40

"3" JACKSCREWS M2.6