

SMA ADAPTERS (1)

SA722CU-X*GT50
SMA DOUBLE MALE



SA723CU-X*GT50
SMA DOUBLE FEMALE



SA721CU-X*GT50
SMA DOUBLE FEMALE
BULKHEAD TYPE



SA720CU-X*GT50
SMA MALE TO SMA FEMALE
RIGHT ANGLE TYPE

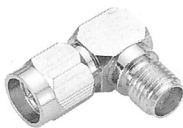

SA719CU-X*GT50
SMA MALE TO
SMA DOUBLE FEMALE



SA718CU-X*GT50
SMA TRIPLE FEMALE



SA770CU-X*GT50
SMA DOUBLE MALE
RIGHT ANGLE TYPE

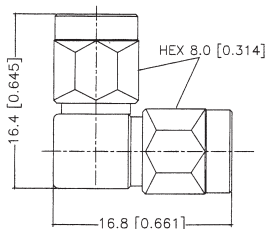

SA814CU-X*GT50
SMA DOUBLE MALE
RIGHT ANGLE TYPE

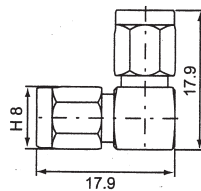

SA815CU-X*GT50
SMA DOUBLE FEMALE
RIGHT ANGLE TYPE

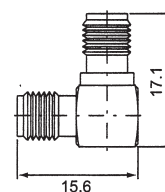

SA813CU-X*GT50
SMA MALE TO
SMA FEMALE

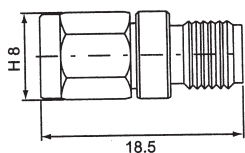

SA812CU-X*GT50
SMA MALE TO TNC FEMALE
BULKHEAD TYPE

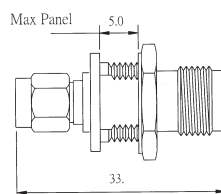

SA816CU-X*GT50
SMA FEMALE TO
MCX FEMALE

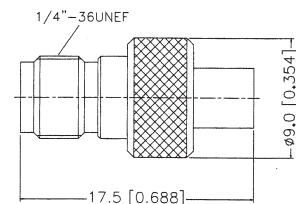

SMA ADAPTERS (2)

B162CU-X*50**

BNC MALE TO SMA MALE



T259CU-X*50**

TNC MALE TO SMA MALE



NP664CU-X*GT50

FME MALE TO SMA MALE



B164CU-X*50**

BNC MALE TO SMA FEMALE



T261CU-X*50**

TNC MALE TO SMA FEMALE



NP654CU-X*GT50

FME MALE TO SMA FEMALE



B163CU-X**50**

BNC FEMALE TO SMA MALE



T260CU-X*50**

TNC FEMALE TO SMA MALE



NP668CU-X*GT50

FME FEMALE TO SMA MALE



B165CU-X*50**

BNC FEMALE TO SMA FEMALE



T262CU-X*50**

TNC FEMALE TO SMA FEMALE



NP672CU-X*GT50

FME FEMALE TO SMA FEMALE



SMA ADAPTERS (3)

SA827CU-XGGT50
SMA DOUBLE FEMALE
PANEL MOUNT TYPE

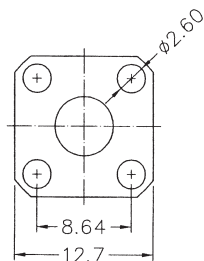
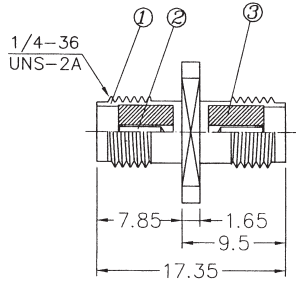

MU558CU-X*GT50
MINI UHF MALE TO
SMA MALE

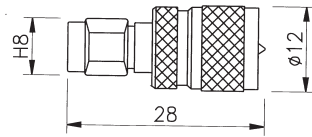

N342CU-X*GT50
N MALE TO SMA MALE

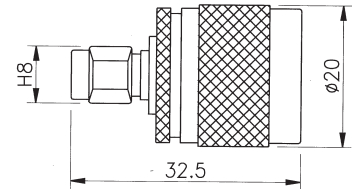

MU560CU-X*GT50
MINI UHF MALE TO
SMA FEMALE

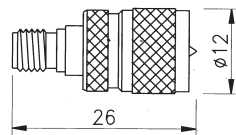

N344CU-X*GT50
N MALE TO SMA FEMALE

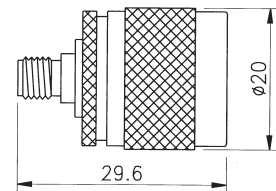

SA828CU-XGGT50
SMA DOUBLE FEMALE
BULKHEAD TYPE

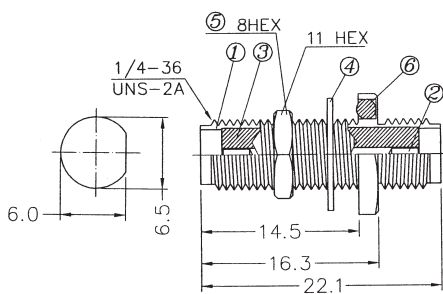

MATERIAL AND FINISH

- ① ④ ⑤ BRASS/ 5u" GOLD PLATED
- ② BERYLLIUM COPPER/ 30u" GOLD
- ③ TEFLON
- ⑥ SILICON RUBBER

MU559CU-X*GT50
MINI UHF FEMALE TO
SMA MALE

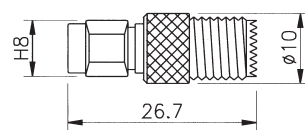

N343CU-X*GT50
N FEMALE TO SMA MALE

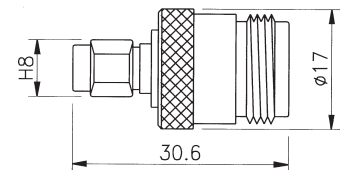

MU561CU-X*GT50
MINI UHF FEMALE TO
SMA FEMALE

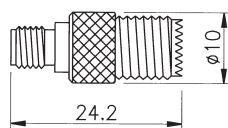

N345CU-X*GT50
N FEMALE TO SMA FEMALE

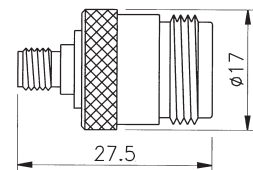

SMA ADAPTERS (4)

SA866CU-XGGT50

SMA DOUBLE FEMALE
WITH SQUARE FLANGE

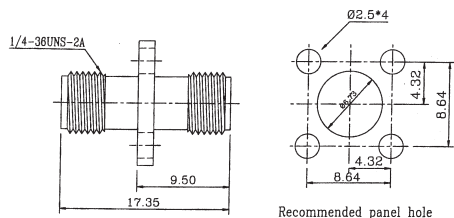

SA867CU-XGGT50

SMA DOUBLE MALE
QUICK FIT TYPE

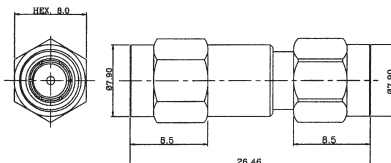

SA868CU-XGGT50

SMA MALE TO SMA FEMALE
QUICK FIT TYPE

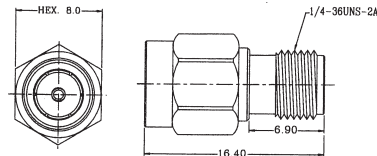

SA869CU-XGGT50

SMA MALE TO SMA FEMALE
QUICK FIT TYPE

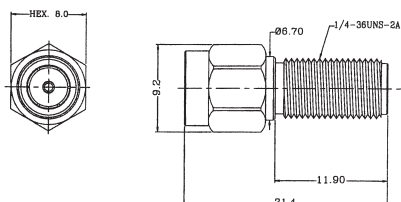

SA870CU-XGGT50

SMA MALE TO E.FL FEMALE
CONVERSION TYPE

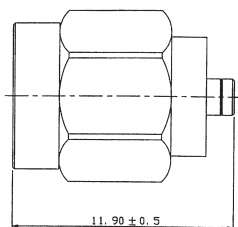

SA871CU-XGGT50

SMA FEMALE TO E.FL MALE
CONVERSION TYPE

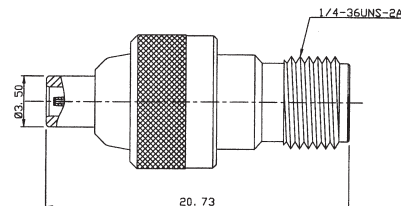

SA872CU-XGGT50

SMA MALE TERMINATOR
WITH 1/3W RESISTOR

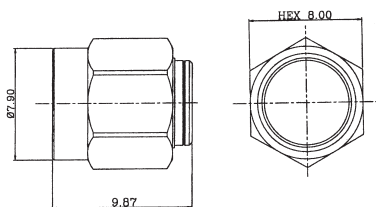

MM871CU-XGGT50

MMCX FEMALE TO
SMA FEMALE

