

## SMB SERIES CONNECTORS & ADAPTERS

### 50 Ohm 0-4GHz

The SMB subminiature coaxial connectors are semi-precision and provide repeatable electrical performance to 4GHz with 50-Ohm impedance.

Its smaller physical size and snap-on coupling make the SMB as an ideal generally purpose connector where packaging density, easy of connecting and disconnecting and economy are prerequisites.

The SMB connectors are applications for telecommunications, test equipment, instrumentation and GPS.

### Interface Dimensions:

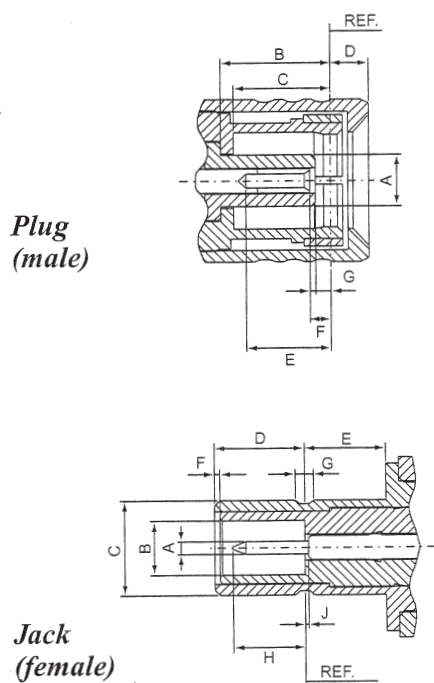

	Plug		Jack	
	min.	max.	min.	max.
A	-	2.06/.081	0.48/.019	0.53/.021
B	3.58/.141	-	2.08/.082	-
C	3.58/.141	-	3.66/.144	3.71/.146
D	-	1.63/.064	3.33/.131	3.58/.141
E	2.97/.117	-	1.65/.065	-
F	0.18/.007	0.94/.037	0.00/.000	-
G	0.18/.007	-	0.69/.027	0.94/.037
H	-	-	-	2.97/.117
J	-	-	-	0.18/.007

### Electrical:

Impedance	50 ohm
Frequency Range	0 to 4.0 GHz
VSWR	RG-178U → 1.3+0.04 f max GHz (Straight) 1.45+0.06 f max GHz (Right angle)
	RG-316U → 1.25+0.04 f max GHz (Straight) 1.35+0.04 f max GHz (Right angle)
Insertion Loss	0.3dB max @ 1.5GHz (Straight)
	0.6dB max @ 1.5GHz (Right angle)

## SMB FEMALE CONNECTORS (1)

### SB303CU-\*GGT50

SMB JACK CRIMP  
BULKHEAD TYPE  
RG316U, RG174U, RG188U:  
**SB303CU-LGGT50**

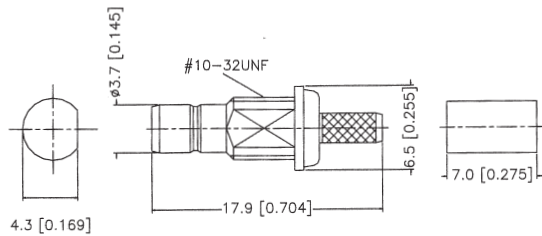

### SB304CU-XGGT50

SMB JACK WITH 4 LEGS  
PCB MOUNT TYPE

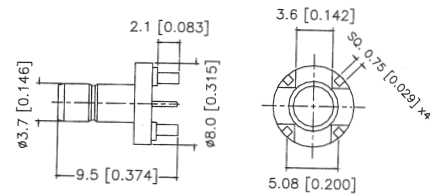

### SB308CU-\*GGT\*\*

SMB JACK CRIMP TYPE  
RG316U, RG174U, RG188U:  
**SB308CU-LGGT50**

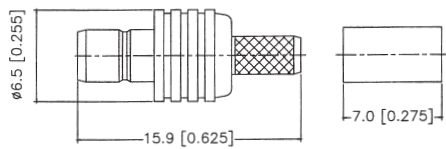

### SB305CU-XGGT\*\*

SMB JACK WITH 4 LEGS  
PCB MOUNT TYPE  
PART NO.:  
**SB305CU-XGGT50**  
**SB305CU-XGGT75**

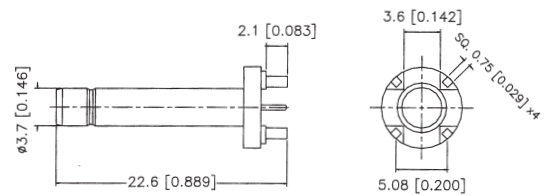

### SB314CU-\*GGT50

SMB JACK CRIMP  
RIGHT ANGLE TYPE  
RG316U, RG174U, RG188U:  
**SB314CU-LGGT50**

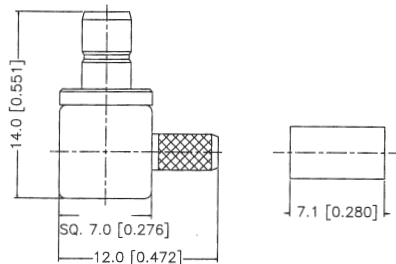

### SB322CU-XGGT50

SMB JACK  
SMT PCB MOUNT TYPE

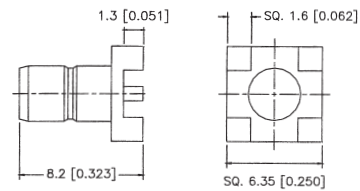

## SMB FEMALE CONNECTORS (2)

### SB323CU-XGGT50

SMB JACK WITH 4 LEGS  
BULKHEAD TYPE  
FOR PCB MOUNT

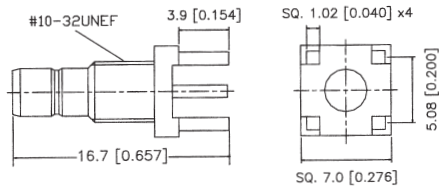

### SB325CU-XGGT\*\*

SMB JACK WITH 4 LEGS  
RIGHT ANGLE BULKHEAD  
PCB MOUNT TYPE

PART NO.:

**SB325CU-XGGT50**

**SB325CU-XGGT75**

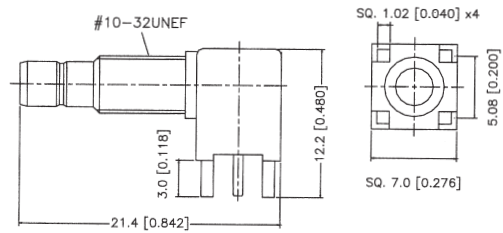

### SB319CU-XGGT\*\*

SMB JACK BULKHEAD  
FRONT MOUNT TYPE  
STANDARD PART NO.:

**SB319CU-XGGT50**

**SB319CU-XGGT75**

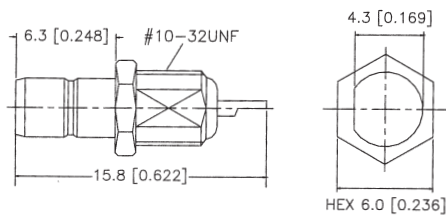

### SB313CU-XGGT50

SMB JACK WITH 4 LEGS  
R/A PCB MOUNT TYPE

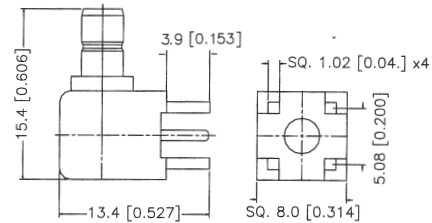

### SB310CU-XGGT50

SMB JACK BULKHEAD  
REAR MOUNT TYPE

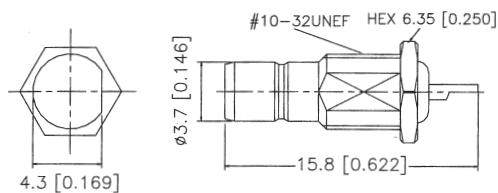

### SB327CU-XGGT\*\*

SMB JACK RIGHT ANGLE  
SCREW-ON TYPE

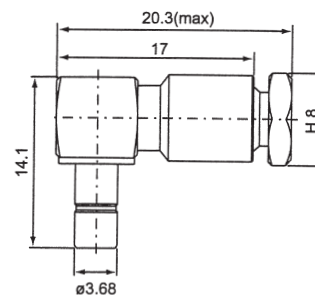

## SMB FEMALE CONNECTORS (3)

### SB328CU-\*GGT\*\*

SMB JACK RIGHT ANGLE  
CRIMP BULKHEAD TYPE  
RG174U, RG316U, RG188U:

### SB328CU-LGGT50

RG178U, RG196U:

### SB328CU-MGGT50

RG179U, RG187U:

### SB328CU-NGGT75

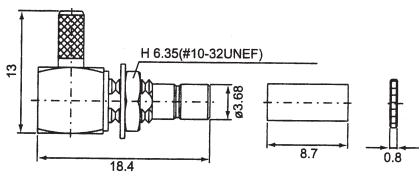

### SB329CU-XGGT\*\*

SMB JCK  
SCREW-ON TYPE

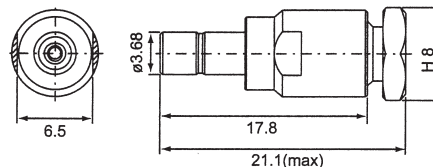

### SB355CU-XGGT\*\*

SMB JACK  
SOLDER BULKHEAD TYPE

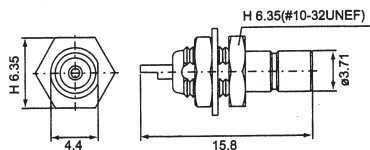

### SB356CU-\*GGT\*\*

SMB JACK STRAIGHT  
CRIMP BULKHEAD TYPE  
RG174U, RG316U, RG188U:

### SB356CU-LGGT50

RG178U, RG196U:

### SB356CU-MGGT50

RG179U, RG187U:

### SB356CU-NGGT75

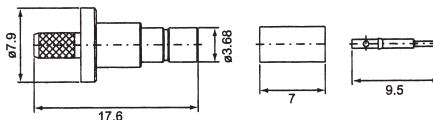

### SB339CU-XGGT\*\*

SMB JACK RIGHT ANGLE  
PCB MOUNT TYPE

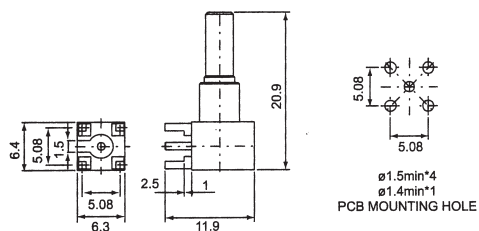

### SB340CU-XGGT\*\*

SMB JACK SOLDER  
PANEL MOUNT TYPE

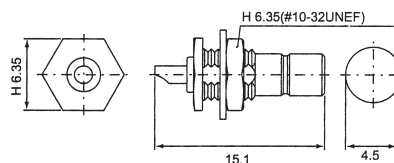

## SMB FEMALE CONNECTORS (4)

### SB332CU-XGGT\*\*

SMB JACK STRAIGHT  
PCB MOUNT TYPE

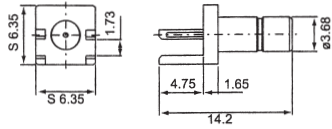

### SB333CU-XGGT\*\*

SMB JACK STRAIGHT  
PCB MOUNT TYPE

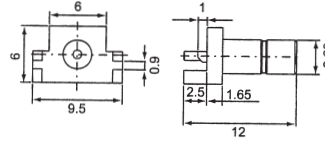

### SB334CU-XGGT\*\*

SMB JACK STRAIGHT  
PCB MOUNT TYPE

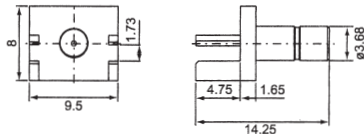

### SB335CU-XGGT\*\*

SMB JACK BULKHEAD  
PCB MOUNT TYPE

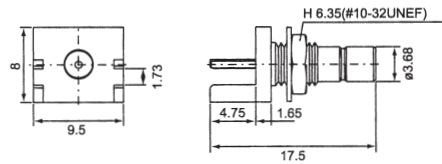

### SB341CU-XGGT\*\*

### SB342CU-XGGT\*\*

### SB343CU-XGGT\*\*

### SB344CU-XGGT\*\*

### SB345CU-XGGT\*\*

### SB346CU-XGGT\*\*

SMB JACK RIGHT ANGLE  
PCB MOUNT TYPE

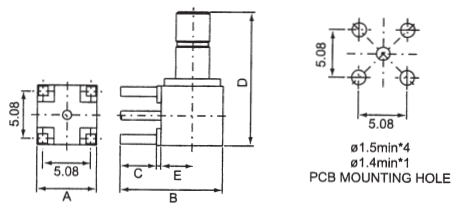

### SB336CU-XGGT\*\*

### SB337CU-XGGT\*\*

### SB338CU-XGGT\*\*

SMB JACK RIGHT ANGLE  
PCB MOUNT TYPE

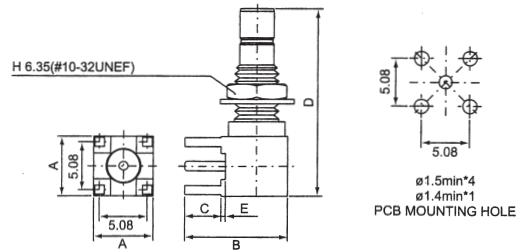

PART NO.	A	B	C	D	E
SB341CU	6.35	11	3.9	14.25	0.5
SB342CU	6.3	11	2.25	14.2	0.5
SB343CU	6.35	9.2	2.1	14.25	0.5
SB344CU	6.5	10.5	3.4	12.9	0.7
SB345CU	6.35	10.3	2.8	12.7	0.5
SB346CU	6.35	11.1	4	12.8	0.7

PART NO.	A	B	C	D	E
SB336CU	6.35	11	3.9	19.9	0.5
SB337CU	7.92	11.61	3.94	20.62	0.51
SB338CU	6.5	11.61	3.94	19.2	0.51

## SMB FEMALE CONNECTORS (5)

**SB357CU-XGGT\*\***  
SMB JACK RIGHT ANGLE  
PCB MOUNT TYPE

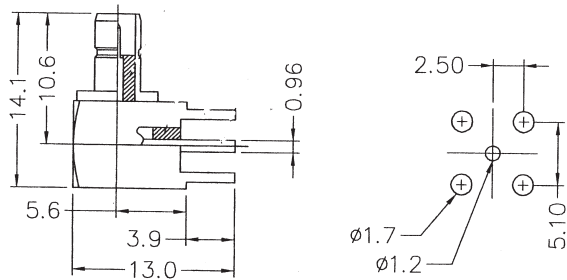

**SB358CU-XGGT\*\***  
SMB JACK STRAIGHT  
PCB MOUNT TYPE

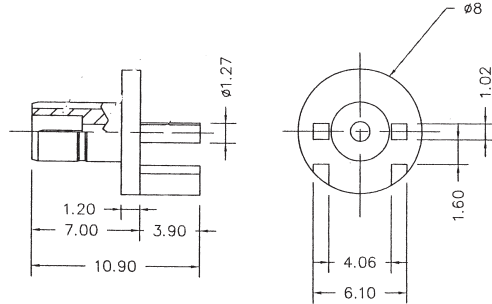

**SB320CU-XGGT50**  
SMB JACK 4 HOLE FALNGE  
WITH EXPOSED TEFLON  
PANEL MOUNT TYPE

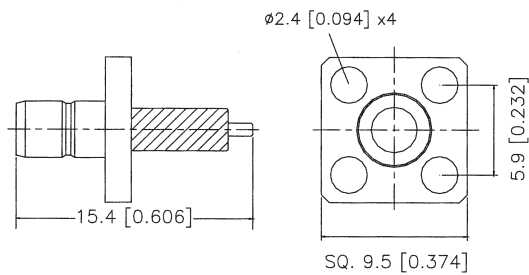

**SB321CU-XGGT\*\***  
SMB JACK PANEL MOUNT  
WITH 4 HOLE FLANGES  
PART NO.:  
**SB321CU-XGGT50**  
**SB321CU-XGGT75**

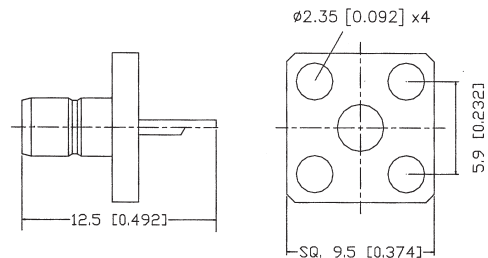

**SB330CU-XGGT\*\***  
**SB331CU-XGGT\*\***  
SMB JACK STRAIGHT  
PCB MOUNT TYPE

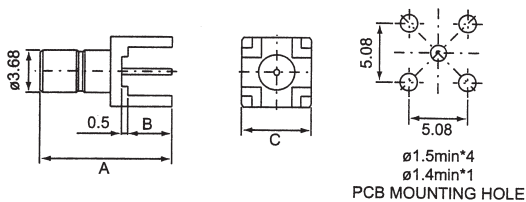

PART NO.	A	B	C
SB330CU	11.4	3.9	6.35
SB331CU	11.4	3.9	6

**SB359CU-XGGT\*\***  
SMB JACK WITH 4 LEGS  
PCB MOUNT TYPE

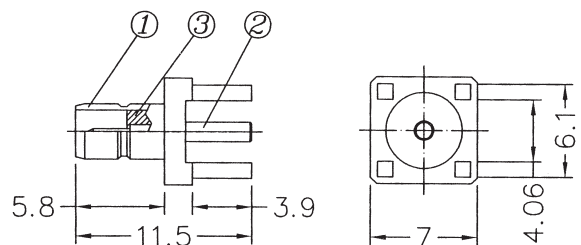



## SMB FEMALE CONNECTORS (6)

### SB361CU-\*GGT\*\*

SMB JACK CRIMP TYPE

RG174U, RG316U:

**SB361CU-LGGT50**

RG179U, RG187U:

**SB361CU-NGGT75**

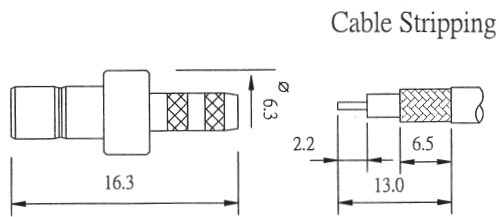

### SB363CU-\*GGT\*\*

SMB JACK CRIMP

RIGHT ANGLE TYPE

RG174U, RG316U:

**SB363CU-LGGT50**

RG179U, RG187U:

**SB363CU-NGGT75**

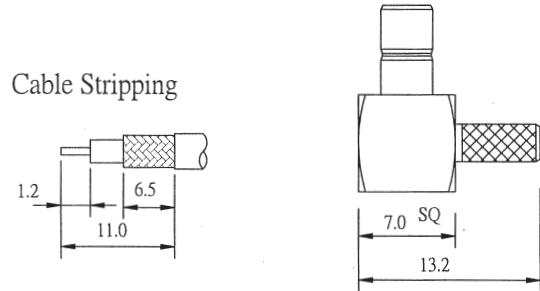

### SB378CU-LGGT50

SMB JACK CRIMP TYPE

FOR RG174, 188, 316/U CABLE

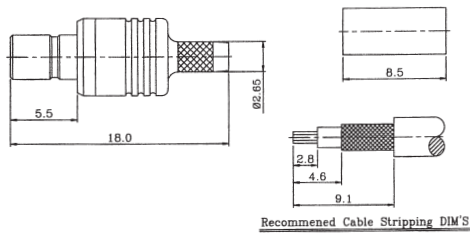

### SB377CU-XGGT50

SMB BULKHEAD SOLDER JACK

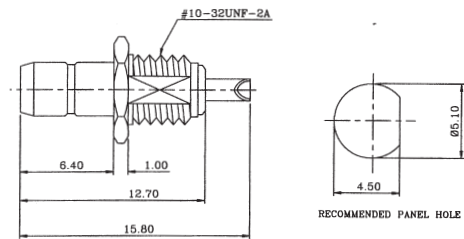

### SB379CU-LGGT50

SMB JACK BULKHEAD CRIMP TYPE

FOR RG174, 188, 316/U CABLE

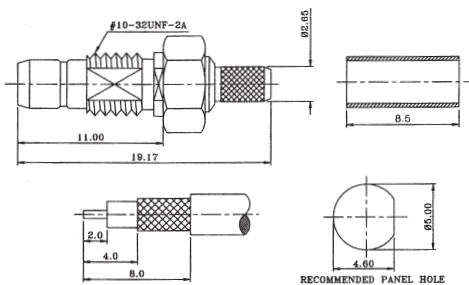

### SB379CU-MGGT50

SMB JACK BULKHEAD CRIMP TYPE

FOR RG178, 196/U CABLE

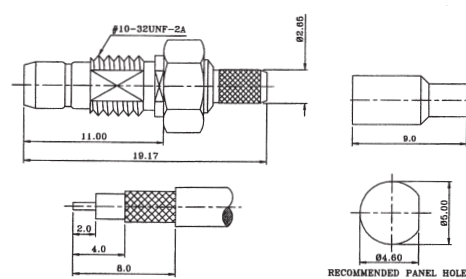

## SMB FEMALE CONNECTORS (7)

**SB370CU-XGGT50**  
SMB PCB MOUNT JACK

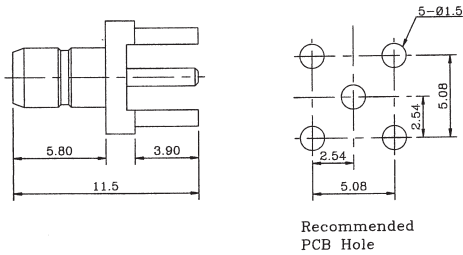

**SB371CU-XGGT50**  
SMB PCB MOUNT JACK

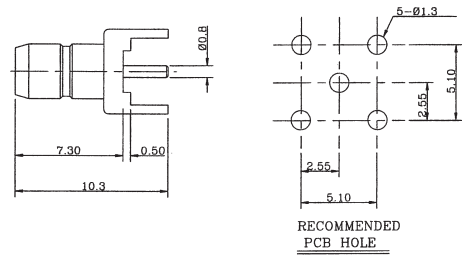

**SB373CU-XGGT50**  
SMB PCB MOUNT JACK  
RIGHT ANGLE TYPE

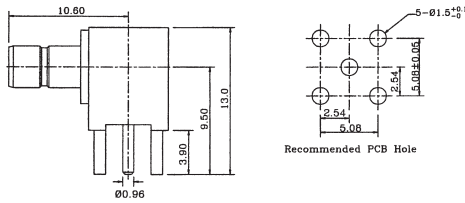

**SB374CU-XGGT50**  
SMB PCB MOUNT JACK  
RIGHT ANGLE TYPE

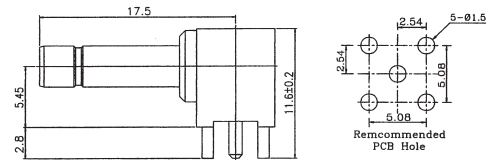

**SB375CU-XGGT50**  
SMB PCB MOUNT JACK  
R/A BULKHEAD TYPE

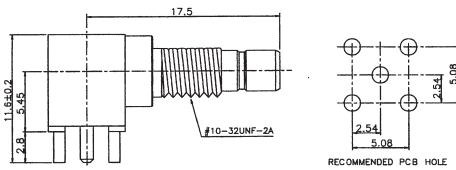

**SB381CU-LGGT50**  
SMB JACK CRIMP TYPE  
R/A FOR RG174,188,316/U CABLE

