

SPECIFICATIONS:

CONTACT RATING: Refer to "Contact Material Options" for more info.
ELECTRICAL LIFE: 50,000 make-and-break cycles at full load.
CONTACT RESISTANCE: 10mΩ max. initial @2-4VDC.
100mA, for both silver and gold plated contacts.
INSULATION RESISTANCE: 1,000MΩ min.
DIELECTRIC STRENGTH: 1500V RMS @ sea level.
OPERATING TEMPERATURE: -30°C to +85°C.

MATERIALS:

CASE & BUSHING: PA9T or FR52, flame retardant, heat stabilized (UL 94V-0).
ACTUATOR: Nylon, black std, internal o-ring sealed (300A).
ACTUATOR: Nylon, black std (300C).
PANEL REAR MOUNT: Nylon, black std.
SWITCH SUPPORT: Brass, tin plated.
ACTUATOR PIVOT & MOUNTING BRACKET: Nylon, black std.
ACTUATOR PIVOT RETAINER: Stainless steel.
TERMINAL SEAL: Epoxy.

Specifications and Dimensions subject to change

If your preferred product configuration is not shown, please contact our sales representative for custom design.

HOW TO ORDER SYSTEM

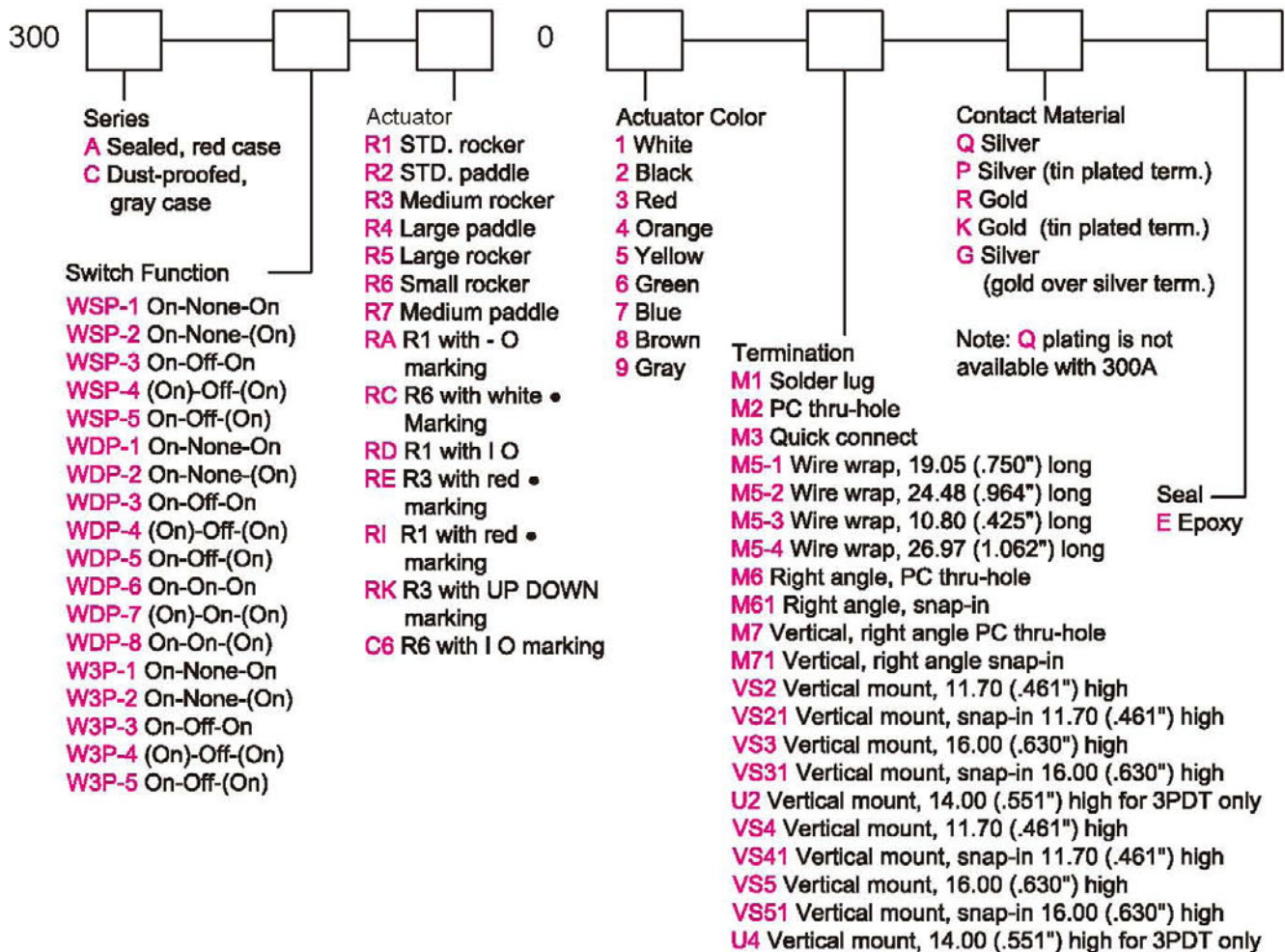

Toggle
Rocker
Slide
Pushbutton
AV
Rotary
Tact
Touch Key
Miscellaneous

Series 300A/C (Sealed) Miniature Rocker & Paddle Switches

SPDT



Model No.	Switching Position		
WSP-1	ON	NONE	ON
WSP-2	ON	NONE	(ON)
WSP-3	ON	OFF	ON
WSP-4	(ON)	OFF	(ON)
WSP-5	ON	OFF	(ON)
Term. Comm.	2-3	OPEN	2-1

Schematic

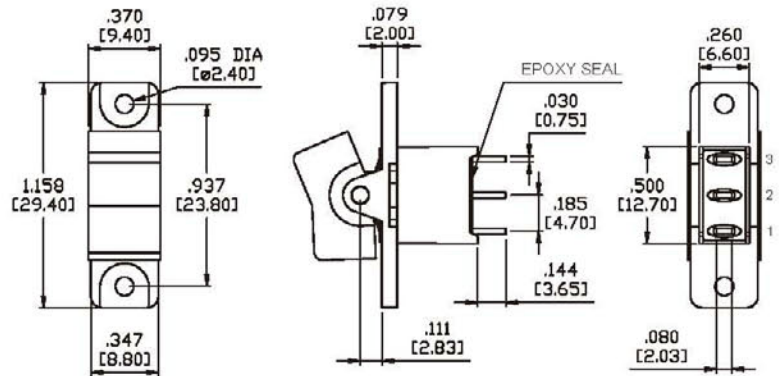

DPDT



Model No.	Switching Position		
WDP-1	ON	NONE	ON
WDP-2	ON	NONE	(ON)
WDP-3	ON	OFF	ON
WDP-4	(ON)	OFF	(ON)
WDP-5	ON	OFF	(ON)
Term. Comm.	2-3,5-6	OPEN	2-1,5-4

Schematic

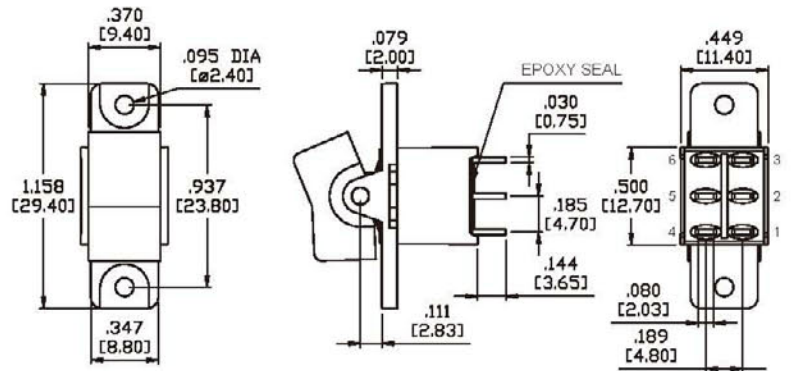
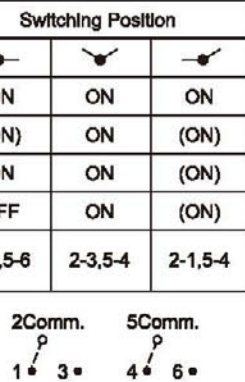

WIRING FOR ON-ON-ON (3-WAY) FUNCTION

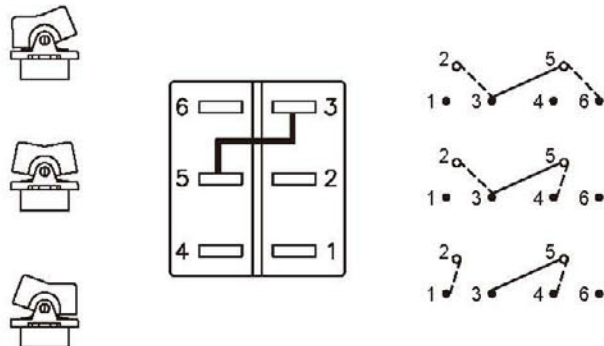

3PDT



Model No.	Switching Position		
W3P-1	ON	NONE	ON
W3P-2	ON	NONE	(ON)
W3P-3	ON	OFF	ON
W3P-4	(ON)	OFF	(ON)
W3P-5	ON	OFF	(ON)
Term. Comm.	2-3,5-6 8-9	OPEN	2-1,5-4 8-7

Schematic

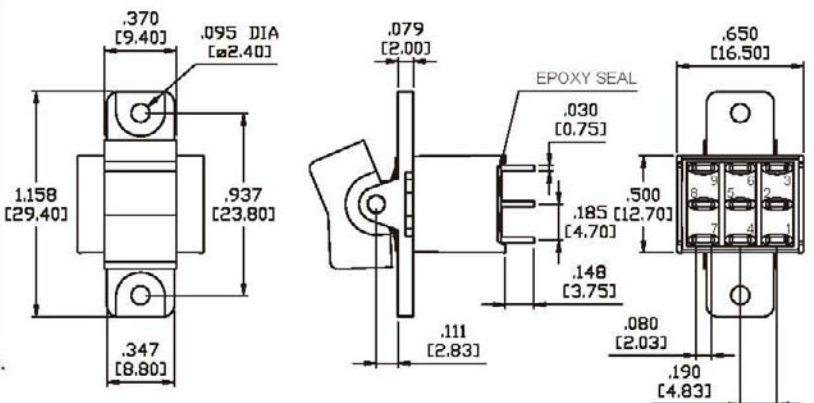
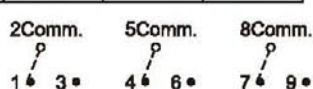

Series 300A/C (Sealed) Miniature Rocker & Paddle Switches

ACTUATOR OPTIONS FOR PANEL REAR MOUNT

R1

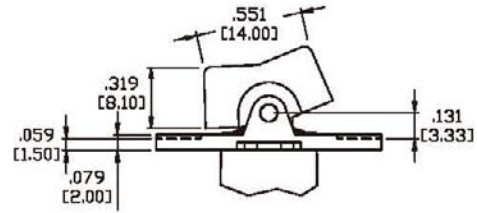
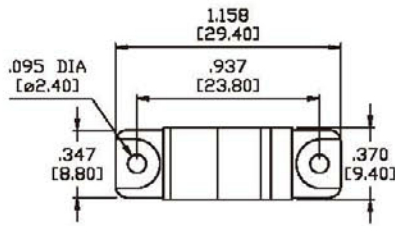

R2

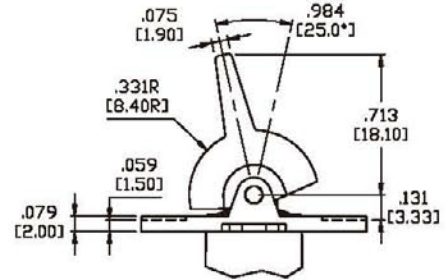
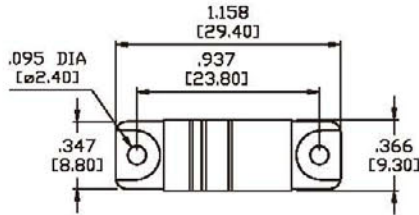

R3

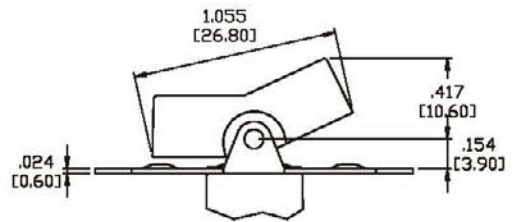
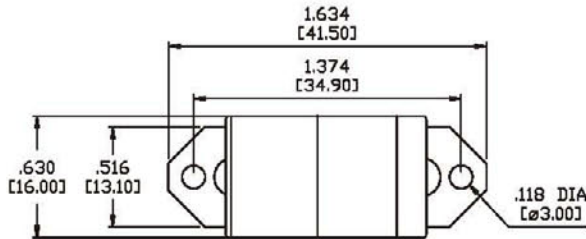

R4

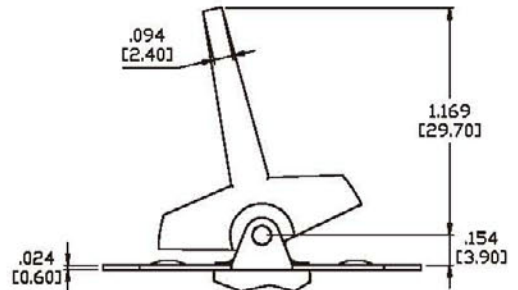
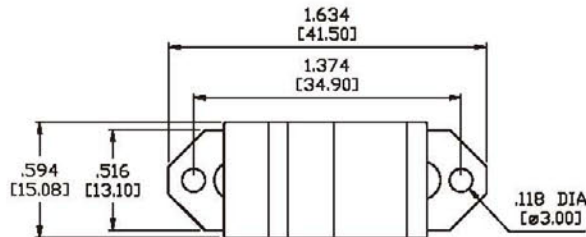

R5

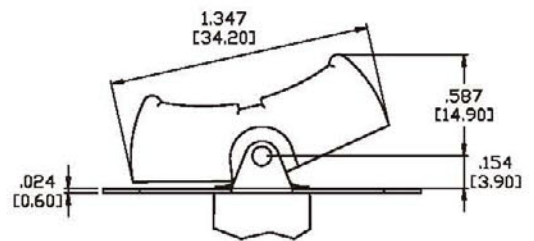
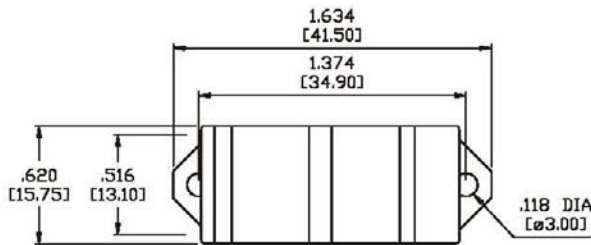

R6

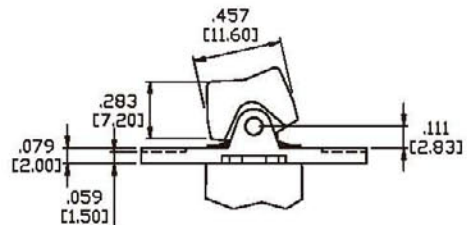
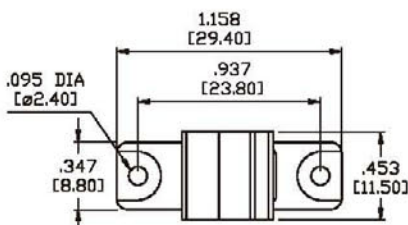

Toggle

Rocker

Slide

Pushbutton

AV

Rotary

Tact

Touch Key

Miscellaneous

Series 300A/C (Sealed) Miniature Rocker & Paddle Switches

ACTUATOR OPTIONS FOR PANEL REAR MOUNT

R7

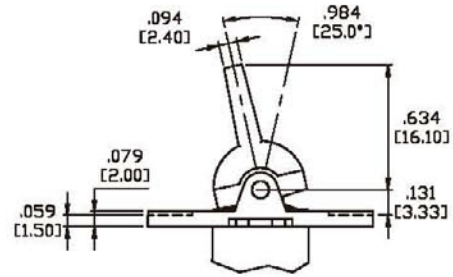
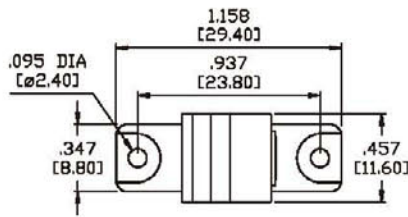

ACTUATOR OPTIONS FOR P.C MOUNT

R1

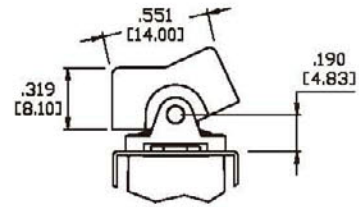
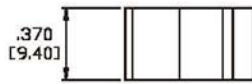

R2

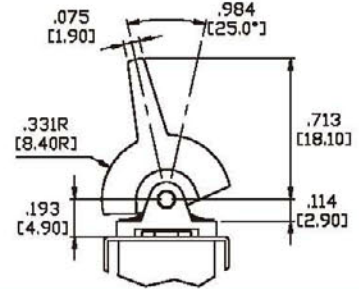

R3

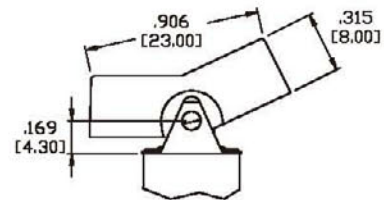
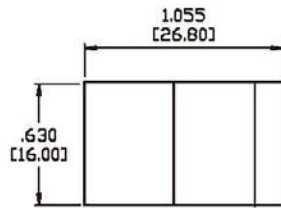

R4

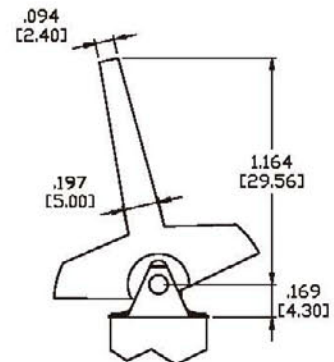
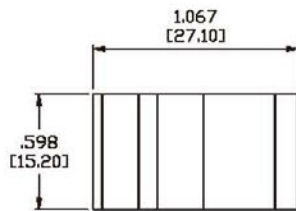

R5

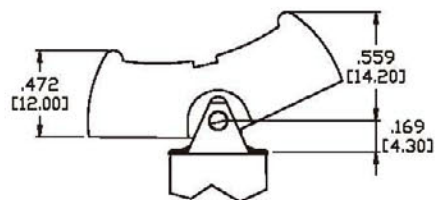
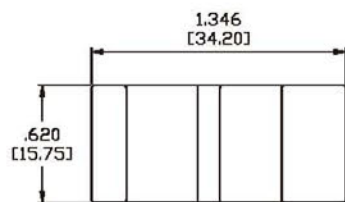

Series 300A/C (Sealed) Miniature Rocker & Paddle Switches

ACTUATOR OPTIONS FOR P.C MOUNT

R6

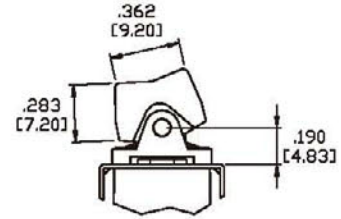
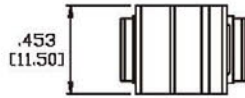

R7

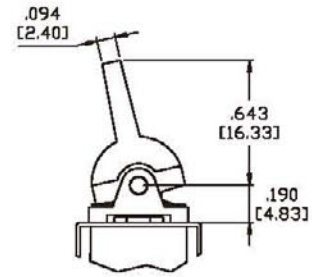
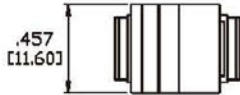

TERMINATION OPTIONS

M1 STD. SOLDER LUG

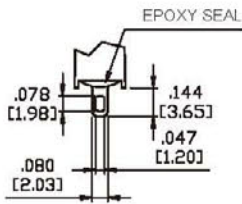

THK .030 [0.75]

M2 PC THRU-HOLE

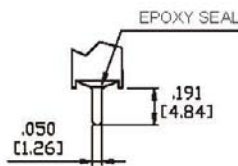

THK .030 [0.75]

M3 QUICK CONNECT

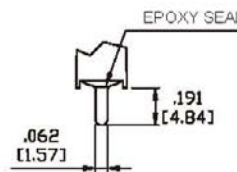

THK .030 [0.75]

M5 WIRE WRAP

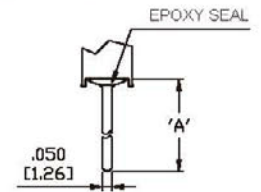

THK .030 [0.75]

OPTION CODE	DIM. 'A'
M5-1	.711 [18.05]
M5-2	.924 [23.48]
M5-3	.386 [9.80]
M5-4	1.022 [25.97]

M6



SPDT

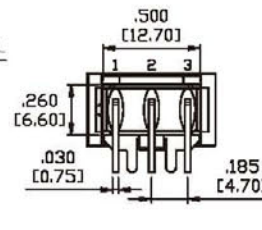
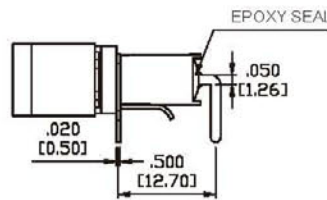
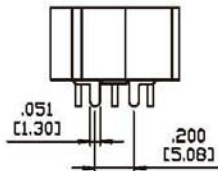

P.C. MOUNTING

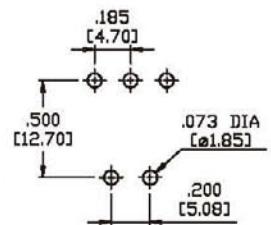

M6



DPDT

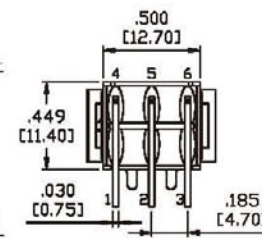
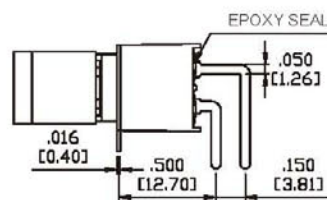
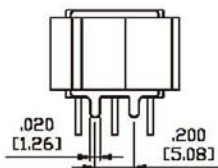

P.C. MOUNTING

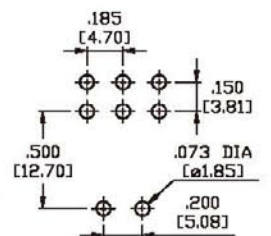

Series 300A/C (Sealed) Miniature Rocker & Paddle Switches

TERMINATION OPTIONS

M6



3PDT

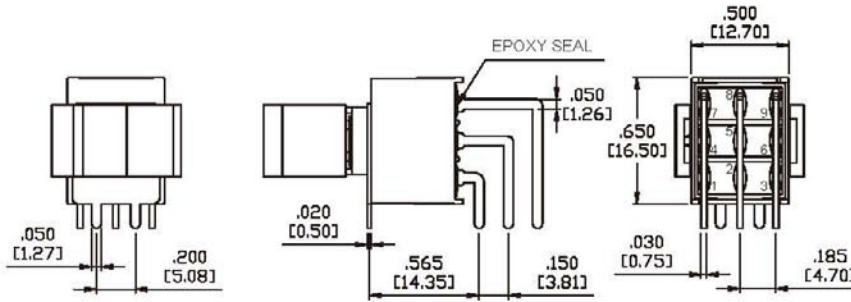

P.C. MOUNTING

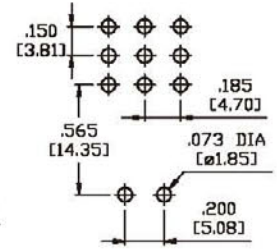

M7



SPDT

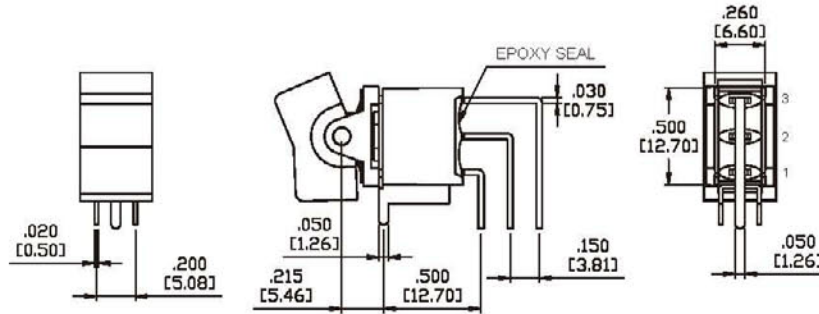

P.C. MOUNTING

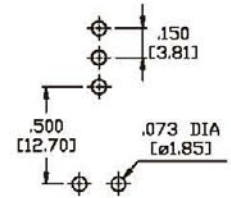

M7



DPDT

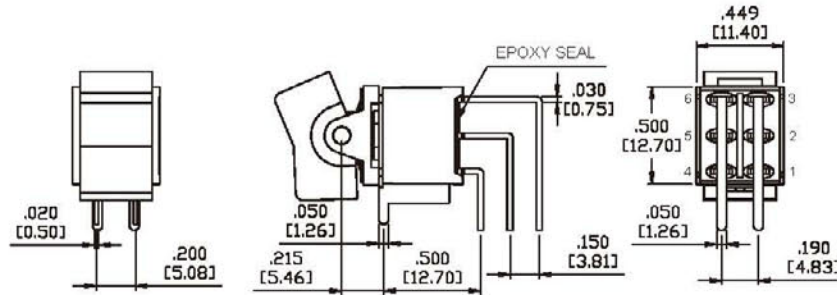

P.C. MOUNTING

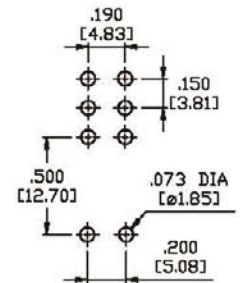

M7



3PDT

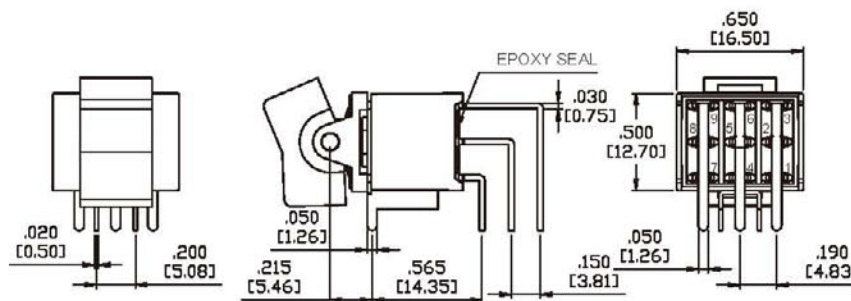

P.C. MOUNTING

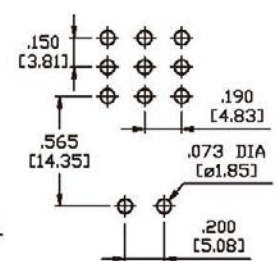

VS2-VS3



SPDT

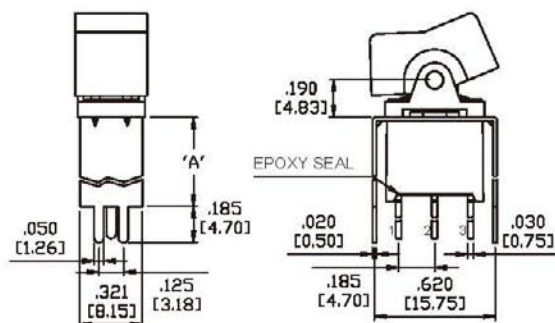

OPTION CODE	DIM. 'A'
VS2	.461 [11.70]
VS3	.630 [16.00]

P.C. MOUNTING

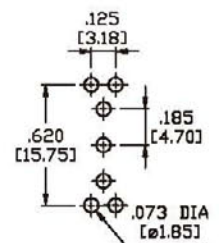

Series 300A/C (Sealed) Miniature Rocker & Paddle Switches

TERMINATION OPTIONS

VS2-VS3



DPDT

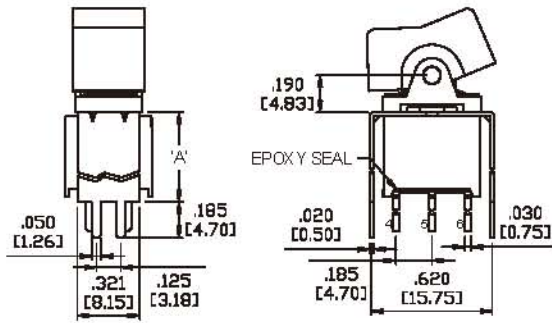

P.C.MOUNTING

OPTION CODE	DIM. 'A'
VS2	.461 [11.70]
VS3	.630 [16.00]

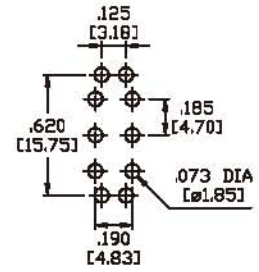

U2-VS3



3PDT

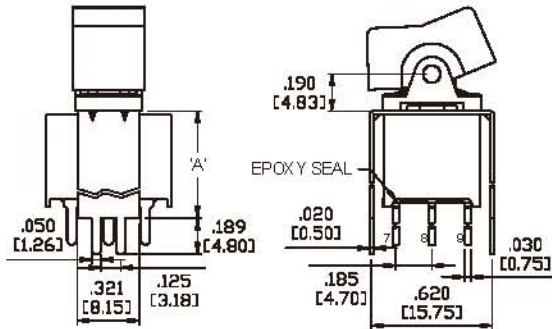

P.C.MOUNTING

OPTION CODE	DIM. 'A'
U2	.551 [14.00]
VS3	.630 [16.00]

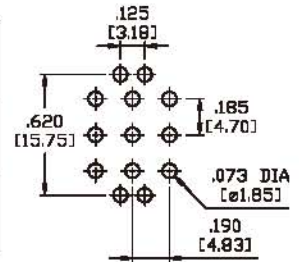

VS4-VS5



SPDT

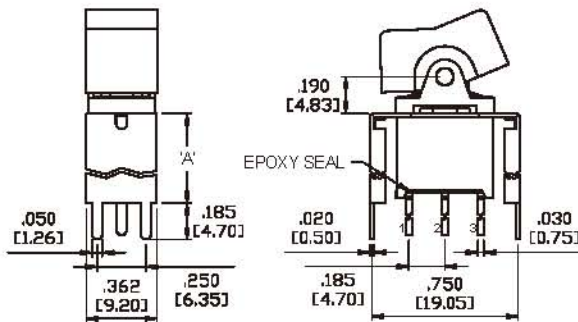

P.C.MOUNTING

OPTION CODE	DIM. 'A'
VS4	.461 [11.70]
VS5	.630 [16.00]

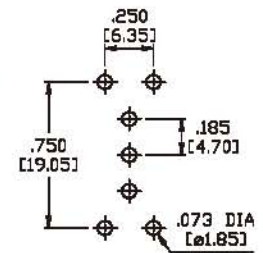

VS4-VS5



DPDT

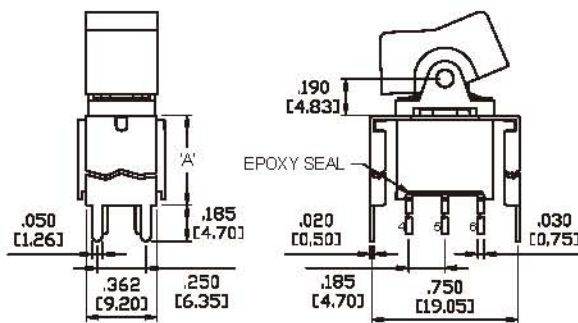

P.C.MOUNTING

OPTION CODE	DIM. 'A'
VS4	.461 [11.70]
VS5	.630 [16.00]

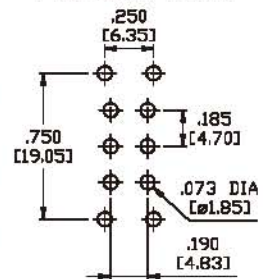

U4-VS5



3PDT

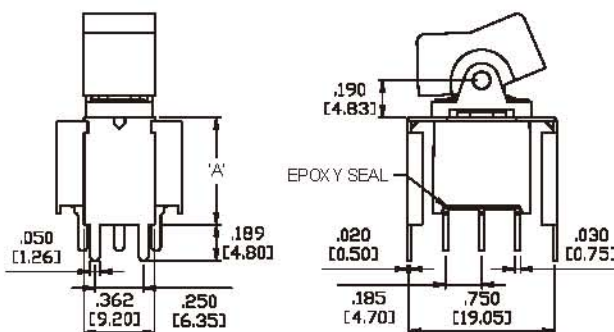

P.C.MOUNTING

OPTION CODE	DIM. 'A'
U4	.551 [14.00]
VS5	.630 [16.00]

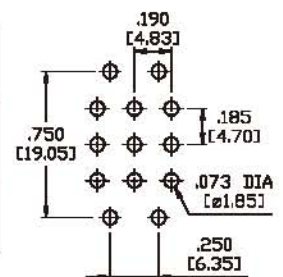

Series 300A/C (Sealed) Miniature Rocker & Paddle Switches

SNAP-IN TERMINATION OPTIONS

M61

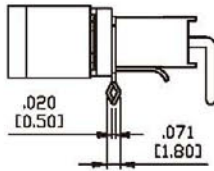
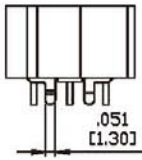

VS21, VS31

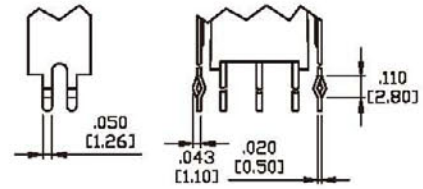

VS41, VS51

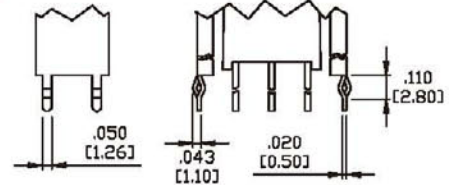
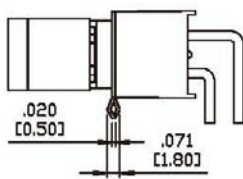
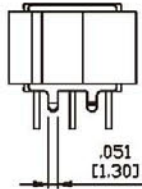

* PC Mounting for M61, M71, VS21, VS31, VS41, VS51 refer to M6, M7, VS2, VS3, VS4, VS5 respectively.

CONTACT MATERIAL OPTIONS

Coding	Contact Material	Terminal Plating	Rating	Agency Approvals
G	Silver ¹	Gold over silver ³	5Amps @ 125VAC or 28VDC 2Amps @ 250VAC	c UL _{us} IP67
P		Tin plated ^{5/7}		
R	Gold ²	Gold plated ⁴	0.4VA max @ 20V max (AC or DC)	IP67
K		Tin plated ^{5/6}		

* Standard G plating for sealed product.

1. Movable Contact: Copper alloy, silver plated.
2. Movable Contact: Copper alloy with gold plated over nickel plated.
3. Terminals: Silver plated with outer layer in gold plating.
4. Terminals: Copper alloy, with gold plated over nickel plated.
5. Outer Terminals: Copper alloy with pure tin plated.
6. Terminal Contact: Gold plated over nickel plated.
7. Terminal Contact: Palladium nickel alloy (or Silver) plated.

* P, K not available with M1 and M3 terminals

* 6Amps (Movable Contact: coin silver, silver plated) available to model ON-NONE-ON without UL approval

* IP67 protection for 300A series only