

## SLIDE SWITCHES STRAIGHT DIP TYPES (1)

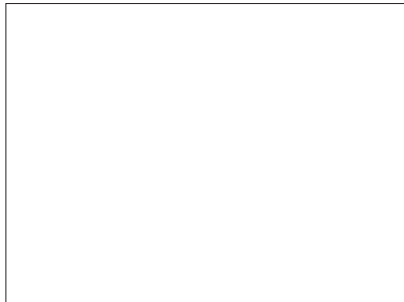

### SPECIFICATIONS

**Circuit:** ON-ON (1P2T)  
**Rating:** A.C. 250V 3A  
**Contact R.[max]:** D.C. 5V 1A 30mΩ  
**Insulation R.[min]:** D.C. 500V 100MΩ  
**Withstand VOL.:** A.C. 1000V 1minute  
**Operating force:** 500 ± 200gf  
**Life cycle[max]:** 10,000 CYCLES  
**All materials must be RoHS compliant.**

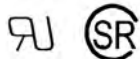

### MATERIALS

**Cover:** 0.25mm SUS, Washing  
**Knob:** Nylon, Black  
**Case:** Brass Strip/Nylon 9T + F.G., Black/Ag Plated  
**Contact:** PBS C5210R-EH, Ag Clad  
**Unit: mm**

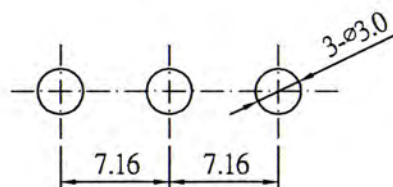
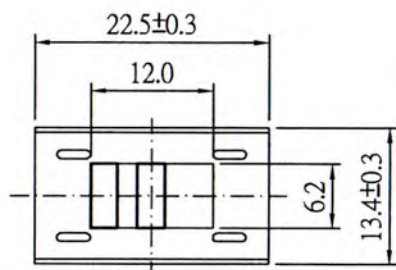

Recommended P.C.Board Layout

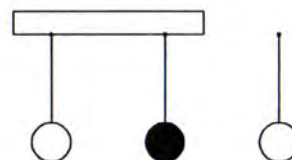
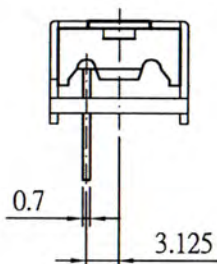
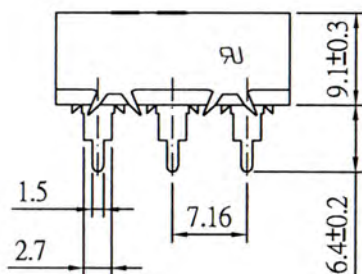

Non-Shorting Schematic

### ORDERING INFORMATION:

**P/N S W S 6 9 - x P x T F 0 0**  
 1 2 3

1. SWITCHING ACTION:  
"1P2T" ON-ON
2. KNOB TYPE:  
"F" TYPE F
3. KNOB LENGTH (L IN MM):  
00

## SLIDE SWITCHES STRAIGHT DIP TYPES (2)

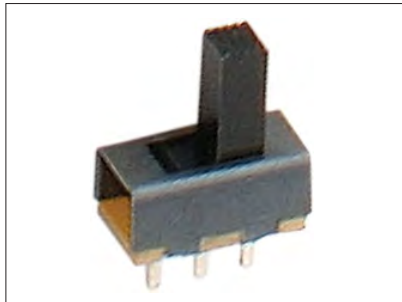

### SPECIFICATIONS

**Circuit:** ON-ON (1P2T)  
**Rating:** D.C. 50V 0.5A  
**Contact R.[max]:** D.C. 5V 1A 30mΩ  
**Insulation R.[min]:** D.C. 500V 100MΩ  
**Withstand VOL.:** A.C. 500V 1minute  
**Operating force:** 250 ± 100g  
**Life cycle[max]:** 10,000 CYCLES  
**All materials must be RoHS compliant.**

### MATERIALS

**Cover:** 0.25mm SUS, Washing  
**Knob:** Nylon, Black  
**Case:** Brass Strip/Nylon 9T + F.G., Black/Ag Plated  
**Contact:** PBS C5210R-EH, Ag Clad  
**Unit:** mm

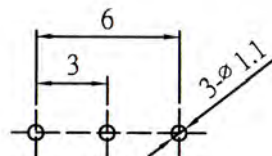
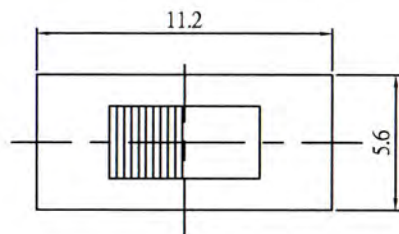

Recommended P.C.Board Layout

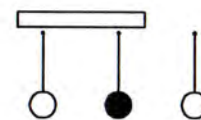
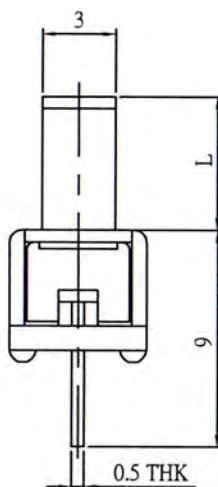
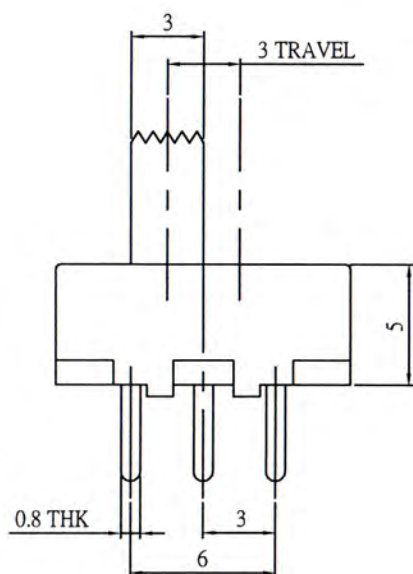

Non-Shorting Schematic

### ORDERING INFORMATION:

**P/N S W S 7 9 -  $\frac{x}{1}$  P  $\frac{x}{2}$  T  $\frac{G}{3}$  x x**

1. SWITCHING ACTION:  
"1P2T" ON-ON
2. KNOB TYPE:  
"G" TYPE G
3. KNOB LENGTH (L IN MM):  
02~15

## SLIDE SWITCHES STRAIGHT DIP TYPES (3)

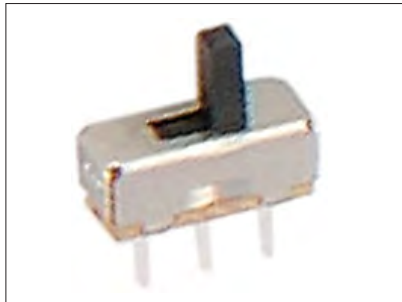

### SPECIFICATIONS

**Circuit:** ON-ON (1P2T)  
**Rating:** D.C. 50V 0.3A  
**Contact R.[max]:** D.C. 5V 1A 30mΩ  
**Insulation R.[min]:** D.C. 500V 100MΩ  
**Withstand VOL.:** A.C. 500V 1minute  
**Timing:** Non-Shorting  
**Operating force:** 300 ± 100g  
**Life cycle[max]:** 10,000 CYCLES  
**All materials must be RoHS compliant.**

### MATERIALS

**Cover:** 0.25mm SUS, Washing  
**Knob:** Nylon, Black  
**Case:** Brass Strip/Nylon 9T + F.G., Black/Ag Plated  
**Contact:** PBS C5210R-EH, Ag Clad  
**Unit: mm**

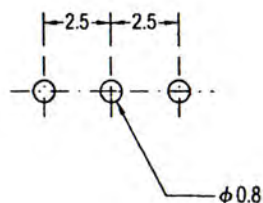
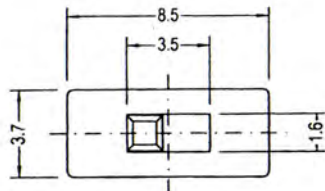

Recommended P.C.Board Layout

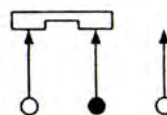
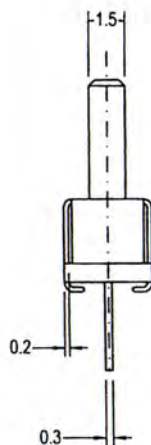
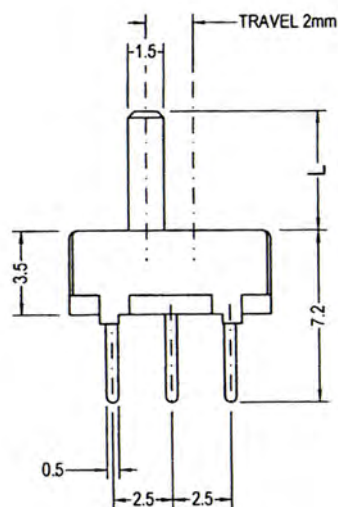

Schematic

### ORDERING INFORMATION:

**P/N S W S 8 1 -  $\frac{x}{1}$  P  $\frac{x}{2}$  T R  $\frac{x}{3}$  X X**

1. SWITCHING ACTION:  
"1P2T" ON-ON
2. KNOB TYPE:  
"R" TYPE R
3. KNOB LENGTH (L IN MM):  
02~15

## SLIDE SWITCHES STRAIGHT DIP TYPES (4)



### SPECIFICATIONS

**Circuit:** ON-ON (1P2T)  
**Rating:** D.C. 50V 0.3A  
**Contact R.[max]:** D.C. 5V 1A 30mΩ  
**Insulation R.[min]:** D.C. 500V 100MΩ  
**Withstand VOL.:** A.C. 500V 1minute  
**Operating force:** 300 ± 100g  
**Life cycle[max]:** 10,000 CYCLES  
**All materials must be RoHS compliant.**

### MATERIALS

**Cover:** 0.25mm SUS, Washing  
**Knob:** Nylon, Black  
**Case:** Brass Strip/Nylon 9T + F.G., Black/Ag Plated  
**Contact:** PBS C5210R-EH, Ag Clad  
**Unit:** mm

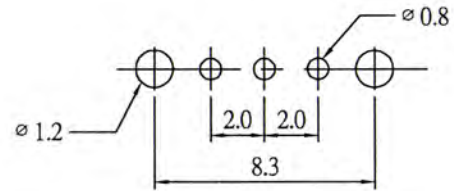
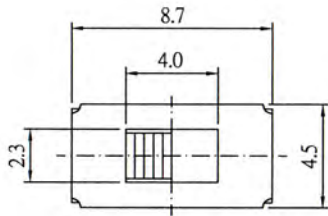

Recommended P.C.Board Layout

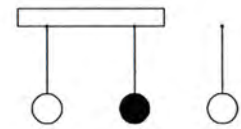
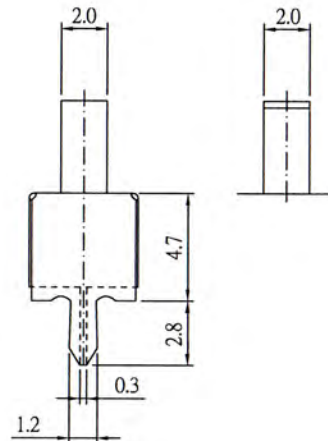
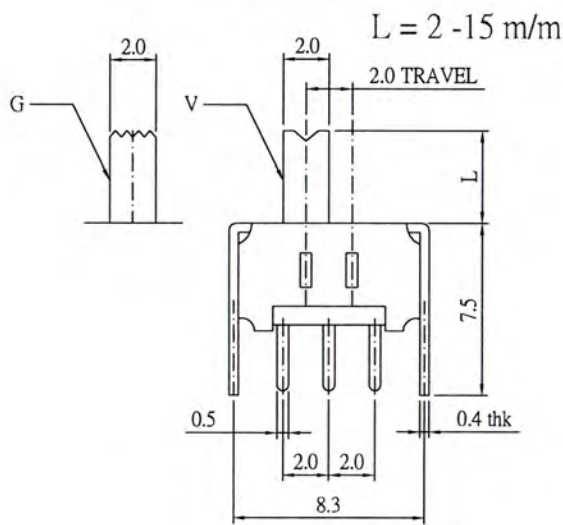

Non-Shorting Schematic

KNOB TYPE	
V	G

### ORDERING INFORMATION:

**P/N S W S 8 2 -  $\frac{x}{1}$  P  $\frac{x}{2}$  T  $\frac{G}{3}$  X X**

1. SWITCHING ACTION:  
"1P2T" ON-ON
2. KNOB TYPE:  
"G" TYPE G  
"V" TYPE V
3. KNOB LENGTH (L IN MM):  
02~15

## SLIDE SWITCHES STRAIGHT DIP TYPES (5)



### SPECIFICATIONS

**Circuit:** ON-ON (1P2T)  
**Rating:** D.C. 50V 0.3A  
**Contact R.[max]:** D.C. 5V 1A 30mΩ  
**Insulation R.[min]:** D.C. 500V 100MΩ  
**Withstand VOL.:** A.C. 500V 1minute  
**Operating force:** 300 ± 100g  
**Life cycle[max]:** 10,000 CYCLES  
**All materials must be RoHS compliant.**

### MATERIALS

**Cover:** 0.25mm SUS, Washing  
**Knob:** Nylon, Black  
**Case:** Brass Strip/Nylon 9T + F.G., Black/Ag Plated  
**Contact:** PBS C5210R-EH, Ag Clad  
**Unit:** mm

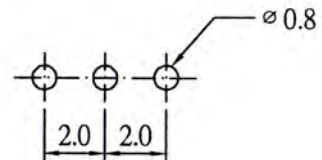
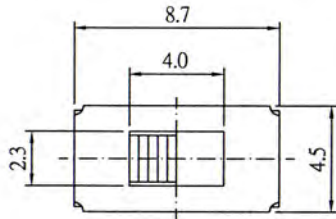

Recommended P.C.Board Layout

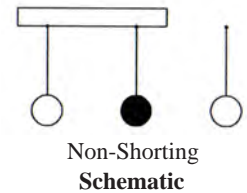
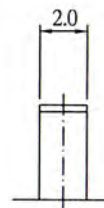
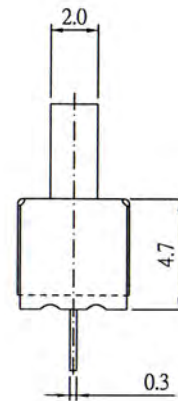
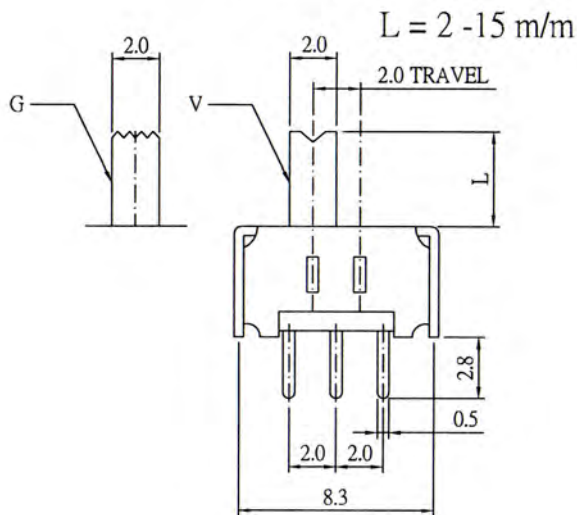

KNOB TYPE	
V	G

## ORDERING INFORMATION:

**P/N S W S 8 3 -  $\frac{x}{1}$  P  $\frac{x}{2}$  T  $\frac{x}{3}$  x x x**

1. SWITCHING ACTION:  
"1P2T" ON-ON
2. KNOB TYPE:  
"G" TYPE G  
"V" TYPE V
3. KNOB LENGTH (L IN MM):  
02~15

## SLIDE SWITCHES STRAIGHT DIP TYPES (6)



### SPECIFICATIONS

**Circuit:** ON-ON (1P2T)  
**Rating:** A.C. 125V 2A  
**Contact R.[max]:** D.C. 5V 1A 30mΩ  
**Insulation R.[min]:** D.C. 500V 100MΩ  
**Withstand VOL.:** A.C. 500V 1minute  
**Operating force:** 300 ± 100g  
**Life cycle[max]:** 10,000 CYCLES  
**All materials must be RoHS compliant.**

### MATERIALS

**Cover:** 0.25mm SUS, Washing  
**Knob:** Nylon, Black  
**Case:** Brass Strip/Nylon 9T + F.G., Black/Ag Plated  
**Contact:** PBS C5210R-EH, Ag Clad  
**Unit: mm**

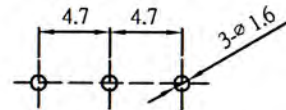
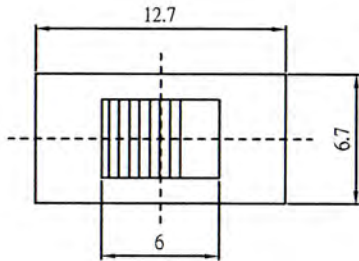

Recommended P.C.Board Layout

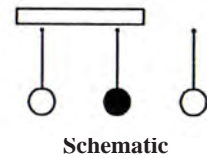
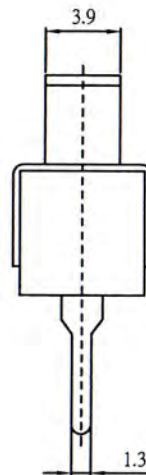
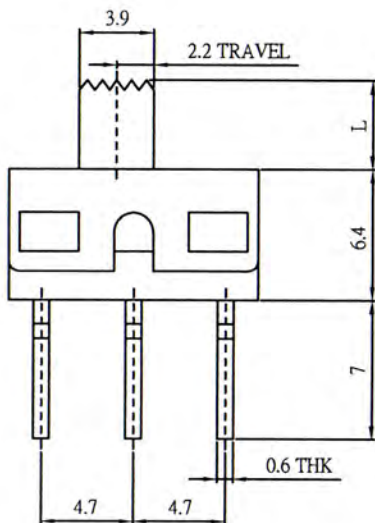

### ORDERING INFORMATION:

**P/N S W S 8 4 -  $\frac{x}{1}$  P  $\frac{x}{2}$  T G  $\frac{x}{3}$  X X**

1. SWITCHING ACTION:  
"1P2T" ON-ON
2. KNOB TYPE:  
"G" TYPE G
3. KNOB LENGTH (L IN MM):  
02~15

## SLIDE SWITCHES STRAIGHT DIP TYPES (7)



### SPECIFICATIONS

**Circuit:** ON-ON (1P2T)  
**Rating:** A.C. 125V 2A  
**Contact R.[max]:** D.C. 5V 1A 30mΩ  
**Insulation R.[min]:** D.C. 500V 100MΩ  
**Withstand VOL.:** A.C. 500V 1minute  
**Operating force:** 300 ± 100g  
**Life cycle[max]:** 10,000 CYCLES  
**All materials must be RoHS compliant.**

### MATERIALS

**Cover:** 0.25mm SUS, Washing  
**Knob:** Nylon, Black  
**Case:** Brass Strip/Nylon 9T + F.G., Black/Ag Plated  
**Contact:** PBS C5210R-EH, Ag Clad  
**Unit: mm**

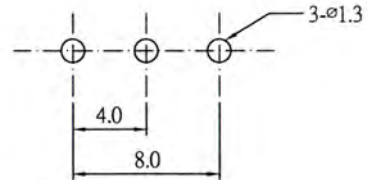
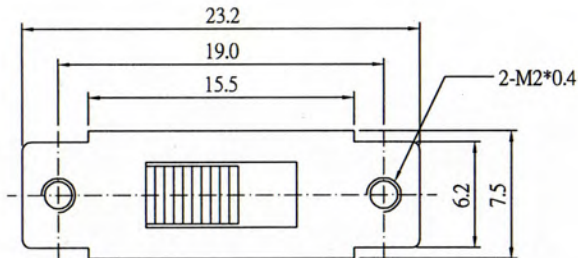

Recommended P.C.Board Layout

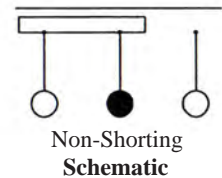
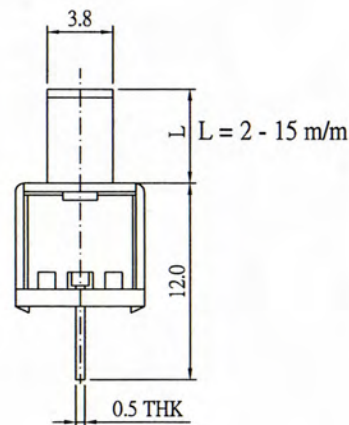
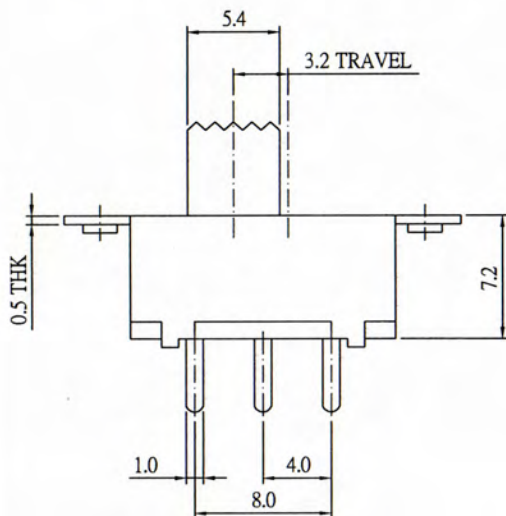

### ORDERING INFORMATION:

**P/N SWS85 -  $\frac{x}{1}P \frac{x}{2}T \frac{G}{3} \frac{xx}{3}$**

1. SWITCHING ACTION:  
"1P2T" ON-ON
2. KNOB TYPE:  
"G" TYPE G
3. KNOB LENGTH (L IN MM):  
02~15

## SLIDE SWITCHES STRAIGHT DIP TYPES (8)

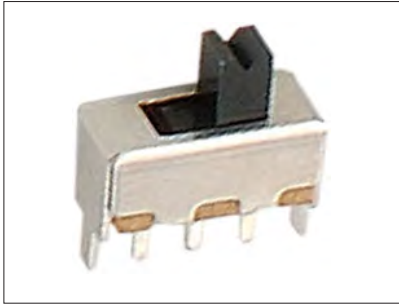

### SPECIFICATIONS

**Circuit:** ON-ON (1P2T)  
**Rating:** D.C. 50V 0.5A  
**Contact R.[max]:** D.C. 5V 1A 30mΩ  
**Insulation R.[min]:** D.C. 500V 100MΩ  
**Withstand VOL.:** A.C. 500V 1minute  
**Operating force:** 300 ± 100gf  
**Life cycle[max]:** 10,000 CYCLES  
**All materials must be RoHS compliant.**

### MATERIALS

**Cover:** 0.25mm SUS, Washing  
**Knob:** Nylon, Black  
**Case:** Brass Strip/Nylon 9T + F.G., Black/Ag Plated  
**Contact:** PBS C5210R-EH, Ag Clad  
**Unit:** mm

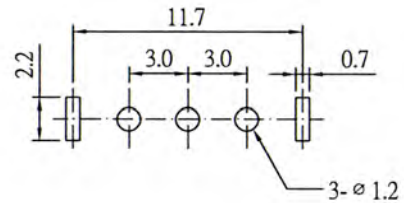
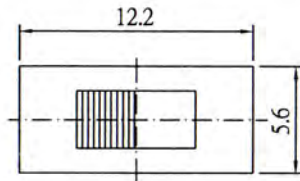

Recommended P.C.Board Layout

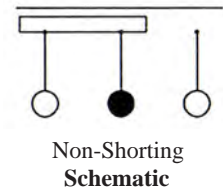
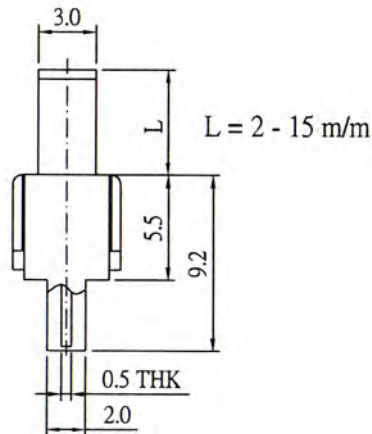
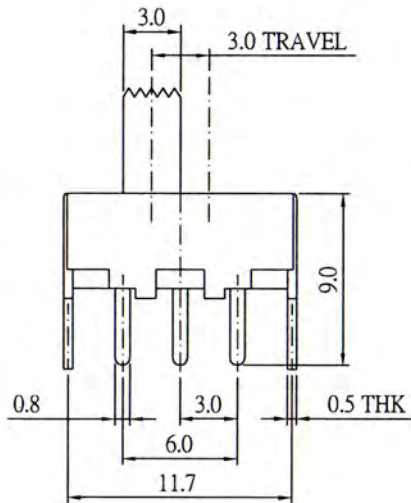

### ORDERING INFORMATION:

**P/N S W S 8 6 -  $\frac{x}{1} P \frac{x}{2} T \frac{G}{3} \frac{x}{3} x$**

1. SWITCHING ACTION:  
"1P2T" ON-ON
2. KNOB TYPE:  
"G" TYPE G
3. KNOB LENGTH (L IN MM):  
02~15



## SLIDE SWITCHES STRAIGHT DIP TYPES (9)



### SPECIFICATIONS

**Circuit:** ON-ON (1P2T)  
**Rating:** D.C. 50V 0.5A  
**Contact R.[max]:** D.C. 5V 1A 30mΩ  
**Insulation R.[min]:** D.C. 500V 100MΩ  
**Withstand VOL.:** A.C. 500V 1minute  
**Operating force:** 300 ± 100g  
**Life cycle[max]:** 10,000 CYCLES  
**All materials must be RoHS compliant.**

### MATERIALS

**Knob:** POM, Black  
**Frame:** Steel Strip, Ni Plated or Zn Plated  
**Terminal Base:** Phenolic Resin  
**Terminal:** Brass Strip, Ag Plated Over Ni Plated  
**Contact:** Brass Strip, Ag Plated  
**Spring:** Steel Wire, Tempered  
**Unit:** mm

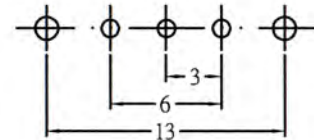
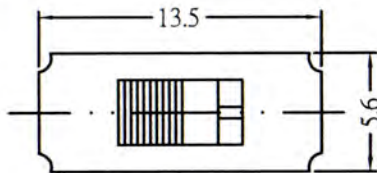

Recommended P.C.Board Layout

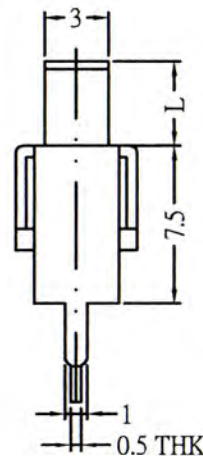
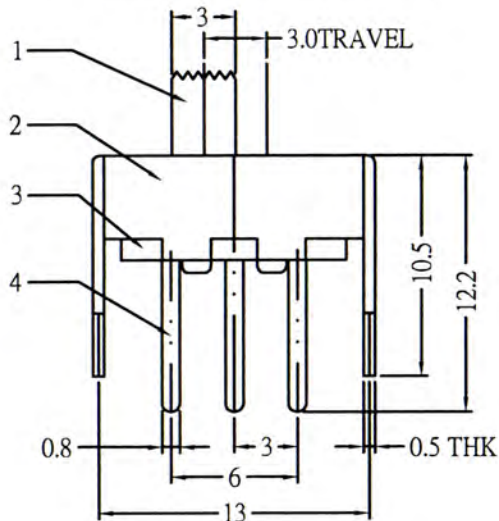

L = 2 - 15

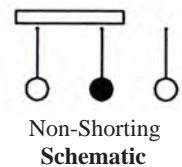

### ORDERING INFORMATION:

**P/N S W S 8 8 -  $\frac{x P x T G x x}{1 \quad 2 \quad 3}$**

1. SWITCHING ACTION:  
"1P2T" ON-ON
2. KNOB TYPE:  
"G" TYPE G
3. KNOB LENGTH (L IN MM):  
02~15

## SLIDE SWITCHES STRAIGHT DIP TYPES (10)



### SPECIFICATIONS

**Circuit:** ON-ON (1P2T)  
**Rating:** D.C. 50V 0.5A  
**Contact R.[max]:** D.C. 5V 1A 30mΩ  
**Insulation R.[min]:** D.C. 500V 100MΩ  
**Withstand VOL.:** A.C. 500V 1minute  
**Operating force:** 300 ± 100g  
**Life cycle[max]:** 10,000 CYCLES  
**All materials must be RoHS compliant.**

### MATERIALS

**Knob:** POM, Black  
**Frame:** Steel Strip, Ni Plated or Zn Plated  
**Terminal Base:** Phenolic Resin  
**Terminal:** Brass Strip, Ag Plated Over Ni Plated  
**Contact:** Brass Strip, Ag Plated  
**Spring:** Steel Wire, Tempered  
**Unit: mm**

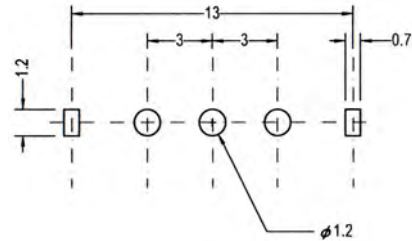
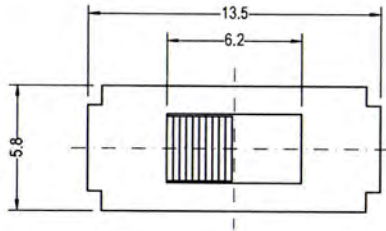

Recommended P.C.Board Layout

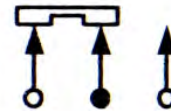
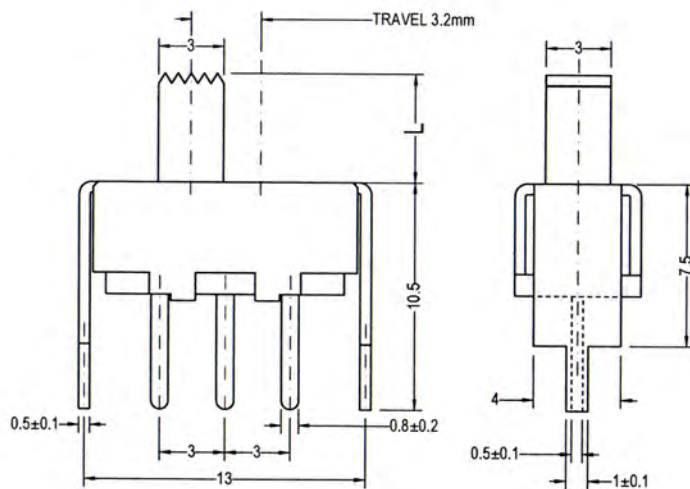

Schematic

KNOB TYPE	
V	G

### ORDERING INFORMATION:

**P/N S W S 3 M -  $\frac{x P x T x x x}{1 \quad 2 \quad 3}$**

1. SWITCHING ACTION:  
"1P2T" ON-ON
2. KNOB TYPE:  
"G" TYPE G  
"V" TYPE V
3. KNOB LENGTH (L IN MM):  
02~15

## SLIDE SWITCHES STRAIGHT DIP TYPES (11)

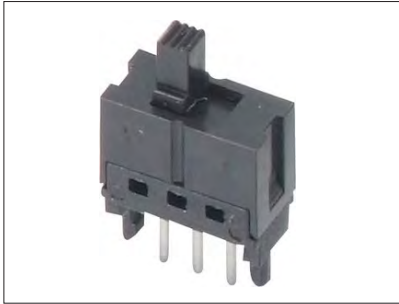

### SPECIFICATIONS

**Circuit:** ON-ON (1P2T)  
**Rating:** D.C. 50V 0.3A  
**Contact R.[max]:** D.C. 5V 1A 30mΩ  
**Insulation R.[min]:** D.C. 500V 100MΩ  
**Withstand VOL.:** A.C. 500V 1minute  
**Timing:** Non-Shorting  
**Operating force:** 300 ± 100g  
**Life cycle[max]:** 10,000 CYCLES  
**All materials must be RoHS compliant.**

### MATERIALS

**Cover:** 0.25mm SUS, Washing  
**Knob:** Nylon, Black  
**Case:** Brass Strip/Nylon 9T + F.G., Black/Ag Plated  
**Contact:** PBS C5210R-EH, Ag Clad  
**Unit: mm**

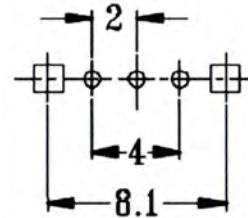
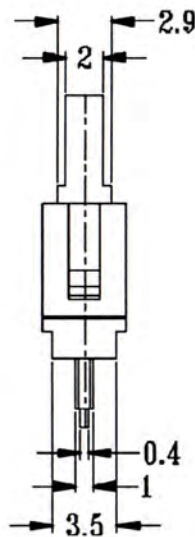
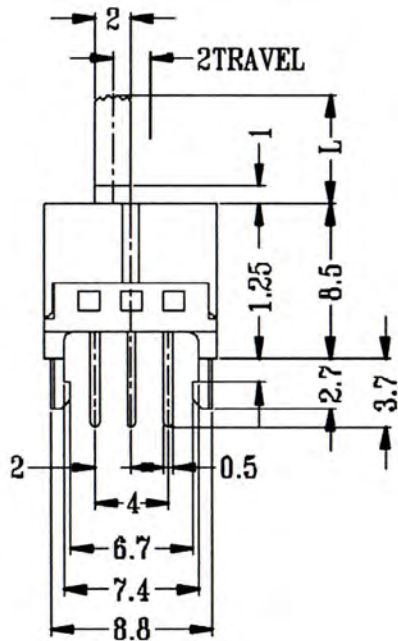
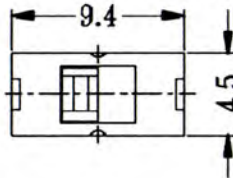

Recommended P.C.Board Layout

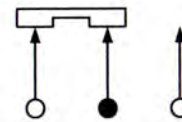

Schematic

### ORDERING INFORMATION:

P/N SWS3L -  $\frac{xPxTG}{123}xx$

1. SWITCHING ACTION:  
"1P2T" ON-ON
2. KNOB TYPE:  
"G" TYPE G
3. KNOB LENGTH (L IN MM):  
02~15

## SLIDE SWITCHES STRAIGHT DIP TYPES (12)

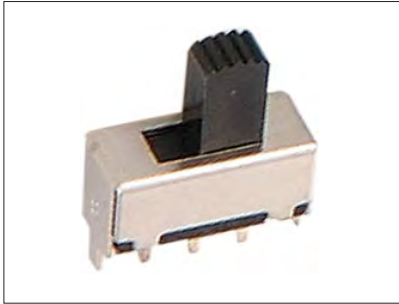

### SPECIFICATIONS

**Circuit:** ON-ON (1P2T)  
**Rating:** D.C. 50V 0.5A  
**Contact R.[max]:** D.C. 5V 1A 30mΩ  
**Insulation R.[min]:** D.C. 500V 100MΩ  
**Withstand VOL.:** A.C. 500V 1minute  
**Timing:** Non-Shorting  
**Operating force:** 300 ± 100g  
**Life cycle[max]:** 10,000 CYCLES  
**All materials must be RoHS compliant.**

### MATERIALS

**Cover:** 0.25mm SUS, Washing  
**Knob:** Nylon, Black  
**Case:** Brass Strip/Nylon 9T + F.G., Black/Ag Plated  
**Contact:** PBS C5210R-EH, Ag Clad  
**Unit: mm**

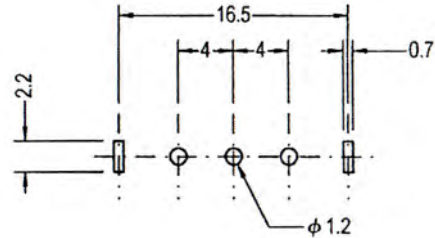
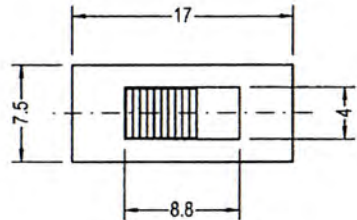

Recommended P.C.Board Layout

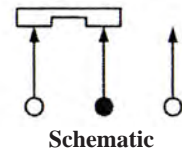
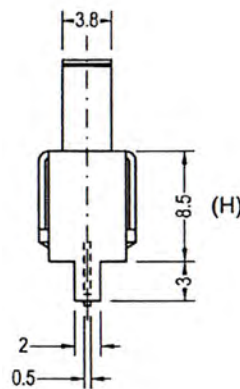
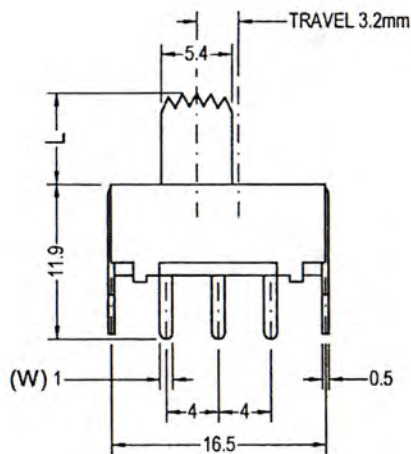

P/N	(H)	(W)
SWS71	8.5	1
SWS72	8	1
SWS73	11	0.9
SWS74	14	0.9
SWS75	14	1.3
SWS76	18	1.3
SWS77	12	1.3
SWS78	21	1.3

### ORDERING INFORMATION:

**P/N S W S  $\frac{xx}{1}$  -  $\frac{1P2T}{2}$   $\frac{G}{3}$   $\frac{xx}{4}$**

- SWITCH TYPE:  
71, 72, 73, 74, 75, 76, 77, 78
- SWITCHING ACTION:  
"1P2T" ON-ON
- KNOB TYPE:  
"G" TYPE G
- KNOB LENGTH (L IN MM):  
02~15

## SLIDE SWITCHES STRAIGHT DIP TYPES (13)

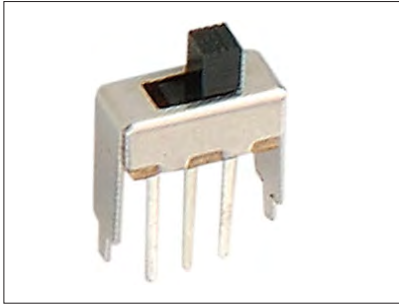

### SPECIFICATIONS

**Circuit:** ON-ON (1P2T)  
**Rating:** D.C. 50V 0.5A  
**Contact R.[max]:** D.C. 5V 1A 30mΩ  
**Insulation R.[min]:** D.C. 500V 100MΩ  
**Withstand VOL.:** A.C. 500V 1minute  
**Timing:** Non-Shorting  
**Operating force:** 300 ± 100g  
**Life cycle[max]:** 10,000 CYCLES  
**All materials must be RoHS compliant.**

### MATERIALS

**Cover:** 0.25mm SUS, Washing  
**Knob:** Nylon, Black  
**Case:** Brass Strip/Nylon 9T + F.G., Black/Ag Plated  
**Contact:** PBS C5210R-EH, Ag Clad  
**Unit: mm**

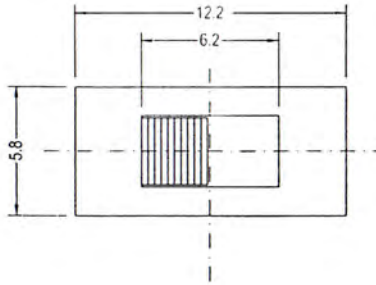

KNOB TYPE	
V	G

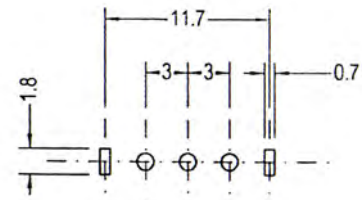

Recommended P.C.Board Layout

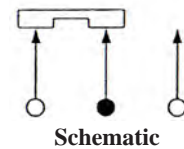
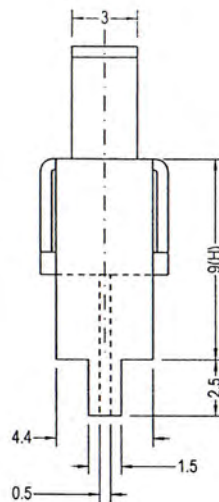
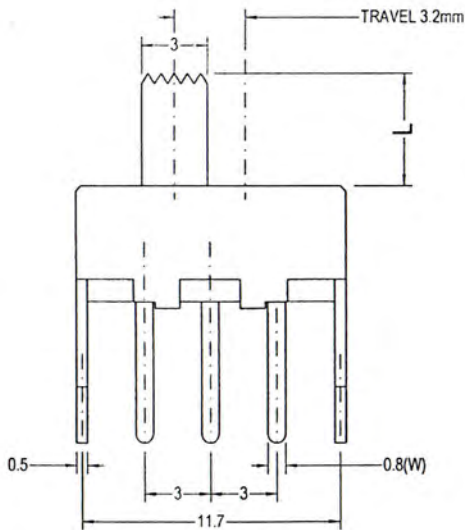

Schematic

P/N	(H)	(W)
SWS2M	14	1.3
SWS2N	11	0.8
SWS2P	14	0.8
SWS2Q	6	1.2
SWS2R	6	0.8
SWS2S	9	0.8
SWS2T	5.5	0.8
SWS2U	8	0.8

## ORDERING INFORMATION:

**P/N S W S  $\frac{xx}{1}$  -  $\frac{1P2T}{2}$   $\frac{xxx}{3}$   $\frac{xxx}{4}$**

- SWITCH TYPE:  
2M, 2N, 2P, 2Q, 2R, 2S, 2T, 2U
- SWITCHING ACTION:  
"1P2T" ON-ON
- KNOB TYPE:  
"G" TYPE G  
"V" TYPE V
- KNOB LENGTH (L IN MM):  
02~15

## SLIDE SWITCHES STRAIGHT DIP TYPES (14)

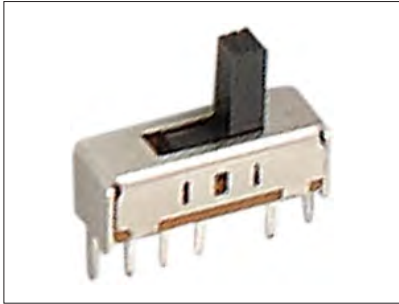

### SPECIFICATIONS

**Circuit:** ON-ON-ON (1P3T)  
**Rating:** D.C. 50V 0.3A  
**Contact R.[max]:** D.C. 5V 1A 30mΩ  
**Insulation R.[min]:** D.C. 500V 100mΩ  
**Withstand VOL.:** A.C. 500V 1minute  
**Operating force:** 250 ± 100g  
**Life cycle[max]:** 10,000 CYCLES  
**All materials must be RoHS compliant.**

### MATERIALS

**Cover:** 0.25mm SUS, Washing  
**Knob:** Nylon, Black  
**Case:** Brass Strip/Nylon 9T + F.G., Black/Ag Plated  
**Contact:** PBS C5210R-EH, Ag Clad  
**Unit: mm**

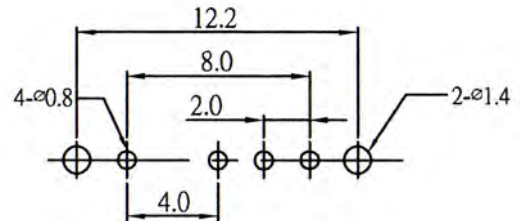
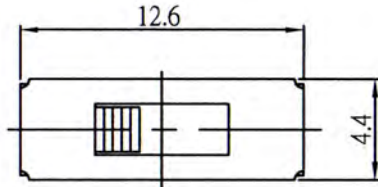

Recommended P.C.Board Layout

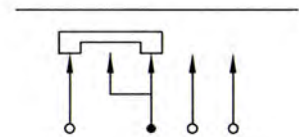
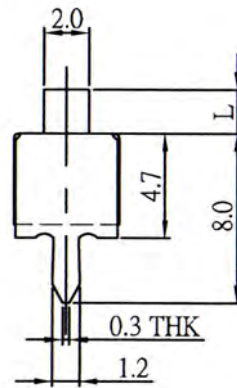
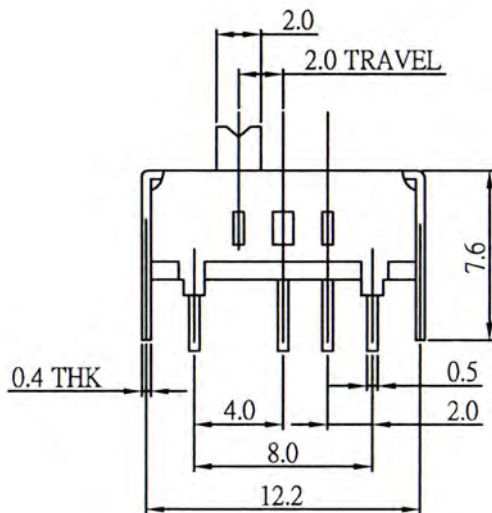

Schematic

KNOB TYPE	
V	G

## ORDERING INFORMATION:

**P/N S W S 8 9 -  $\frac{x}{1} P \frac{x}{2} T \frac{x}{3} x x$**

1. SWITCHING ACTION:  
"1P3T" ON-ON-ON
2. KNOB TYPE:  
"G" TYPE G  
"V" TYPE V
3. KNOB LENGTH (L IN MM):  
02~15

## SLIDE SWITCHES STRAIGHT DIP TYPES (15)



### SPECIFICATIONS

**Circuit:** ON-ON-ON (1P3T)  
**Rating:** D.C. 50V 0.3A  
**Contact R.[max]:** D.C. 5V 1A 30mΩ  
**Insulation R.[min]:** D.C. 500V 100MΩ  
**Withstand VOL.:** A.C. 500V 1minute  
**Operating force:** 300 ± 100gf  
**Life cycle[max]:** 10,000 CYCLES  
**All materials must be RoHS compliant.**

### MATERIALS

**Cover:** 0.25mm SUS, Washing  
**Knob:** Nylon, Black  
**Case:** Brass Strip/Nylon 9T + F.G., Black/Ag Plated  
**Contact:** PBS C5210R-EH, Ag Clad  
**Unit: mm**

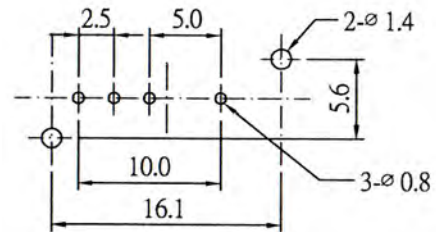
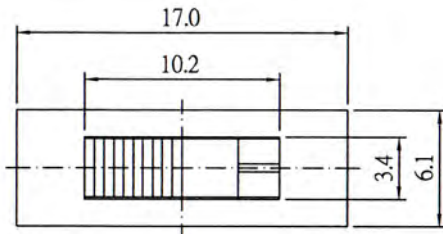

Recommended P.C.Board Layout

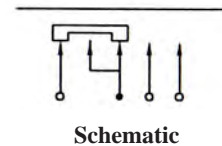
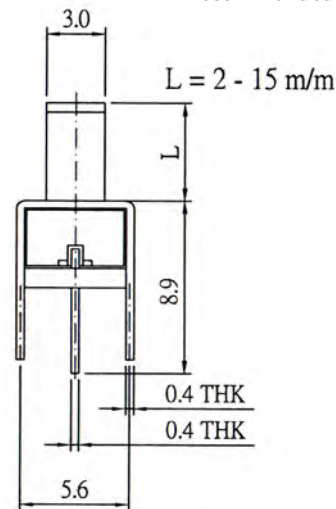
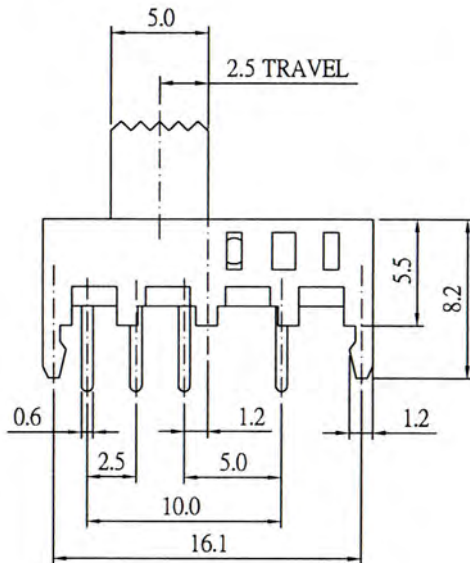

### ORDERING INFORMATION:

**P/N S W S 9 0 -  $\frac{x P x T G x x}{1 \quad 2 \quad 3}$**

1. SWITCHING ACTION:  
"1P3T" ON-ON-ON
2. KNOB TYPE:  
"G" TYPE G
3. KNOB LENGTH (L IN MM):  
02~15

## SLIDE SWITCHES STRAIGHT DIP TYPES (16)



### SPECIFICATIONS

**Circuit:** ON-ON-ON (1P3T)  
**Rating:** D.C. 50V 0.3A  
**Contact R.[max]:** D.C. 5V 1A 30mΩ  
**Insulation R.[min]:** D.C. 500V 100MΩ  
**Withstand VOL.:** A.C. 500V 1minute  
**Timing:** Non-Shorting  
**Operating force:** 300 ± 100g  
**Life cycle[max]:** 10,000 CYCLES  
**All materials must be RoHS compliant.**

### MATERIALS

**Cover:** 0.25mm SUS, Washing  
**Knob:** Nylon, Black  
**Case:** Brass Strip/Nylon 9T + F.G., Black/Ag Plated  
**Contact:** PBS C5210R-EH, Ag Clad  
**Unit:** mm

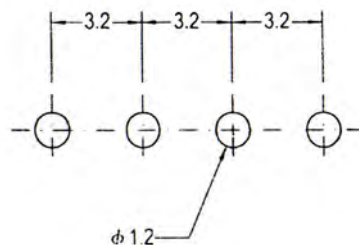
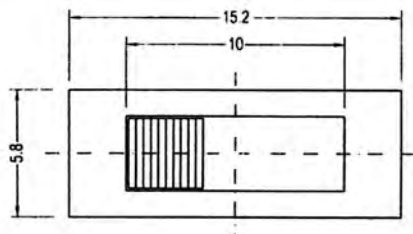

Recommended P.C.Board Layout

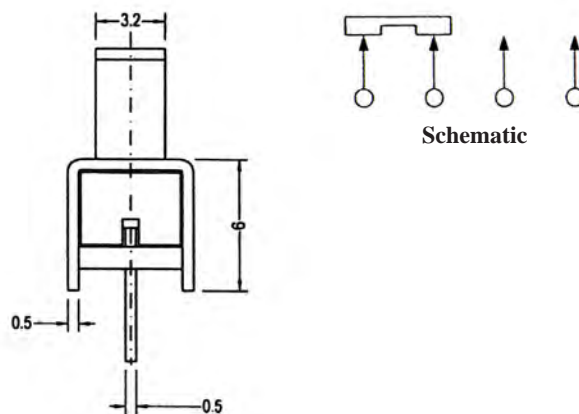
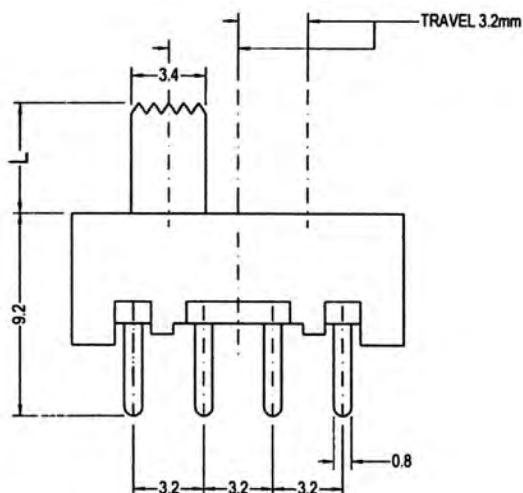

### ORDERING INFORMATION:

**P/N S W S 9 1 -  $\frac{x P x T G x x}{1 \quad 2 \quad 3}$**

1. SWITCHING ACTION:  
"1P3T" ON-ON-ON
2. KNOB TYPE:  
"G" TYPE G
3. KNOB LENGTH (L IN MM):  
02~15



## SLIDE SWITCHES STRAIGHT DIP TYPES (17)



### SPECIFICATIONS

**Circuit:** ON-ON-ON-ON (1P4T)  
**Rating:** D.C. 50V 0.3A  
**Contact R.[max]:** D.C. 5V 1A 30mΩ  
**Insulation R.[min]:** D.C. 500V 100MΩ  
**Withstand VOL.:** A.C. 500V 1minute  
**Operating force:** 300 ± 100gf  
**Life cycle[max]:** 10,000 CYCLES  
**All materials must be RoHS compliant.**

### MATERIALS

**Cover:** 0.25mm SUS, Washing  
**Knob:** Nylon, Black  
**Case:** Brass Strip/Nylon 9T + F.G., Black/Ag Plated  
**Contact:** PBS C5210R-EH, Ag Clad  
**Unit: mm**

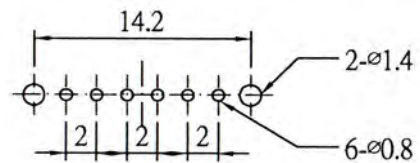
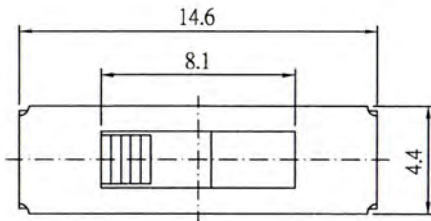

Recommended P.C.Board Layout

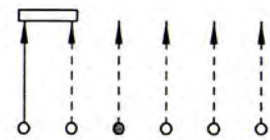
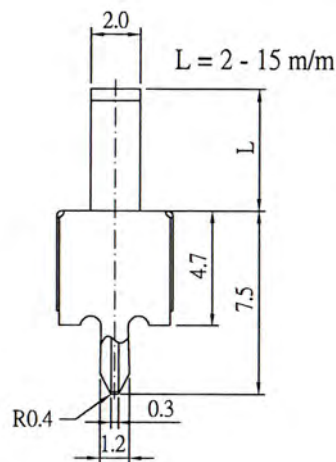
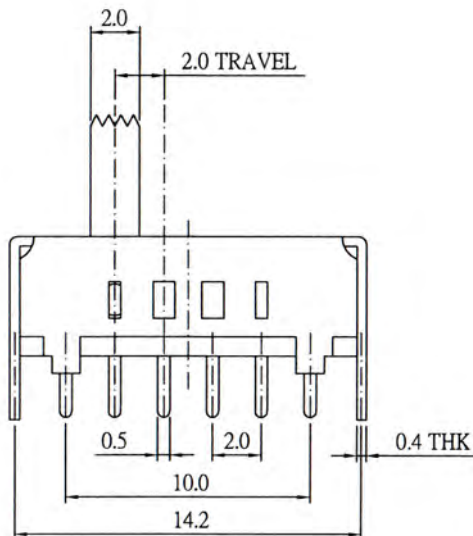

Shorting Schematic

### ORDERING INFORMATION:

**P/N S W S 9 2 -  $\frac{x P x T G x x}{1 \quad 2 \quad 3}$**

1. SWITCHING ACTION:  
"1P4T" ON-ON-ON-ON
2. KNOB TYPE:  
"G" TYPE G
3. KNOB LENGTH (L IN MM):  
02~15

## SLIDE SWITCHES STRAIGHT DIP TYPES (18)



### SPECIFICATIONS

**Circuit:** ON-ON-ON-ON (1P4T)  
**Rating:** D.C. 50V 0.3A  
**Contact R.[max]:** D.C. 5V 1A 30mΩ  
**Insulation R.[min]:** D.C. 500V 100MΩ  
**Withstand VOL.:** A.C. 500V 1minute  
**Timing:** Shorting  
**Operating force:** 300 ± 100g  
**Life cycle[max]:** 10,000 CYCLES  
**All materials must be RoHS compliant.**

### MATERIALS

**Knob:** POM, Black  
**Frame:** Steel Strip, Ni Plated or Zn Plated  
**Terminal Base:** Phenolic Resin  
**Terminal:** Brass Strip, Ag Plated Over Ni Plated  
**Contact Clip:** PBS C5210R-EH, Ag Clad  
**Spring Plate:** Stainless Steel  
**Unit:** mm

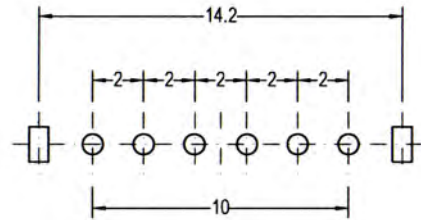
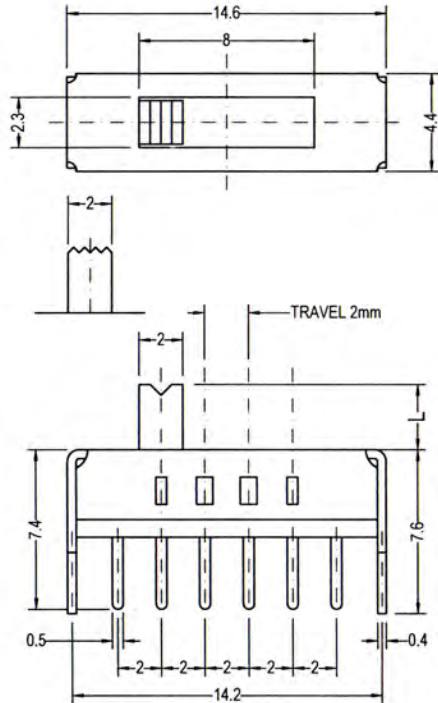

Recommended P.C.Board Layout

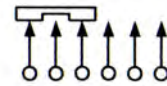
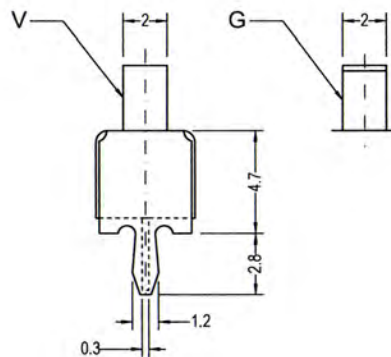

Schematic

KNOB TYPE	
V	G

### ORDERING INFORMATION:

**P/N S W S 1 Z -  $\frac{x P x T}{1} \frac{x x x}{2 3}$**

1. SWITCHING ACTION:  
"1P4T" ON-ON-ON-ON
2. KNOB TYPE:  
"G" TYPE G  
"V" TYPE V
3. KNOB LENGTH (L IN MM):  
02~15

## SLIDE SWITCHES STRAIGHT DIP TYPES (19)

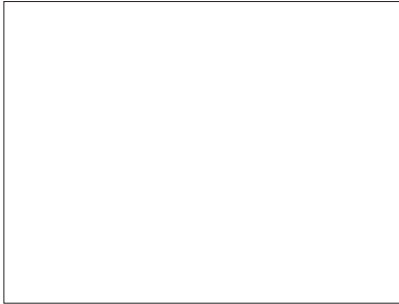

### SPECIFICATIONS

**Circuit:** ON-ON-ON-ON (1P4T)  
**Rating:** D.C. 50V 0.3A  
**Contact R.[max]:** D.C. 5V 1A 30mΩ  
**Insulation R.[min]:** D.C. 500V 100MΩ  
**Withstand VOL.:** A.C. 500V 1minute  
**Timing:** Shorting  
**Operating force:** 300 ± 100g  
**Life cycle[max]:** 10,000 CYCLES  
**All materials must be RoHS compliant.**

### MATERIALS

**Knob:** POM, Black  
**Frame:** Steel Strip, Ni Plated or Zn Plated  
**Terminal Base:** Phenolic Resin  
**Terminal:** Brass Strip, Ag Plated Over Ni Plated  
**Contact Clip:** PBS C5210R-EH, Ag Clad  
**Spring Plate:** Stainless Steel  
**Unit:** mm

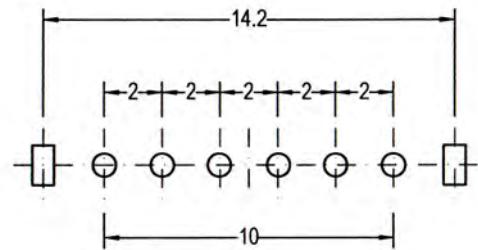
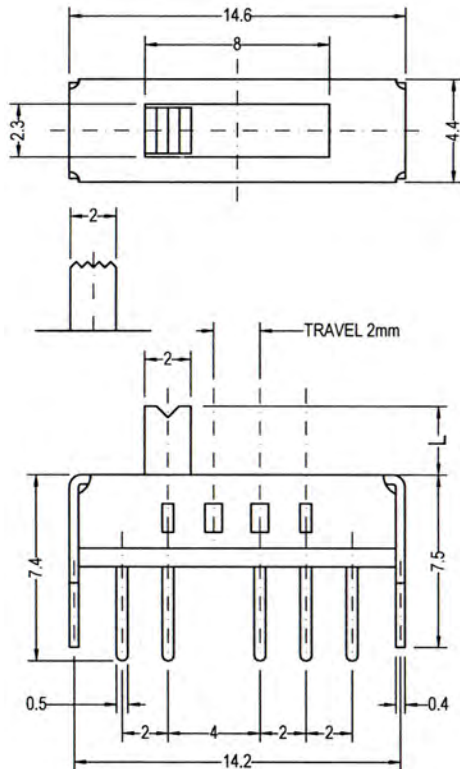

Recommended P.C.Board Layout

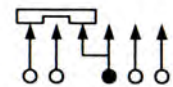
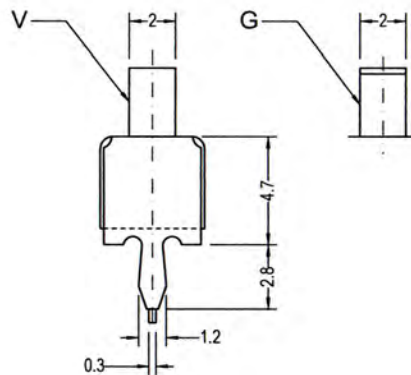

Schematic

KNOB TYPE	
V	G

## ORDERING INFORMATION:

**P/N S W S 3 N -  $\frac{x}{1} P x T \frac{x}{2} x x \frac{x}{3}$**

1. SWITCHING ACTION:  
"1P4T" ON-ON-ON-ON
2. KNOB TYPE:  
"G" TYPE G  
"V" TYPE V
3. KNOB LENGTH (L IN MM):  
02~15

## SLIDE SWITCHES STRAIGHT DIP TYPES (20)



### SPECIFICATIONS

**Circuit:** ON-ON-ON-ON-ON-ON (1P6T)

**Rating:** D.C. 50V 0.5A

**Contact R.[max]:** D.C. 5V 1A 30mΩ

**Insulation R.[min]:** D.C. 500V 100MΩ

**Withstand VOL.:** A.C. 500V 1minute

**Timing:** Shorting

**Operating force:** 300 ± 100g

**Life cycle[max]:** 10,000 CYCLES

All materials must be RoHS compliant.

### MATERIALS

**Cover:** 0.25mm SUS, Washing

**Knob:** Nylon, Black

**Case:** Brass Strip/Nylon 9T + F.G., Black/Ag Plated

**Contact:** PBS C5210R-EH, Ag Clad

**Unit:** mm

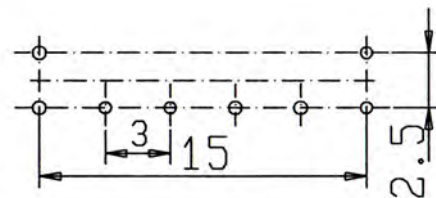
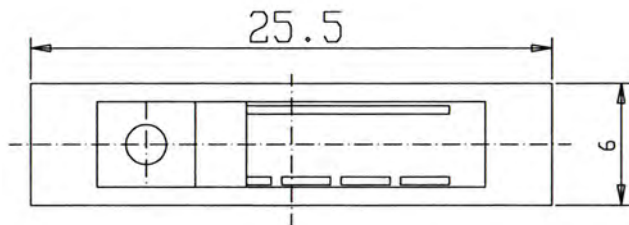

Recommended P.C.Board Layout

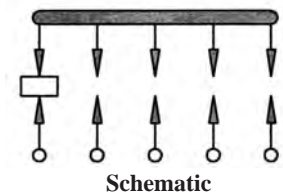
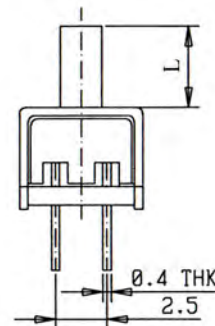
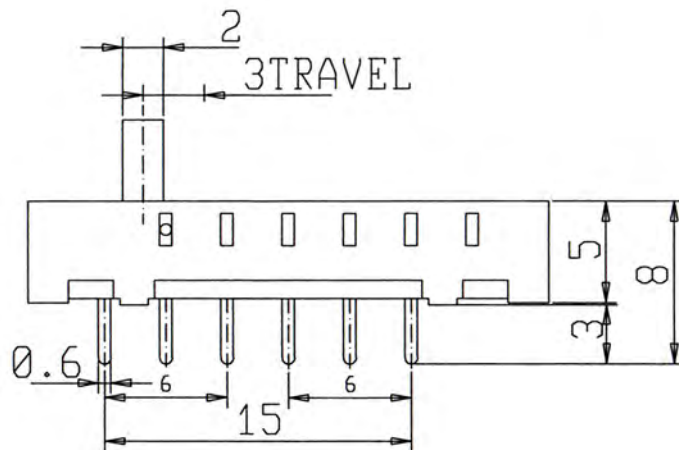

Schematic

### ORDERING INFORMATION:

**P/N S W S 9 3 -  $\frac{x}{1} \frac{P}{2} \frac{T}{3} \frac{F}{3} \frac{x}{3}$**

1. SWITCHING ACTION:  
"1P6T" ON-ON-ON-ON-ON-ON
2. KNOB TYPE:  
"F" TYPE F
3. KNOB LENGTH (L IN MM):  
02~15

## SLIDE SWITCHES STRAIGHT DIP TYPES (21)

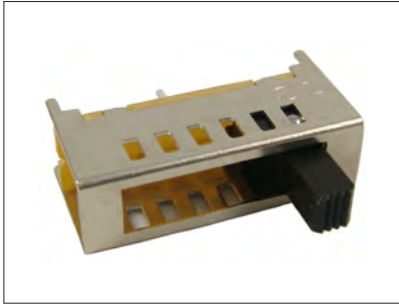

### SPECIFICATIONS

**Circuit:** ON-ON-ON-ON-ON-ON (1P6T)

**Rating:** D.C. 50V 0.5A

**Contact R.[max]:** D.C. 5V 1A 30mΩ

**Insulation R.[min]:** D.C. 500V 100MΩ

**Withstand VOL.:** A.C. 500V 1minute

**Operating force:** 400 ± 150g

**Life cycle[max]:** 10,000 CYCLES

All materials must be RoHS compliant.

### MATERIALS

**Cover:** 0.25mm SUS, Washing

**Knob:** Nylon, Black

**Case:** Brass Strip/Nylon 9T + F.G., Black/Ag Plated

**Contact:** PBS C5210R-EH, Ag Clad

**Unit:** mm

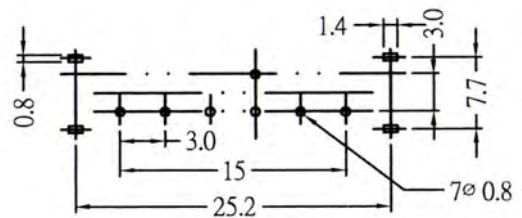
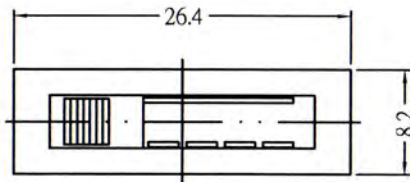

Recommended P.C.Board Layout

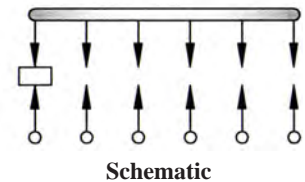
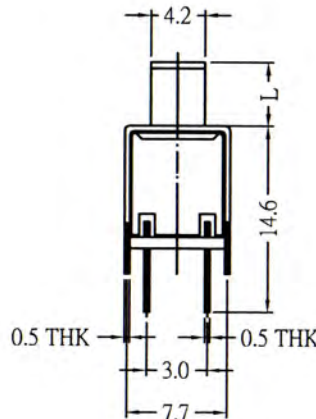
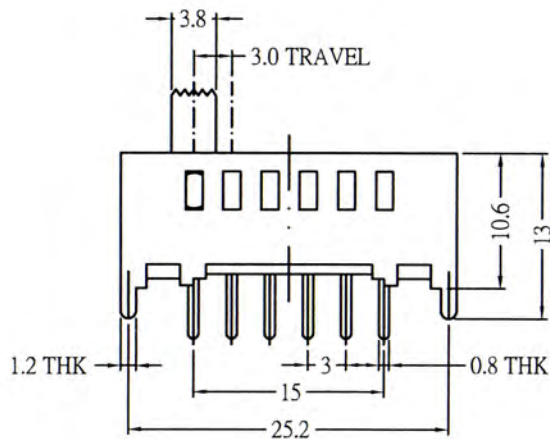

### ORDERING INFORMATION:

**P/N S W S 9 4 -  $\frac{x}{1}$  P  $\frac{x}{2}$  T G  $\frac{x}{3}$  X X**

1. SWITCHING ACTION:  
"1P6T" ON-ON-ON-ON-ON-ON
2. KNOB TYPE:  
"G" TYPE G
3. KNOB LENGTH (L IN MM):  
02~15

## SLIDE SWITCHES STRAIGHT DIP TYPES (22)

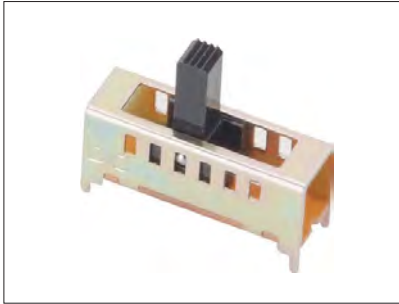

### SPECIFICATIONS

**Circuit:** ON-ON-ON-ON-ON-ON (1P6T)

**Rating:** D.C. 50V 0.5A

**Contact R.[max]:** 30mΩ

**Insulation R.[min]:** D.C. 500V 100MΩ

**Withstand VOL.:** A.C. 500V 1minute

**Timing:** Shorting

**Operating force:** 300 ± 100g

**Life cycle[max]:** 10,000 CYCLES

All materials must be RoHS compliant.

### MATERIALS

**Cover:** 0.25mm SUS, Washing

**Knob:** Nylon, Black

**Case:** Brass Strip/Nylon 9T + F.G., Black/Ag Plated

**Contact:** PBS C5210R-EH, Ag Clad

**Unit:** mm

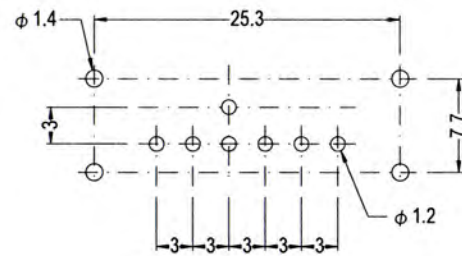
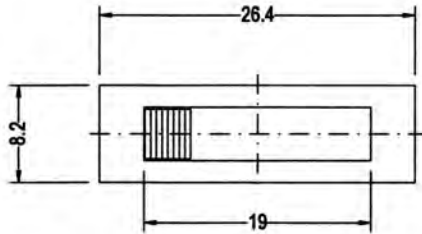

Recommended P.C.Board Layout

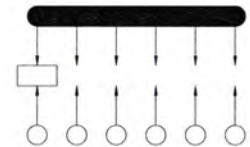
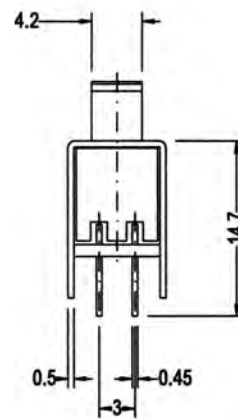
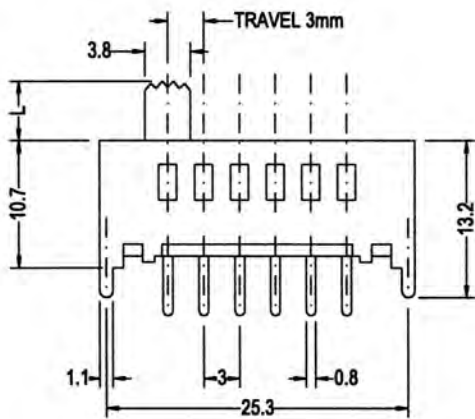

Schematic

KNOB TYPE	
V	G

## ORDERING INFORMATION:

P/N S W S 3 Z -  $\frac{x P x T}{1} \frac{x x x}{2 3}$

1. SWITCHING ACTION:  
"1P6T" ON-ON-ON-ON-ON-ON
2. KNOB TYPE:  
"G" TYPE G  
"V" TYPE V
3. KNOB LENGTH (L IN MM):  
02~15

## SLIDE SWITCHES STRAIGHT DIP TYPES (23)

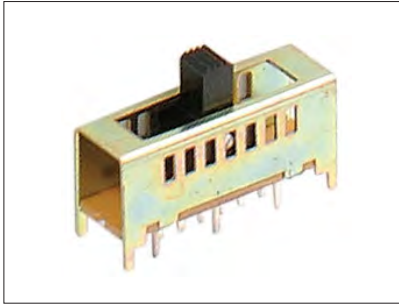

### SPECIFICATIONS

**Circuit:** ON-ON-ON-ON-ON-ON-ON (1P7T)

**Rating:** D.C. 50V 0.5A

**Contact R.[max]:** D.C. 5V 1A 30mΩ

**Insulation R.[min]:** D.C. 500V 100MΩ

**Withstand VOL.:** A.C. 500V 1minute

**Operating force:** 300 ± 100g

**Life cycle[max]:** 10,000 CYCLES

**All materials must be RoHS compliant.**

### MATERIALS

**Cover:** 0.25mm SUS, Washing

**Knob:** Nylon, Black

**Case:** Brass Strip/Nylon 9T + F.G., Black/Ag Plated

**Contact:** PBS C5210R-EH, Ag Clad

**Unit: mm**

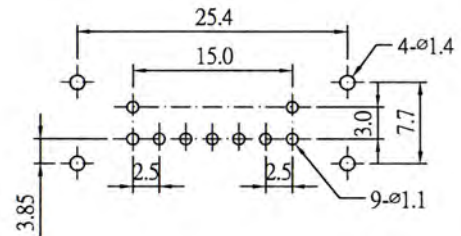
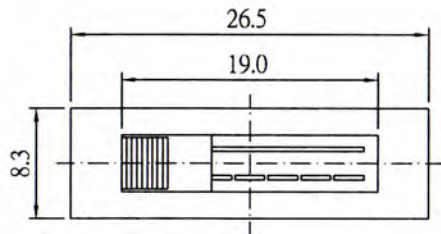

Recommended P.C.Board Layout

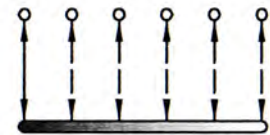
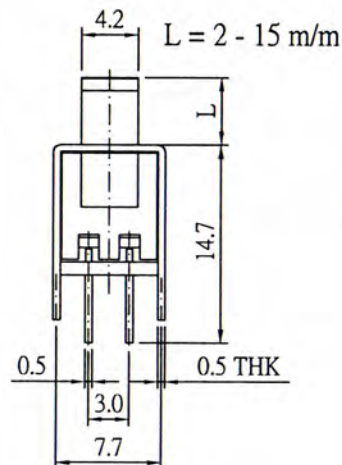
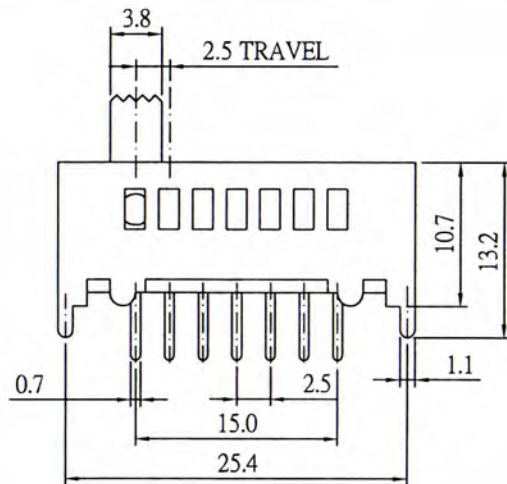

Shorting Schematic

### ORDERING INFORMATION:

**P/N S W S 9 5 -  $\frac{x}{1}$  P  $\frac{x}{2}$  T G  $\frac{x}{3}$  X X**

1. SWITCHING ACTION:  
"1P7T" ON-ON-ON-ON-ON-ON-ON
2. KNOB TYPE:  
"G" TYPE G
3. KNOB LENGTH (L IN MM):  
02~15