

514 Miniature Cartridge Fuse

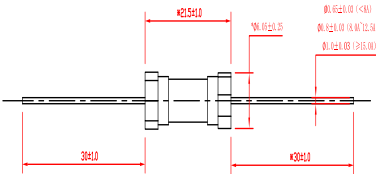

Dimensions (unit: mm)

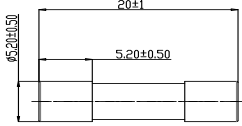

Main Characteristics

Miniature fuse; Time-Lag

Standard

UL248-14 IEC60127-7

Materials

Tube: Ceramic Tube
 End Caps: Nickel plated copper

Operating Temperature

-55°C to +125°C

Storage Conditions

+10°C to +60°C
 Relative humidity: ≤75% yearly average
 Without dew, maximum 30 days at 95%

Vibration Resistance

120 cycles in 1 direction at 1 min. each
 10-55Hz, 3 directions(X, Y, Z) in total
 According to MIL-STD-202 Method 201A

Soldering Parameters

260°C. ≤5 sec (Wave Soldering)
 350°C. ≤3 sec (Hand Soldering)
 Soldering Peak:
 260°C. 10 sec. (IEC 60068-20)

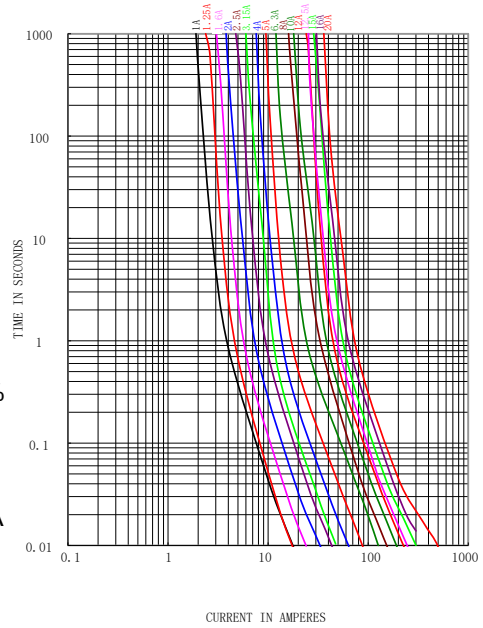

Time vs Current Characteristics: IEC 60127-2/V

Rated Current	150%	210%	275%	400%	1000%
1A~3.15A	>1h	<30min	750ms~80s	95ms~5s	10ms~150ms
4A~6.3A	>1h	<30min	750ms~80s	150ms~5s	10ms~150ms
8A~20A	>1h	<30min	750ms~80s	150ms~8s	10ms~150ms



Electrical Characteristics at 25°C

Amp Code	Rated Current	Rated Voltage	Nominal Melting I ² t (A ² sec)	Typical cold Resistance (mΩ)	Breaking Capacity	Approvals		
						cURus	TUV	CQC
1100	1.0A	600V AC 500V DC	4.37	336	400A@ 500V DC 100A@600V AC	•	•	○
1125	1.25A		3.90	204		•	•	○
1160	1.6A		7.16	146		•	•	○
1200	2.0A		13.1	123		•	•	○
1250	2.5A		23.7	62.5		•	•	○
1315	3.15A		29.5	34.9		•	•	○
1400	4.0A		50.3	25.0		•	•	○
1500	5.0A		102	17.3		•	•	○
1630	6.3A		258	11.8		•	•	○
1800	8.0A		237	7.31		•	•	○
2100	10.0A		497	5.90		•	•	•
2125	12.5A		730	4.49		•	•	○
2150	15.0A		1289	3.44		•	•	○
2160	16.0A		1417	3.40		•	•	○
2200	20.0A	2500	2.56	•	•	○		

Notes: (1) Permissible continuous operating current is ≤100% at ambient temperature of 23°C (73.4°F)
 (2) Typical pre-arcing I²t are measured at 10I_n current.

Ordering Information

Series	Amp Code	Supplementary Code	Qty
514			