

517 Miniature Cartridge Fuse

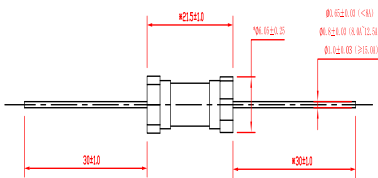

Dimensions (unit: mm)

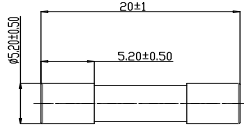

Main Characteristics

Miniature fuse; Very Fast-Acting

Standard

UL248-14 IEC60127-7

Materials

Tube: Ceramic Tube
End Caps: Nickel plated copper

Operating Temperature

-55°C to +125°C

Storage Conditions

+10°C to +60°C
Relative humidity: ≤75% yearly average
Without dew, maximum 30 days at 95%

Vibration Resistance

120 cycles in 1 direction at 1 min. each
10-55Hz, 3 directions(X, Y, Z) in total
According to MIL-STD-202 Method 201A

Soldering Parameters

260°C. ≤5 sec (Wave Soldering)
350°C. ≤3 sec (Hand Soldering)
Soldering Peak:
260°C. 10 sec. (IEC 60068-20)

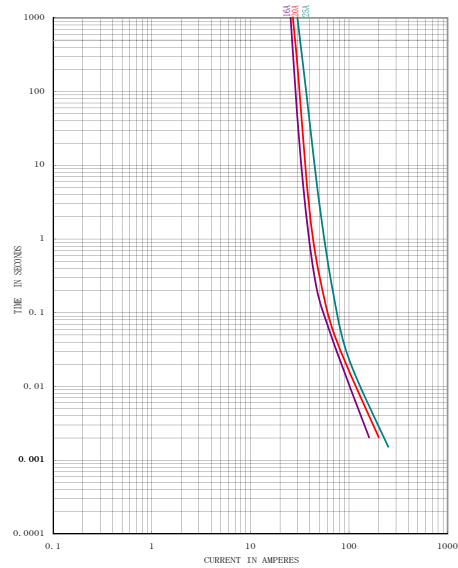

Time vs Current Characteristics: UL248-14

Rated Current	100%	210%	275%	400%	1000%
16A~25A	>1h	<30min	40ms~20s	10ms~1s	≤30ms



Electrical Characteristics at 25°C

Amp Code	Rated Current	Rated Voltage	Voltage drop Max.(mV)	Nominal Melting I ² t (A ² sec)	Typical cold Resistance (mΩ)	Breaking Capacity	Approvals	
							cURus	TUV
2160	16A	500V DC 600V AC	250	52.0	5.91	100A@600V AC 400A@500V DC	•	•
2200	20A		250	82.0	4.79		•	•
2250	25A		250	95.0	3.36		•	•

Notes: (1) Permissible continuous operating current is ≤100% at ambient temperature of 23°C (73.4°F)
(2) Typical pre-arcing I²t are measured at 10I_n current.

Ordering Information

Series	Amp Code	Supplementary Code	Qty
517			

