

525 Miniature Cartridge Fuse

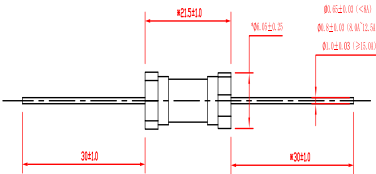

Dimensions (unit: mm)

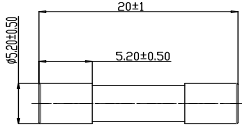

Main Characteristics

Miniature fuse; Fast-Acting

Standard

UL248-14 IEC60127-7

Materials

Tube: Ceramic Tube
End Caps: Nickel plated copper

Operating Temperature

-55°C to +125°C

Storage Conditions

+10°C to +60°C
Relative humidity: ≤75% yearly average
Without dew, maximum 30 days at 95%

Vibration Resistance

120 cycles in 1 direction at 1 min. each
10-55Hz, 3 directions(X, Y, Z) in total
According to MIL-STD-202 Method 201A

Soldering Parameters

260°C. ≤5 sec (Wave Soldering)
350°C. ≤3 sec (Hand Soldering)
Soldering Peak:
260°C. 10 sec. (IEC 60068-20)

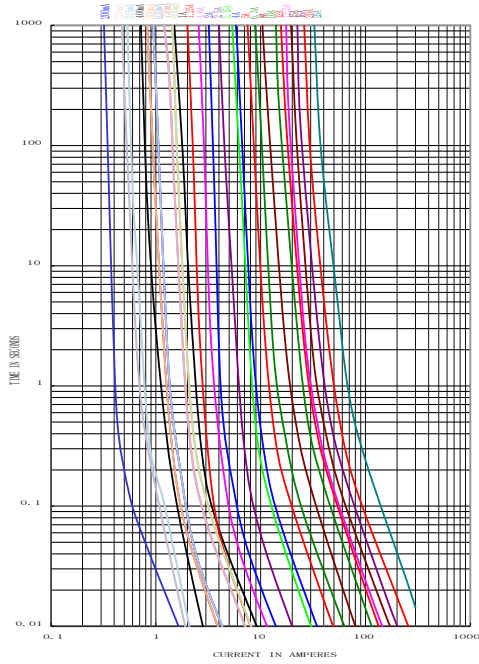

Time vs Current Characteristics: UL 248-14

Rated Current	100%	210%	275%	400%	1000%
100mA~25A	>1h	<30min	40ms~20s	10ms~1s	≤30ms



Electrical Characteristics at

Amp Code	Rated Current	Rated Voltage	Nominal Melting I²t (A²sec)	Typical cold Resistance (mΩ)	Breaking Capacity	Approvals			
						CCC	CQC	cURus	TUV
0200	200mA	250V AC 300V AC	0.010	14050	1500A@250V AC 1500A@300V AC	○	○	●	○
0250	250mA		0.021	12500		●	○	●	○
0315	315mA		0.016	7120		○	○	●	○
0400	400mA		0.040	4220		○	○	●	○
0500	500mA		0.130	458		●	○	●	●
0630	630mA		0.100	409		○	○	●	●
0750	750mA		0.480	264		○	○	●	●
0800	800mA		0.630	229		○	○	●	●
1100	1.00A		0.830	223		●	○	●	●
1125	1.25A		0.580	180		●	○	●	●
1160	1.60A		1.230	120		●	○	●	●
1200	2.00A		1.800	93.9		●	○	●	●
1250	2.50A		3.630	55.0		●	○	●	●
1315	3.15A		8.930	34.0		●	○	●	●
1400	4.00A		11.36	33.0		●	○	●	●
1500	5.00A		23.92	20.0		●	○	●	●
1630	6.30A		39.53	15.0		●	○	●	●
1800	8.00A		64.00	13.9		●	○	●	●
2100	10.00A		140.0	9.80		●	○	●	●
2120	12.00A		187.2	8.20		○	○	●	●
2125	12.50A		218.8	7.40		○	●	●	●
2150	15.00A		303.8	6.45		○	○	●	●
2160	16.00A	435.2	5.35	○	●	●	●		
2200	20.00A	700.0	4.25	○	●	●	●		
2250	25.00A	1458.33	3.25	○	○	●	●		

Notes: (1) Permissible continuous operating current is ≤100% at ambient temperature of 23°C (73.4°F)
(2) Typical pre-arcing I²t are measured at 10In current.

Ordering Information

Series	Amp Code	Supplementary Code	Qty
525			