



产品承认书

Product Approval Sheet

编号 NO.	P4KE-A/0-T
日期 Date	2021.10.20

客户 (Customer)	
品名 (Product)	TVS
系列 (Series)	P4KE

料号 (Part No.)		规格描述 (Specification)	备注 (Remark)
贝特电子 Betterfuse			
客户 Customer			

环保符合性说明 (Instructions for HSF)

本产品符合: RoHS 2.0 HF REACH LEAD FREE 其他备注

供应商-贝特 Supplier-Better fuse		确认合格章 (Confirm qualified Signet)	客 户 (Customer)	零件承认章 (Approval Signet)
制 作 Make	陈文珊			
审 核 Check	高飞			
确 认 Approval	项伟荣			

联络 (Contact)

业务 (Sales)	电话 (Telephone)	手机 (Cellphone)	邮箱 (E-mail)

零件承认后敬请回签一份给我司留存, 或将承认后的封面回传至我司邮箱, 谢谢!

Please sign a copy of the parts for our company or fax the acknowledged cover to our E-mail. Thanks!



变更履历 Modified Information

序号 (No.)	日期 (Date)	修订内容 (Modified Content)	页码 (Page)	版本 (Edition)	制定人 (Prepared by)	审核人 (Checked by)
1	2021.10.20	Draft	/	A/0	Wenshan Chen	Fei Gao

目录 (Table of contents)

Cover	1
Modified Information	2
1. Description.....	3
2. Features	3
3. Size.....	3
4. Electrical Characteristics	4
5. Ratings And V-I Characteristics Curves.....	6
6. Absolute Maximum Ratings.....	6
7. Package Information	7
8. Soldering Parameters.....	7



1. Description

The P4KE series of high current uni/bi-directional transient suppressors are designed for A.C. line protection and high power DC bus clamping applications. These devices offer uni/bi-directional port protection from 6.8 volts to 600 volts. They provide a clamping voltage lower than the avalanche voltage. Therefore, any voltage rise due to increased current conduction is contained to a minimum, providing the best possible protection level. They can also be connected in series and/or parallel to create very high capacity protection solutions.

2. Features

- ✧ Low zener impedance.
- ✧ Excellent clamping capability.
- ✧ JEDEC DO-41/DO-204AL Molded Plastic.
- ✧ Repetition rate (duty cycle): 0.01%.
- ✧ Color band denoted cathode except bidirectional.
- ✧ High temperature soldering: 260°C/10s at terminals.
- ✧ 400W Peak Pulse power capability at 10×1000µs waveform.
- ✧ Fast response time: typically less than 1.0ps from 0V to V_{BR} min.
- ✧ Glass passivated chip junction in DO-41/DO-204AL package.
- ✧ Meets MSL level 1, per J-STD-020.

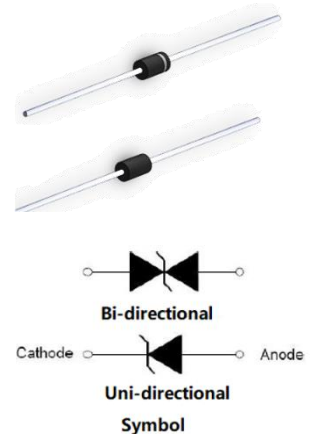

3. Size

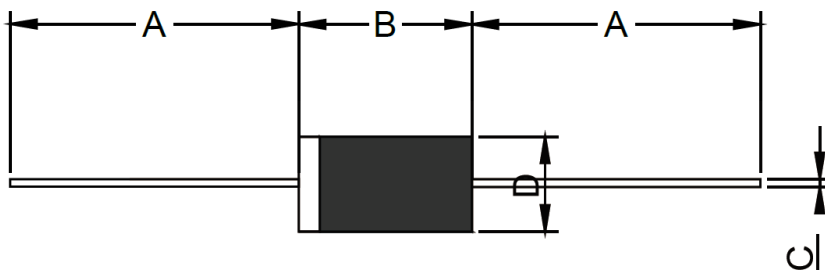

Ref.	Dimensions			
	Inches		Millimeters	
	Min.	Max.	Min.	Max.
A	1.000	-	25.40	-
B	0.193	0.209	4.90	5.30
C	0.027	0.035	0.69	0.89
D	0.095	0.110	2.40	2.80

4. Electrical Characteristics($T_A=25^{\circ}\text{C}$)

Part Number		V_R	$I_R@V_R$	$V_{BR}@I_T$		I_T	$V_C@I_{PP}$	I_{PP}°
Uni-Polar	Bi-Polar	V	μA	Min(V)	Max(V)	mA	Max(V)	A
P4KE6.8A	P4KE6.8CA	5.8	1000	6.45	7.14	10	10.5	38.1
P4KE7.5A	P4KE7.5CA	6.4	500	7.13	7.88	10	11.3	35.4
P4KE8.2A	P4KE8.2CA	7.02	200	7.79	8.61	10	12.1	33.1
P4KE9.1A	P4KE9.1CA	7.78	50	8.65	9.55	1	13.4	29.9
P4KE10A	P4KE10CA	8.55	10	9.50	10.50	1	14.5	27.6
P4KE11A	P4KE11CA	9.4	5	10.50	11.60	1	15.6	25.7
P4KE12A	P4KE12CA	10.2	5	11.40	12.60	1	16.7	24
P4KE13A	P4KE13CA	11.1	1	12.40	13.70	1	18.2	22
P4KE15A	P4KE15CA	12.8	1	14.30	15.80	1	21.2	18.9
P4KE16A	P4KE16CA	13.6	1	15.20	16.80	1	22.5	17.8
P4KE18A	P4KE18CA	15.3	1	17.10	18.90	1	25.2	15.9
P4KE20A	P4KE20CA	17.1	1	19.00	21.00	1	27.7	14.5
P4KE22A	P4KE22CA	18.8	1	20.90	23.10	1	30.6	13.1
P4KE24A	P4KE24CA	20.5	1	22.80	25.20	1	33.2	12.1
P4KE27A	P4KE27CA	23.1	1	25.70	28.40	1	37.5	10.7
P4KE30A	P4KE30CA	25.6	1	28.50	31.50	1	41.4	9.7
P4KE33A	P4KE33CA	28.2	1	31.40	34.70	1	45.7	8.8
P4KE36A	P4KE36CA	30.8	1	34.20	37.80	1	49.9	8.1
P4KE39A	P4KE39CA	33.3	1	37.10	41.00	1	53.9	7.5
P4KE43A	P4KE43CA	36.8	1	40.90	45.20	1	59.3	6.8
P4KE47A	P4KE47CA	40.2	1	44.70	49.40	1	64.8	6.2
P4KE51A	P4KE51CA	43.6	1	48.50	53.60	1	70.1	5.8
P4KE56A	P4KE56CA	47.8	1	53.20	58.80	1	77.0	5.2
P4KE62A	P4KE62CA	53.0	1	58.90	65.10	1	85.0	4.8
P4KE68A	P4KE68CA	58.1	1	64.60	71.40	1	92.0	4.4
P4KE75A	P4KE75CA	64.1	1	71.30	78.80	1	103.0	3.9
P4KE82A	P4KE82CA	70.1	1	77.90	86.10	1	113.0	3.6
P4KE91A	P4KE91CA	77.8	1	86.50	95.50	1	125.0	3.2
P4KE100A	P4KE100CA	85.5	1	95.00	105.0	1	137.0	3.0



Part Number		V _R	I _R @V _R	V _{BR} @I _T		I _T	V _C @I _{PP}	I _{PP} ①
Uni-Polar	Bi-Polar	V	μA	Min(V)	Max(V)	mA	Max(V)	A
P4KE110A	P4KE110CA	94.0	1	105.0	116.0	1	152.0	2.7
P4KE120A	P4KE120CA	102.0	1	114.0	126.0	1	165.0	2.5
P4KE130A	P4KE130CA	111.0	1	124.0	137.0	1	179.0	2.3
P4KE150A	P4KE150CA	128.0	1	143.0	158.0	1	207.0	2.0
P4KE160A	P4KE160CA	136.0	1	152.0	168.0	1	219.0	1.9
P4KE170A	P4KE170CA	145.0	1	162.0	179.0	1	234.0	1.8
P4KE180A	P4KE180CA	154.0	1	171.0	189.0	1	246.0	1.6
P4KE200A	P4KE200CA	171.0	1	190.0	210.0	1	274.0	1.5
P4KE220A	P4KE220CA	185.0	1	209.0	231.0	1	328.0	1.3
P4KE250A	P4KE250CA	214.0	1	237.0	263.0	1	344.0	1.2
P4KE300A	P4KE300CA	256.0	1	285.0	315.0	1	414.0	1.0
P4KE350A	P4KE350CA	300.0	1	332.0	368.0	1	482.0	0.85
P4KE400A	P4KE400CA	342.0	1	380.0	420.0	1	548.0	0.75
P4KE440A	P4KE440CA	376.00	1	418.0	462.0	1	602.0	0.68
P4KE480A	P4KE480CA	408.00	1	456.0	504.0	1	658.0	0.61
P4KE510A	P4KE510CA	434.00	1	485.0	535.0	1	698.0	0.57
P4KE530A	P4KE530CA	450.00	1	503.5	556.5	1	725.0	0.55
P4KE540A	P4KE540CA	459.00	1	513.0	567.0	1	740.0	0.54
P4KE550A	P4KE550CA	467.00	1	522.5	577.5	1	760.0	0.52
P4KE600A	P4KE600CA	510.00	1	570.0	630.0	1	828.0	0.48

① Surge waveform: 10/1000μs

V_R : Stand-off Voltage -- Maximum voltage that can be applied

V_{BR}: Breakdown Voltage

V_C: Clamping Voltage -- Peak voltage measured across the suppressor at a specified I_{pp}

I_R: Reverse Leakage Current



5. Ratings And V-I Characteristics Curves($T_A=25^{\circ}\text{C}$, Unless otherwise noted)

FIG.1: V-I curve characteristics (Uni-directional)

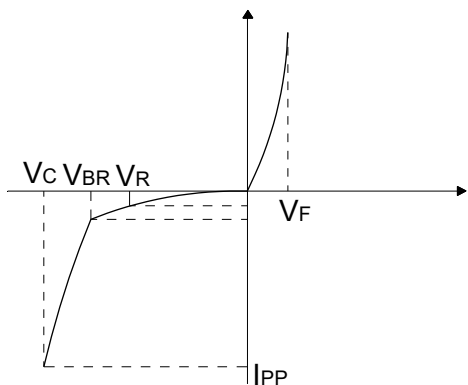

FIG.2: V-I curve characteristic (Bi-directional)

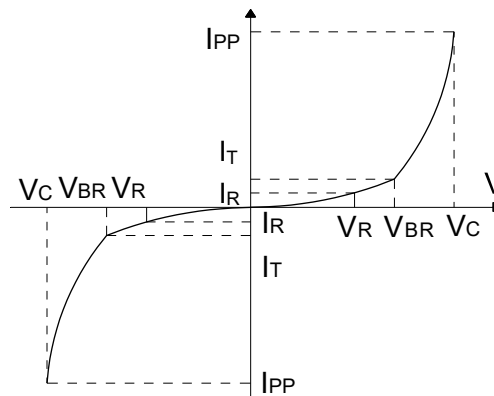

FIG.3: Pulse waveform

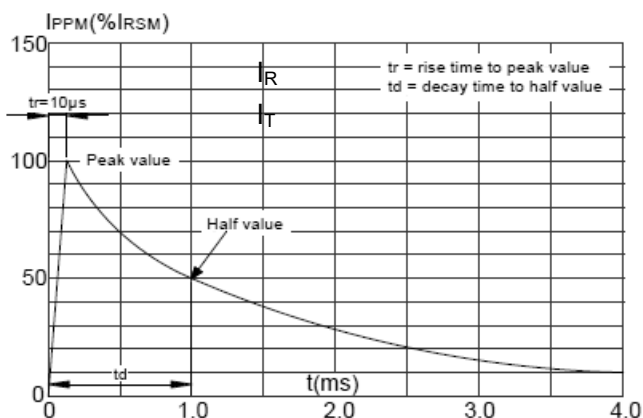
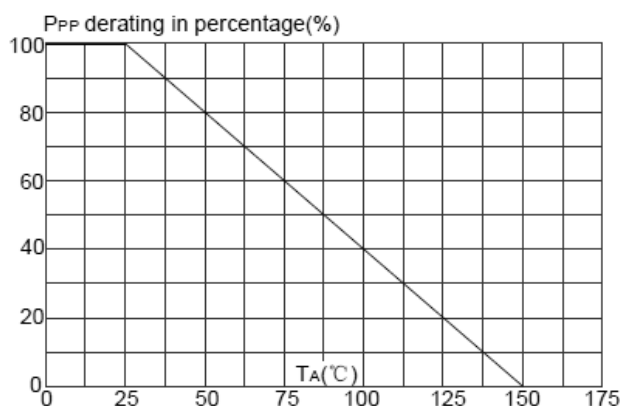

FIG.4: Pulse derating curve



6. Absolute Maximum Ratings($T_A=25^{\circ}\text{C}$, $RH=45\%-75\%$, unless otherwise noted)

Parameter	Symbol	Value	Unit
Operating junction and Storage temperature range	T_{STG}, T_J	-55 to +150	$^{\circ}\text{C}$
Peak pulse current of on 10/1000 μs waveform	I_{PP}	See next table	A
Steady state power dissipation at $T_L=75^{\circ}\text{C}$	$P_{M(AV)}$	1.0	W
Peak pulse power dissipation on 10/1000 μs waveform	P_{PP}	400	W
Peak forward surge current, 8.3ms single half sine-wave	I_{FSM}	40	A



7. Package Information

Part No.	Case Type	Quantity	Packing Option
P4KEXXCA/A	DO-41/DO-204AL	3000	Box

8. Soldering Parameters

Wave Soldering

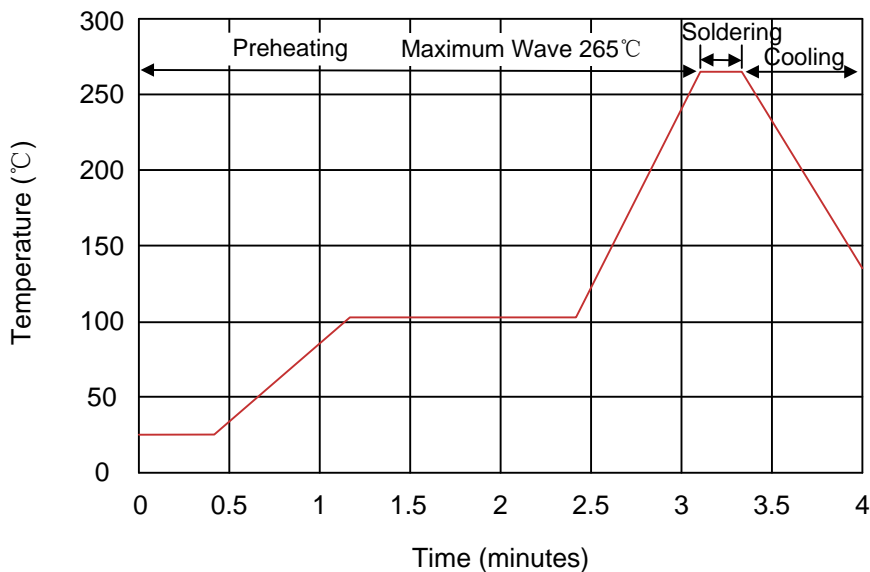

Item	Conditions
Peak Temperature	265°C
Dipping Time	10 seconds
Soldering	1 time