

## M12 Female Panel Mount, Die-cast Screw, PCB Type, Front fastened

- Connector series: M12
- Gender: Female
- Coding: A,B,C,D
- Locking type: Fix screw
- Mounting type: Front fastened
- Part No.: MB12FB\*FHD\*\*ST-3

\* refers to coding type  
\*\* refers to pins number

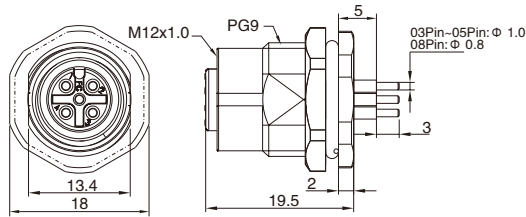

### General information

Standard:	IEC 61076-2-101
Ambient temperature:	-25°C ~ +90°C
Connector insert:	PA
Connector contacts:	Brass with gold plated
Connector nut/screw:	Zinc alloy with nickel plated
Seal / O-ring:	Epoxy resin / FKM

Insulation resistance:	≥ 100MΩ
Contact resistance :	≤ 5mΩ
Shielding:	Unavailable
IP rating:	IP68 in locked condition
Panel cut-out:	Refer to page 287
PCB layout:	Refer to page 286
Mating endurance:	>500 cycles

### Electrical data & Mechanical data

Contacts	Available Coding				Contacts termination	Rated current	Voltage		Part No.
	A	B	C	D			A/C	D/C	
03 pins					PCB version	4A	250V	250V	MB12FBAFHD03ST-3 MB12FBBFHD03ST-3 MB12FBCFHD03ST-3
04 pins					PCB version	4A	250V	250V	MB12FBAFHD04ST-3 MB12FBBFHD04ST-3 MB12FBCFHD04ST-3 MB12FDBFHD04ST-3
05 pins					PCB version	4A 2A(C-code)	60V	60V	MB12FBAFHD05ST-3 MB12FBBFHD05ST-3 MB12FBCFHD05ST-3
06 pins					PCB version	2A	30V	30V	MB12FBCFHD06ST-3
08 pins					PCB version	2A	30V	30V	MB12FBAFHD08ST-3

### Remarks

- Please refer to Page 96 for products' part number encoding rule.