

## M12 Male Panel Mount, Angled, PCB Type, Front fastened

- Connector series: M12
- Gender: Male
- Coding: A,B,D
- Locking type: Fix screw
- Mounting type: Right angled
- Part No.: MB12MB\*FF\*\*RA-0 (Unshielding)  
MB12MBS\*FF\*\*RA-0 (Shielding)

\* refers to coding type  
\*\* refers to pins number

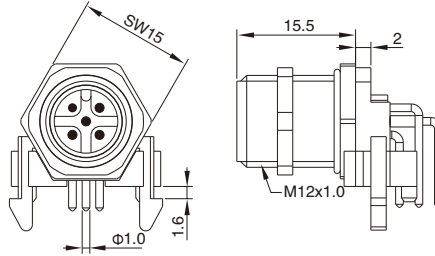

### General information

Standard:	IEC 61076-2-101
Ambient temperature:	-25°C ~ +90°C
Connector insert:	PA+GF
Connector contacts:	Brass with gold plated
Connector nut/screw:	Brass with nickel plated
Seal / O-ring:	FKM

Insulation resistance:	≥ 100MΩ
Contact resistance :	≤ 5mΩ
Shielding:	Unavailable / Available
IP rating:	IP68 in locked condition
Panel cut-out:	Refer to page 287
PCB layout:	Refer to page 286
Mating endurance:	>500 cycles

### Electrical data & Mechanical data

Contacts	Available Coding			Contacts termination	Rated current	Voltage		Part No.
	A	B	D			A/C	D/C	
04 pins				PCB version	4A	250V	250V	MB12MBAFF04RA-0 MB12MBSAFF04RA-0 MB12MBBFF04RA-0 MB12MBSBFF04RA-0 MB12MBDFF04RA-0 MB12MBSDFF04RA-0
05 pins				PCB version	4A	60V	60V	MB12MBAFF05RA-0 MB12MBSAFF05RA-0 MB12MBBFF05RA-0 MB12MBSBFF05RA-0
08 pins				PCB version	2A	30V	30V	MB12MBAFF08RA-0 MB12MBSAFF08RA-0

### Remarks

- Please refer to Page 96 for products' part number encoding rule.