

M12 Male Panel Mount, Die-cast Screw, Solder, Rear fastened

- Connector series: M12
- Gender: Male
- Coding: A,B,C,D
- Locking type: Fix screw
- Mounting type: Rear fastened
- Part No.: MB12MS*RHD**ST-3

* refers to coding type
** refers to pins number

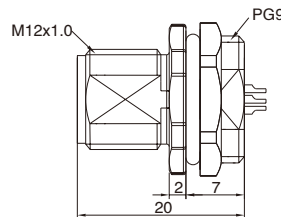
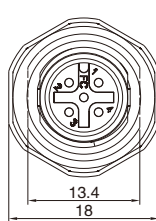

General information



Standard:	IEC 61076-2-101
Ambient temperature:	-25°C ~ +90°C
Connector insert:	PA
Connector contacts:	Brass with gold plated
Connector nut/screw:	Zinc alloy with nickel plated
Seal / O-ring:	Epoxy resin / FKM

Insulation resistance:	≥ 100MΩ
Contact resistance :	≤ 5mΩ
Shielding:	Unavailable
IP rating:	IP68 in locked condition
Panel cut-out:	Refer to page 287
Mating endurance:	>500 cycles

Electrical data & Mechanical data

Contacts	Available Coding				Contacts termination	Rated current	Voltage		Wire gauge / size		Part No.
	A	B	C	D			A/C	D/C	AWG	mm ²	
03 pins					Solder version	4A	250V	250V	22AWG	0.34	MB12MSARHD03ST-3 MB12MSBRHD03ST-3 MB12MSCRHD03ST-3
04 pins					Solder version	4A	250V	250V	22AWG	0.34	MB12MSARHD04ST-3 MB12MSBRHD04ST-3 MB12MSCRHD04ST-3 MB12MSDRHD04ST-3
05 pins					Solder version	4A 2A (C-code)	60V	60V	22AWG 24AWG (C-code)	0.34 0.25 (C-code)	MB12MSARHD05ST-3 MB12MSBRHD05ST-3 MB12MSCRHD05ST-3
06 pins					Solder version	2A	30V	30V	24AWG	0.25	MB12MSCRHD06ST-3
08 pins					Solder version	2A	30V	30V	24AWG	0.25	MB12MSARHD08ST-3

Remarks

- Please refer to Page 578 for the Conversion between American Wire Gauge AWG and Wire Cross-section mm².
- Please refer to Page 96 for products' part number encoding rule.