

## M16 Male Panel Mount, Quick-lock Type, PCB Type, Front fastened

- Connector series: M16
- Gender: Male
- Locking type: Quick-lock
- Mounting type: Front fastened
- Part No.: MB16MBAFQ\*\*ST

\*\* refers to pins number

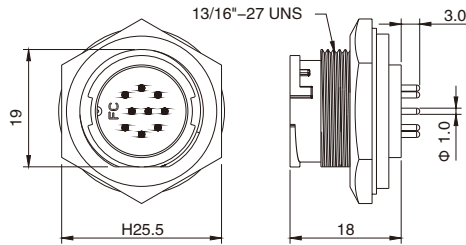

### General information

RoHS

Ambient temperature:	-25°C ~ +90°C
Connector insert:	PA + GF
Connector contacts:	Brass with gold plated
Coupling nut/screw:	PA+GF
Seal / O-ring:	Epoxy resin / FKM

Insulation resistance:	≥ 100MΩ
Contact resistance :	≤ 5mΩ
Shielding:	Unavailable
IP rating:	IP65, IP67 in locked condition
Mating endurance:	>100 cycles

### Electrical data & Mechanical data

Contacts	Contact termination	Rated current	Voltage		Part No.
			A/C	D/C	
08 pins	PCB version	4A	250V	300V	MB16MBAFQ08ST
09 pins	PCB version	4A	250V	300V	MB16MBAFQ09ST

### Panel Cut-out Dimensions

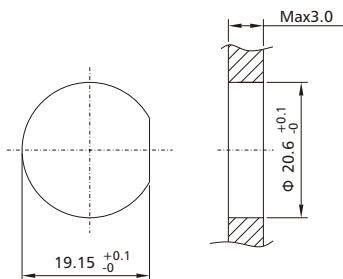

### PCB Layout

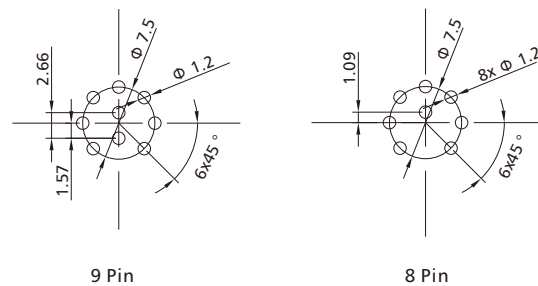

### Remarks

- Please Refer to page 292 for products' part number encoding rule.