

M5 Male Panel Mount, PCB Type, Front fastened, Shielded

- Connector series: M5
- Gender: Male
- Coding: A
- Locking type: Fix screw
- Mounting type: Front fastened
- Part No.: MB05MBSAFF**ST

**refers to pins number

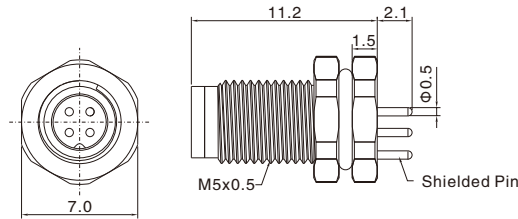

General information



Standard:	IEC 61076-2-105
Ambient temperature:	-25°C ~ +90°C
Connector insert:	TPU
Connector contacts:	Brass with gold plated
Connector nut/screw:	Brass with nickel plated
Seal / O-ring:	Epoxy resin / FKM

Insulation resistance:	≥ 100MΩ
Contact resistance:	≤ 5mΩ
Shielding:	Available
IP rating:	IP67 in locked condition
Mating endurance:	>500 cycles

Electrical data & Mechanical data

Contacts		Contacts termination	Rated current	Voltage		Part No.
				A/C	D/C	
03 pins		PCB version	1A	60V	60V	MB05MBSAFF03ST
04 pins		PCB version	1A	60V	60V	MB05MBSAFF04ST

Panel Cut-out Dimensions

With bare hole With thread to screw in

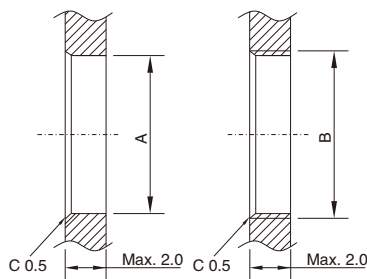

PCB Layout

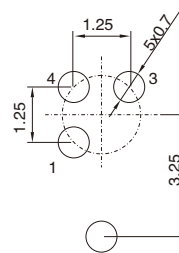

3P (Pin OD: Φ 0.5)

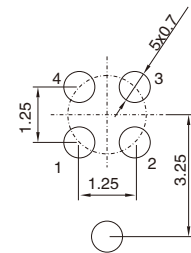

4P (Pin OD: Φ 0.5)

Remarks

- Please refer to Page 3 for products' part number encoding rule.