

RM-P Series

Plastic Push Pull Self-locking Connector

- Secure Push-pull Self-locking system
- High density assembly to save space
- Alignment Key and Polarized Keying System to avoid cross-interface
- Colorful nut for choice, easy for identify
- Available solder, PCB and right angle PCB contact



RM-P Series

Plugs (plastic)



PAG



PAG

Receptacles (plastic)



PKG



PLG



PKG

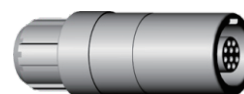

PRG

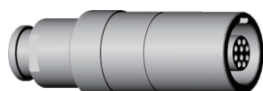

PRG

Plugs (metal)



PAG



PAG

Receptacles (metal)

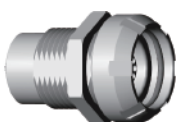

HHG



PHG

Part Numbering System

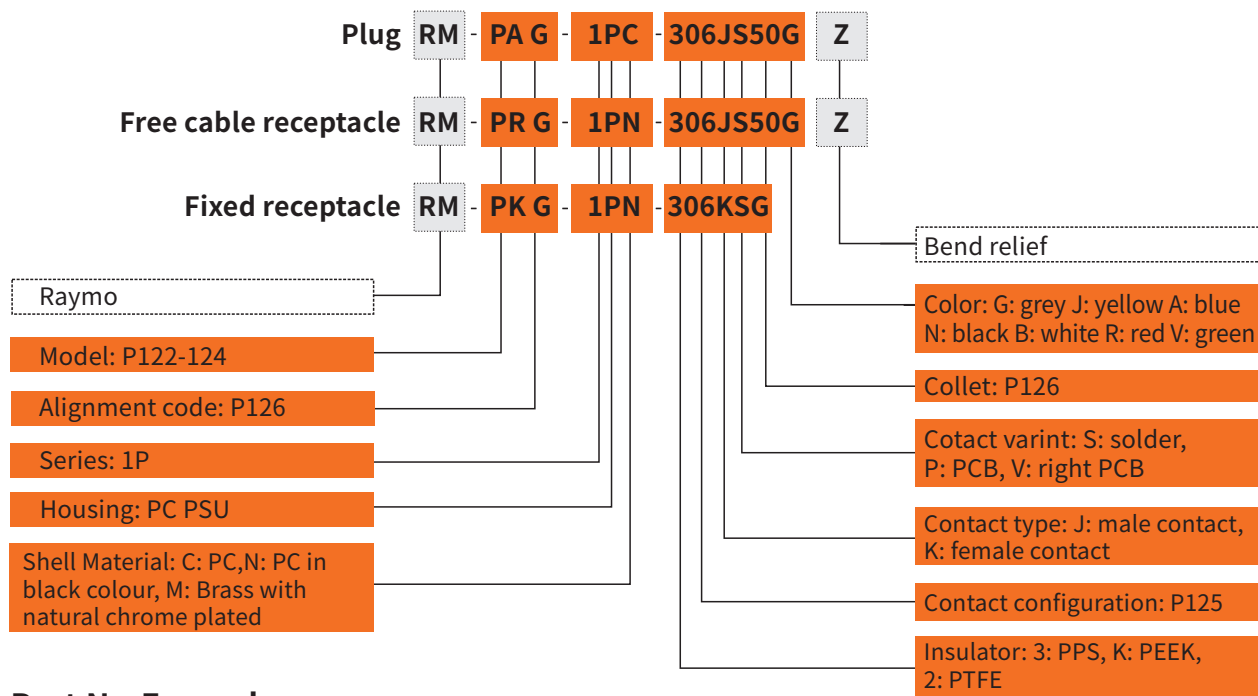

Part No.Example

Straight plug

RM-PAG-1PC-306JS52GZ= straight plug with cable collet and alignment key(G=0 degree), multipole 6 male contacts in solder type, gray outer shell, PPS insulator, collet for 4.2-5.2mm diameter cable nut for fitting a bend relief, with a gray colour bend relief.

Free cable receptacle

RM-PRG-1PC-306KS50GZ= free cable receptacle with cable collet, alignment key(G=0degree), multipole 6 female contacts in solder type, gray colour PC outer shell, PPS insulator, collet for cable 4.2-5.2mm and blue colour nut.

Fixed receptacle

RM-PKG-1PC-306KSG= fixed receptacle with two nuts and alignment key(G=0 degree), multipole 6 female contacts in solder type, gray colour PC outer shell, PPS insulator, gray colour plastic front nut.

Part Section Showing Internal Components

Cable Mount Plug

- ① Outer shell
- ② latch sleeve
- ③ Insulator
- ④ Male contact
- ⑤ Cable collet
- ⑥ Collet nut

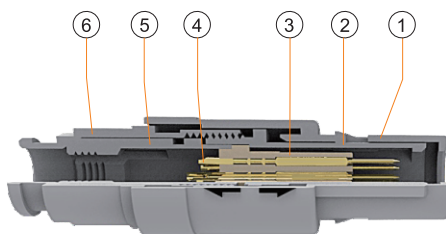

Fixed Receptacle

- ① outer shell
- ② Front notched nut
- ③ Insulator
- ④ Hexagonal nut
- ⑤ Female contact

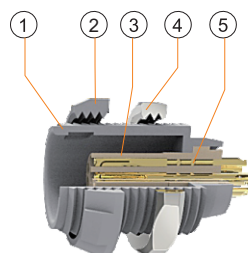

RM-P

Technical Characteristics

Mechanical and Climatical

Characteristics	Value	Standard
Endurance	>1000cycles	IEC60512-5test9a
Humidity	Up to 95% at 60°C	
Temperature range	-40°C, +120°C	
Resistance to vibration	10-2000Hz, 15g	IEC 60512-4 test 6d
Shock resistance	100g, 6ms	IEC 60512-4 test 6c
Protection index (mated)	IP50	IEC 60529
Climatical category	55/175/21	IEC 60068-1

RM-P

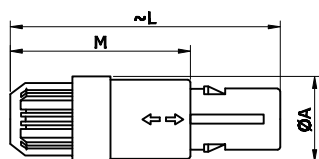

RM-PAG Cable Mount Straight plug

Reference		Dimensions(mm)		
Model	Series	A	L	M
RM-PAG	1P	14	46.5	32

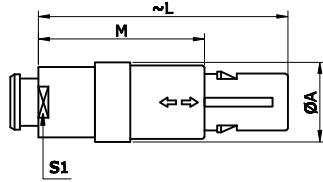

RM-PAG Cable Mount Straight plug, nut for fitting a bend relief

Reference		Dimensions(mm)			
Model	Series	A	L	M	S1
RM-PAG	1P	14	45.5	32	9

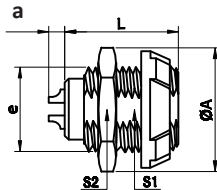
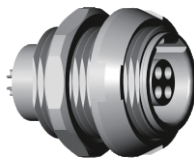

RM-PKG Fixed Receptacle with two nuts, back panel mounting

Reference		Dimensions(mm)					
Model	Series	A	L	a	e	S1	S2
RM-PKG	1P	18.5	20.5	2.7	M14*1.0	12.5	17

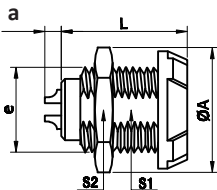
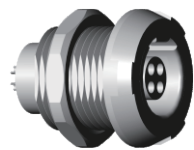

RM-PLG Fixed Receptacle, all-in-one type, key(G) or and nut fixing

Reference		Dimensions(mm)					
Model	Series	A	L	a	e	S1	S2
RM-PLG	1P	19.5	20.5	2.7	M14*1.0	12.5	17

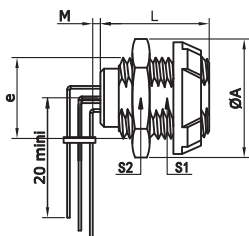

RM-PKG Fixed Receptacle with two nuts, back panel mounting elbow 90° contact for printed circuit

Reference		Dimensions(mm)					
Model	Series	A	L	a	e	S1	S2
RM-PKG	1P	19.5	20.5	2.0	M14*1.0	12.5	17.0

RM-P

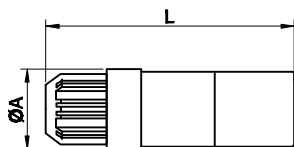
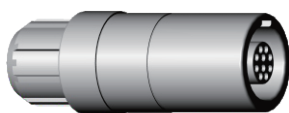

RM-PRG Cable Mount Receptacle

Reference		Dimensions(mm)	
Model	Series	A	L
RM-PRG	1P	14	40

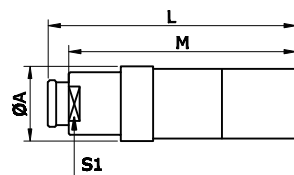
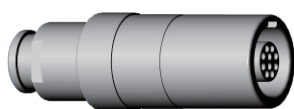

RM-PRG Cable Mount Receptacle, nut for fitting a bend relief

Reference		Dimensions(mm)			
Model	Series	A	L	M	S1
RM-PRG	1P	14	43	38.7	9

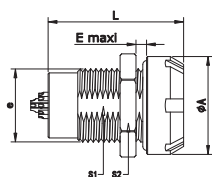
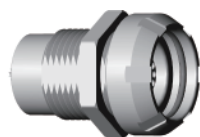

RM-HHG Fixed metal socket

Reference		Dimensions(mm)					
Model	Series	A	B	E	e	S1	S2
RM-HHG	1P	18.5	26.6	10	M14*1.0	12.5	17



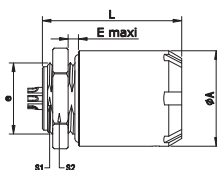
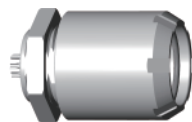







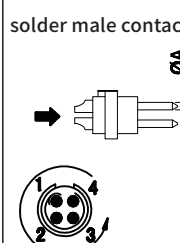
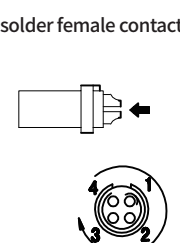
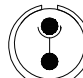
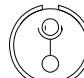



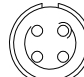

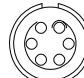

RM-P

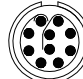
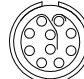

RM-PHG Fixed metal socket

Reference		Dimensions(mm)					
Model	Series	A	B	E	e	S1	S2
RM-HHG	1P	18.5	27	3.0	M14*1.0	12.5	17

Technical Characteristics

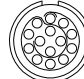
	solder male contact 	solder female contact 	Insulator	Contact No.	ØA(MM)	Contact type			Test voltage(contact -shell)/k/v AC-rms	Test voltage(contact -contact)/k/v AC-rms	Rated current /A
						Solder contact	PCB straight contact	PCB elbow contact			
1P			302	2	1.3	●	●	●	1.20	1.30	10.0
			303	3	1.3	●	●	●	1.30	1.10	10.0
			304	4	0.9	●	●	●	1.05	0.80	7.0
			305	5	0.9	●	●	●	1.05	0.80	7.0
			306	6	0.7	●	●	●	1.05	0.85	6.0
			307	7	0.7	●	●	●	1.05	0.85	5.0
			308	8	0.7	●	●	●	1.05	0.60	5.0
			309	9	0.5	●	●	●	0.85	0.60	3.0
			310	10	0.5	●	●	●	0.85	0.45	3.0
			312	12	0.5	●	●	●	0.60	0.50	2.0
			314	14	0.5	●	●	●	0.60	0.50	2.0

- First choice alternative
- Special order alternative

RM-P

RM-P series Cable collet

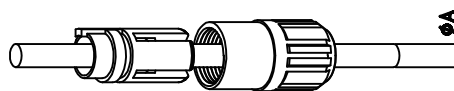

ΦA(mm)	CableΦ(mm)	
	Min	Max
3.9	3.9	2.7
5.2	4.0	5.2
6.5	5.3	6.5

Alignment keys:

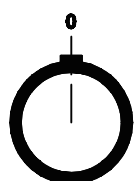

G=standard key

G



A=two keys with 40 degree

A

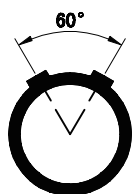

B=two keys with 60 degree

B



C=two keys with 80 degree

C

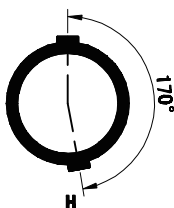

H=two keys with 170 degree

H

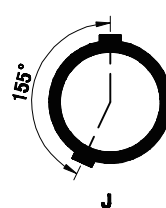

J=two keys with 155 degree

J

RM-P