

Power Relays

El.italia serie FW-FRA6W

Features

Miniature, high-capacity power relay ideal for incorporation in non-industrial
 Used with motor, transformer, lamp, heater, air conditioning, etc.
 Nonflammable insulating materials meet UL94V-0
 Heavy duty, switching current up to 25A, high inrush current up to 80A



RoHS: E139468

Ordering information

FRA6W - A - DC12V
 1 2 3

1 Relay model
 2 Contact arrangement: A: 1 Form A
 3 Rated voltage

Note: RoHS : RoHS compliant relay
 RoHS-I : AgNi contact
 RoHS-N: AgSnO₂ contact

Coil rating

Rated voltage (V)	Coil resistance Ω±/-10%	Rated current (mA)	Must operate voltage	Must dropout voltage	Maximum voltage	Power consumption (W) Approx.	Operate time (ms)	Release time (ms)
			% of rated voltage (at 20°C)					
5	28	180	75 Max.	10 Min.	110 Max.	0.9	<20	<10
6	40	150						
9	90	100						
12	160	75						
24	640	37.5						
48	2560	18.75						
110	13440	8						

CAUTION: 1. The use of any coil voltage less than the rated coil voltage will compromise the operation of the relay.
 2. Pickup and release voltage are for test purposes only and are not to be used as design criteria.

Characteristics

Contact arrangement	SPST (1 Form A)
Contact material	Silver alloy
Contact resistance	50mΩ Max.
Contact rating (resistive)	Resistive: 25A 277VAC/30VDC Inductive: 20A 250VAC (CosΦ=0.7) Motor: 1½HP 250VAC; 1HP 125VAC
Switching power	6.925VA Max.
Switching voltage	AC 300V Max.
Insulation resistance	1,000MΩ Min. (500VDC)
Dielectric strength	1,200VAC (50Hz/min) Between open contacts 3,600VAC (50Hz/min) Between coil and contact Surge voltage: 10KV
Shock resistance	Functional : 100m/s ² 11ms Destructive: 1,000m/s ² 11ms
Vibration resistance	1.5mm Double amplitude 10-55Hz
Ambient temperature	-40°C to +85°C
Humidity	85% RH, 40°C
Operation life	Mechanical 5 x 10 ⁷ Electrical 10 ⁵ (at rated load)
Weight	32g Approx.

(Specifications are subject to change without notices.)

Dimensions

mm

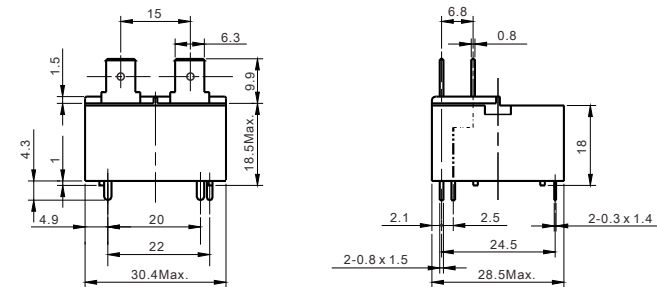

Mounting holes

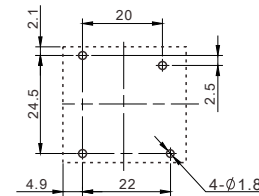

Wiring diagram (Bottom view)

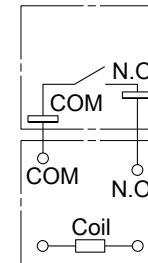

Reference data

Max. Switching Power

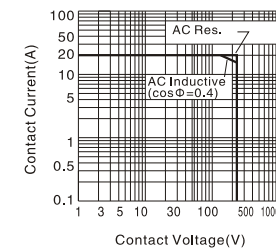

Endurance Curve

