

**SPECIFICATIONS:**

CONTACT RATING: Refer to "Contact Material Options" for more info.  
 ELECTRICAL LIFE: 50,000 make-and-break cycles at full load.  
 CONTACT RESISTANCE: 10mΩ max. initial  
 INSULATION RESISTANCE: 1,000MΩ min. (500VDC for 1 minute)  
 DIELECTRIC STRENGTH: 1,500V RMS @ sea level.  
 OPERATING TEMPERATURE: -30°C to +85°C  
 IP67 FRONT PANEL PROTECTION

**MATERIALS:**

CASE: Diallyl phthalate(DAP)(UL 94V-0)  
 TOGGLE HANDLE: Brass, chrome plated.  
 BUSHING: Brass, nickel plated.  
 HOUSING: Stainless Steel.  
 TERMINAL SEAL: Epoxy.

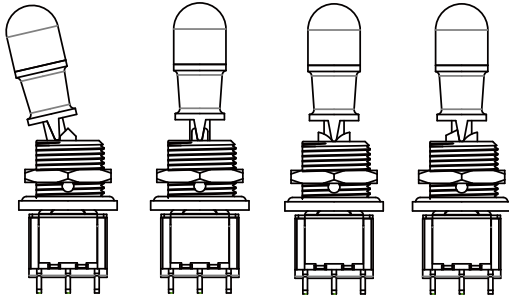

Specifications and Dimensions subject to change

If your preferred product configuration is not shown, please contact our sales representative for custom design.

**HOW TO ORDER SYSTEM**

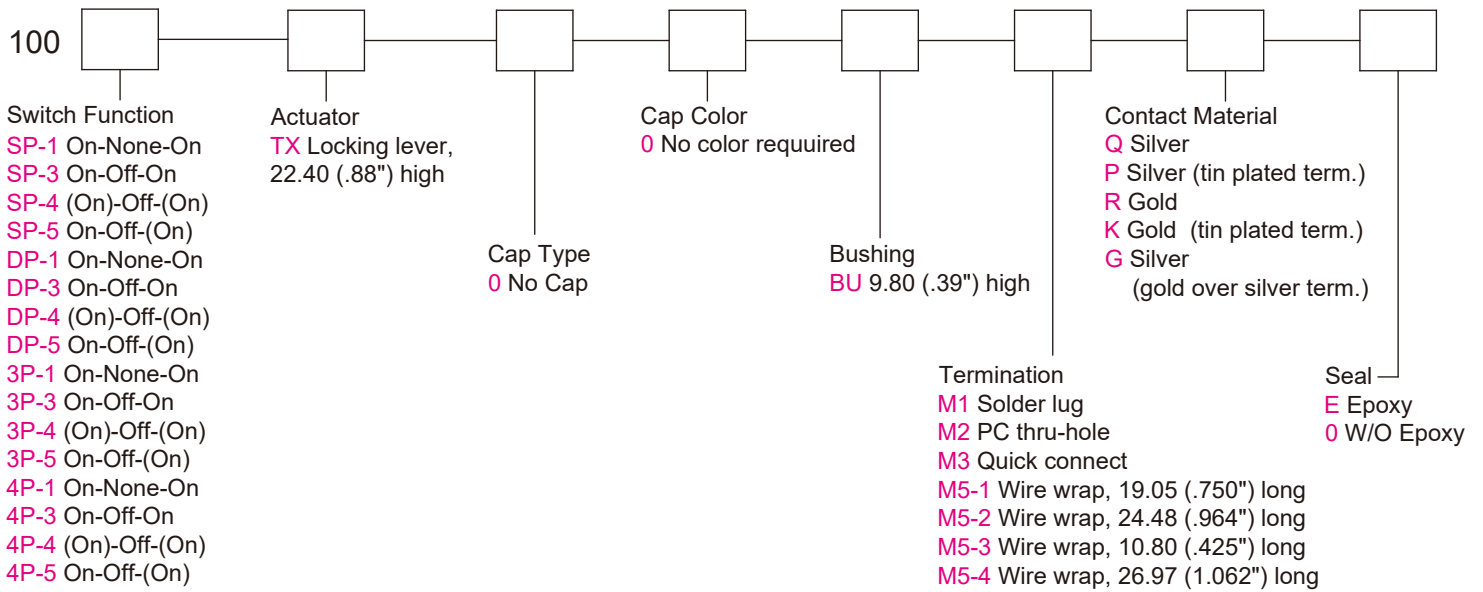

# Series 100

# Miniature Toggle Switches

## SPDT



Model No.	Switching Position		
SP-1	ON	NONE	ON
SP-3	ON	OFF	ON
SP-4	(ON)	OFF	(ON)
SP-5	ON	OFF	(ON)
Term. Comm.	2-3	OPEN	2-1

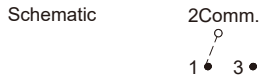
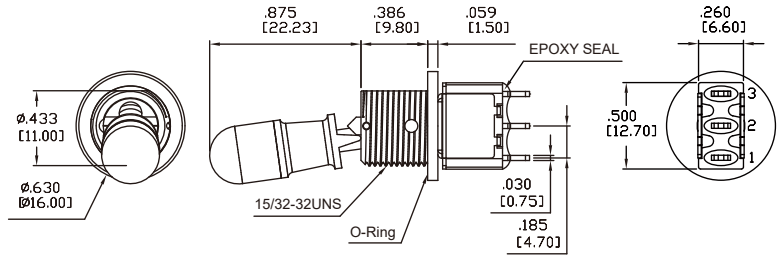

## DPDT



Model No.	Switching Position		
DP-1	ON	NONE	ON
DP-3	ON	OFF	ON
DP-4	(ON)	OFF	(ON)
DP-5	ON	OFF	(ON)
Term. Comm.	2-3,5-6	OPEN	2-1,5-4

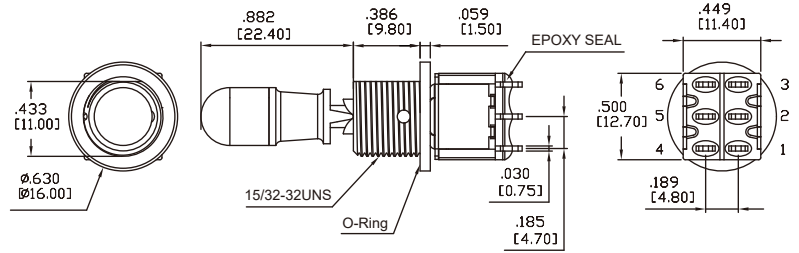

## 3PDT



Model No.	Switching Position		
3P-1	ON	NONE	ON
3P-3	ON	OFF	ON
3P-4	(ON)	OFF	(ON)
3P-5	ON	OFF	(ON)
Term. Comm.	2-3,5-6 8-9	OPEN	2-1,5-4 8-7

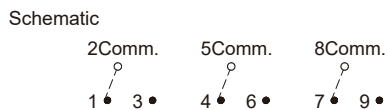
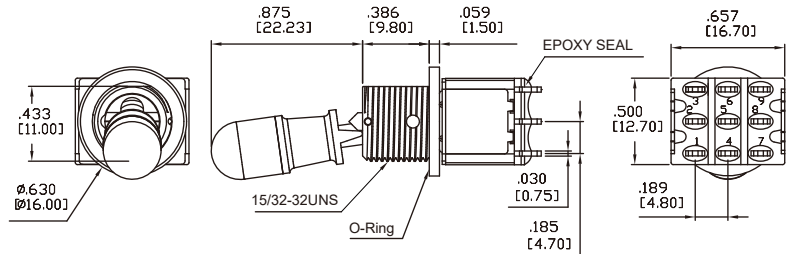

## 4PDT



Model No.	Switching Position		
4P-1	ON	NONE	ON
4P-3	ON	OFF	ON
4P-4	(ON)	OFF	(ON)
4P-5	ON	OFF	(ON)
Term. Comm.	2-3,5-6 8-9 11-12	OPEN	2-1,5-4 8-7 11-10

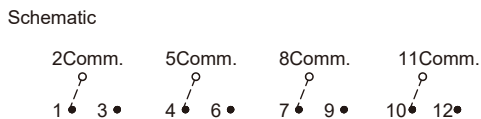
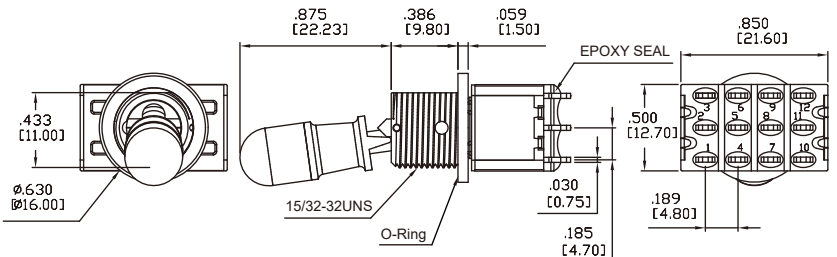

## ACTUATOR OPTIONS

TX

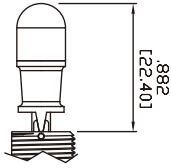

## BUSHING OPTIONS

BU

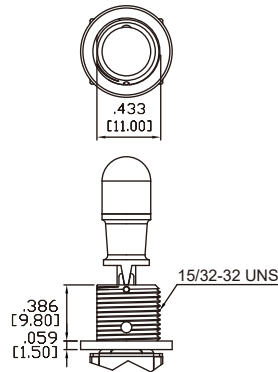

## PANEL MOUNTING

15/32 INCH BUSHING

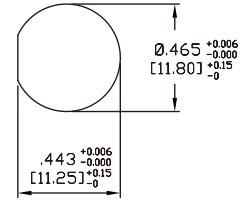

## TERMINATION OPTIONS

M1 STD. SOLDER LUG

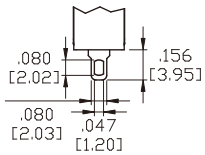

THK .030 [0.75]

M2 PC THRU-HOLE

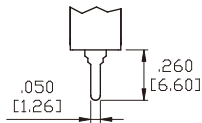

THK .030 [0.75]

M3 QUICK CONNECT

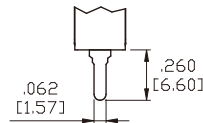

THK .030 [0.75]

M5 WIRE WRAP

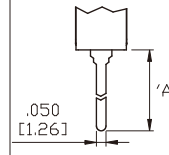

THK .030 [0.75]

OPTION CODE	DIM.'A'
M5-1	.750 [19.05]
M5-2	.964 [24.48]
M5-3	.425 [10.80]
M5-4	1.062 [26.97]

## HARDWARE

NUT

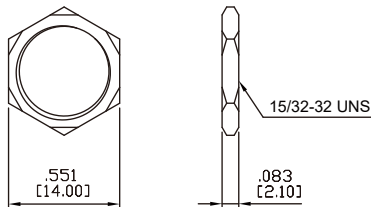

O-Ring

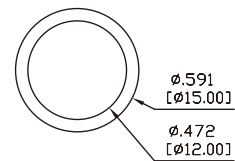

## CONTACT MATERIAL OPTIONS

Coding	Contact Material	Terminal Plating	Rating	Agency Approvals
Q	Silver <sup>1</sup>	Silver plated <sup>1</sup>	5Amps @ 125VAC or 28VDC 2Amps @ 250VAC	
P		Tin plated <sup>5,7</sup>		
R	Gold <sup>2</sup>	Gold plated <sup>4</sup>	0.4VA max @ 20V max (AC or DC)	
K		Tin plated <sup>5,6</sup>		
G	Silver <sup>1</sup>	Gold over silver <sup>3</sup>	5Amps @ 125VAC or 28VDC 2Amps @ 250VAC	

1. Movable Contact / Terminals: Copper alloy, silver plated.
2. Movable Contact: Copper alloy with gold plated over nickel plated.
3. Terminals: Silver plated with outer layer in gold plating.
4. Terminals: Copper alloy, with gold plated over nickel plated.
5. Outer Terminals: Copper alloy with pure tin plated.
6. Terminal Contact: Gold plated over nickel plated.
7. Terminal Contact: Palladium nickel alloy (or Silver) plated.

\* P, K not available with M1 and M3 terminals

\* 6Amps (Movable Contact: coin silver, silver plated) available to model ON-NONE-ON without UL approval