

SPECIFICATIONS:

CONTACT RATING: Refer to "Contact Material Options" for more info.
 ELECTRICAL LIFE: 30,000 make-and-break cycles at full load.
 CONTACT RESISTANCE: 20mΩ max. initial @2-4VDC
 100mA, for both silver and gold plated contacts.
 INSULATION RESISTANCE: 1,000MΩ min.
 DIELECTRIC STRENGTH: 1500V RMS max. @ sea level.
 OPERATING TEMPERATURE: -30°C to +85°C.

MATERIALS:

CASE & BUSHING: PA9T or FR52, flame retardant, heat stabilized (UL 94V-0).
 ROCKER: PA46 (UL 94V-0) or ABS.
 ACTUATOR: Brass, chrome plated, internal o-ring sealed (400A).
 ACTUATOR: Brass, chrome plated (400C).
 SWITCH SUPPORT: Brass, tin plated.
 TERMINAL SEAL: Epoxy.

Specifications and Dimensions subject to change

If your preferred product configuration is not shown, please contact our sales representative for custom design.

HOW TO ORDER SYSTEM

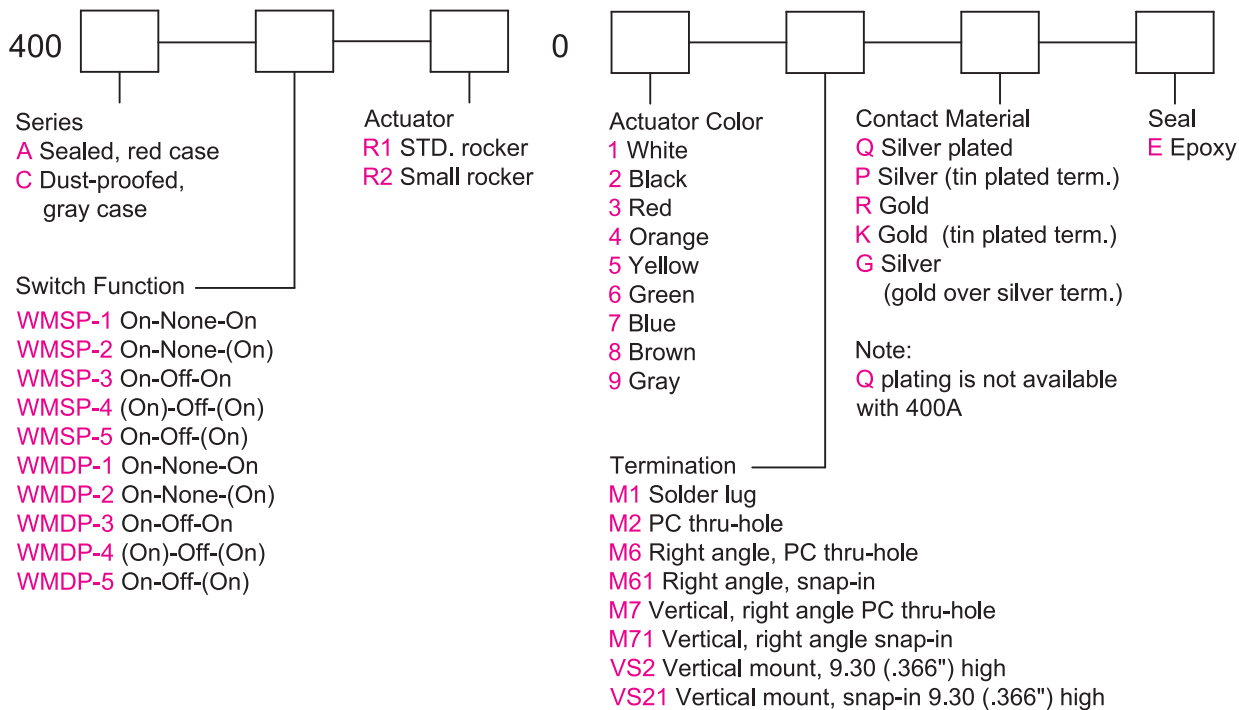

Series 400A/C

(Sealed) Sub-Miniature Rocker Switches

SPDT



Model No.	Switching Position		
WMSP-1	ON	NONE	ON
WMSP-2	ON	NONE	(ON)
WMSP-3	ON	OFF	ON
WMSP-4	(ON)	OFF	(ON)
WMSP-5	ON	OFF	(ON)
Term. Comm.	2-3	OPEN	2-1

Schematic 2Comm.
 1 3•

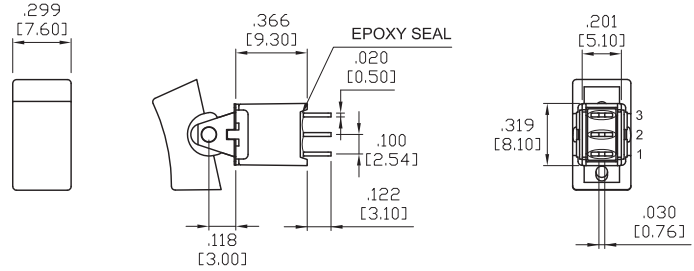

DPDT



Model No.	Switching Position		
WMDP-1	ON	NONE	ON
WMDP-2	ON	NONE	(ON)
WMDP-3	ON	OFF	ON
WMDP-4	(ON)	OFF	(ON)
WMDP-5	ON	OFF	(ON)
Term. Comm.	2-3,5-6	OPEN	2-1,5-4

Schematic 2Comm. 5Comm.
 1 3• 4 6•

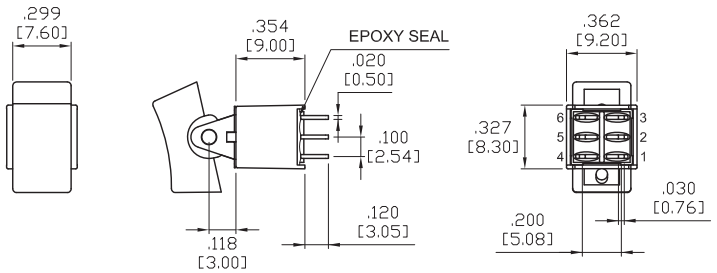

ACTUATOR OPTIONS

R1

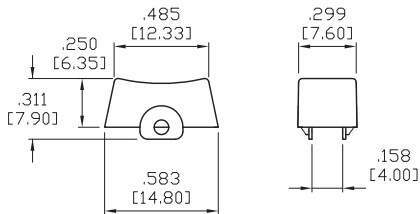

R2

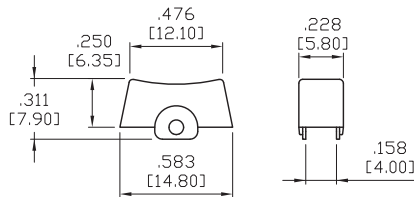

ACTUATOR COLORS	
1	White
2	Black (std.)
3	Red
4	Orange
5	Yellow
6	Green
7	Blue
8	Brown
9	Gray

TERMINATION OPTIONS

M1 STD. SOLDER LUG

SP

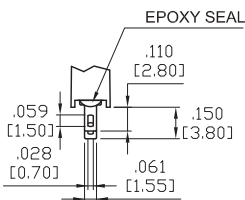

THK .020 [0.50]

DP

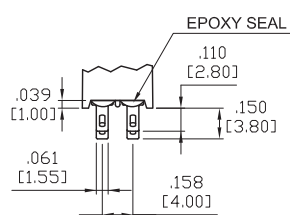

THK .020 [0.50]

M2 PC THRU-HOLE

SP

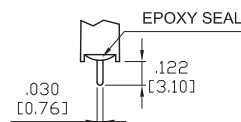

P.C.MOUNTING



DP

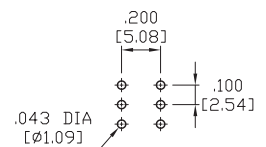
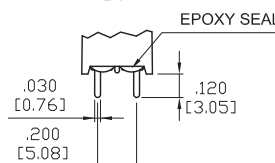

TERMINATION OPTIONS

M6

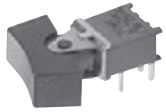

SPDT

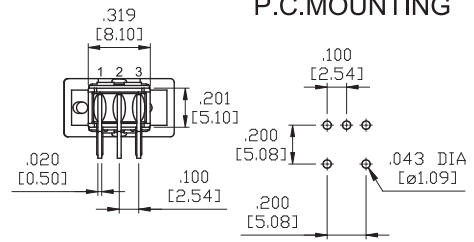
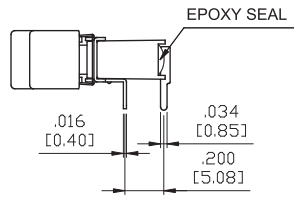
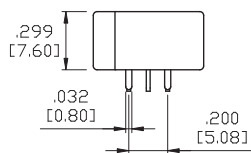

M6

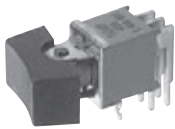

DPDT

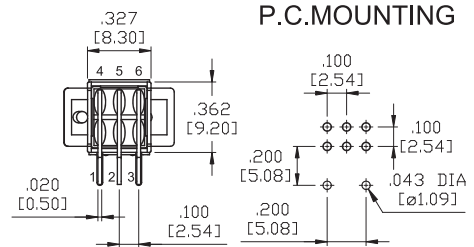
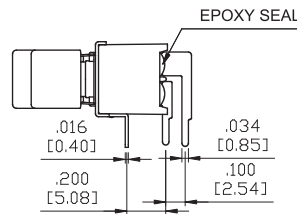
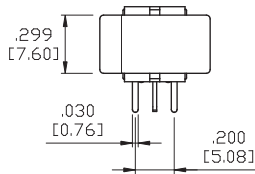

M7

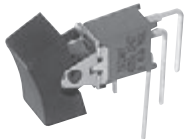

SPDT

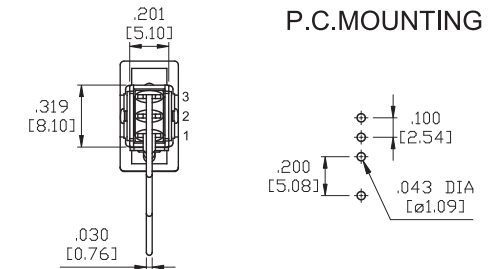
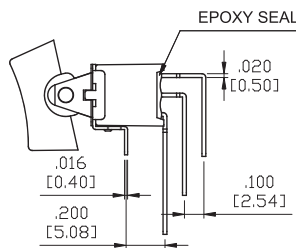
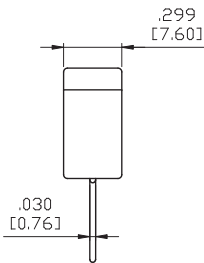

M7

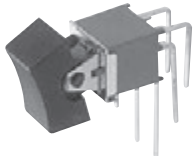

DPDT

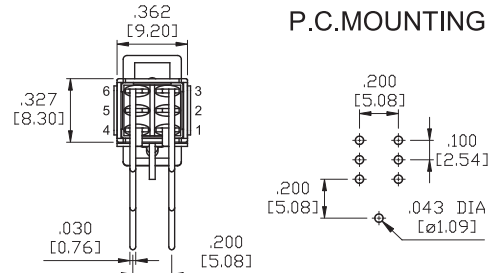
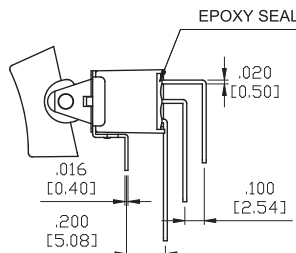
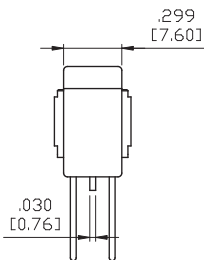

VS2



SPDT

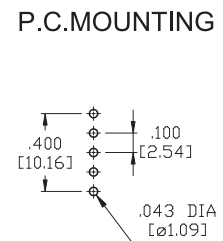
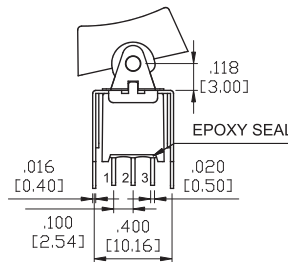
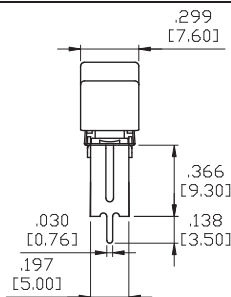

VS2



DPDT

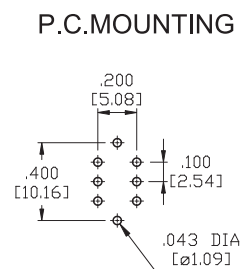
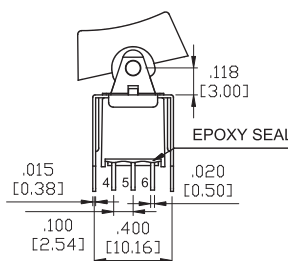
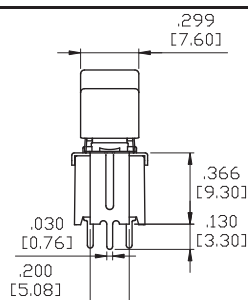

Toggle

Rocker

Slide

Pushbutton

AV

Rotary

Tact

Touch Key

Miscellaneous

SNAP-IN TERMINATION OPTIONS

M61

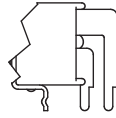
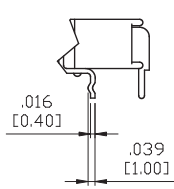

M71

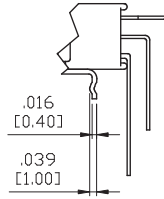

VS21

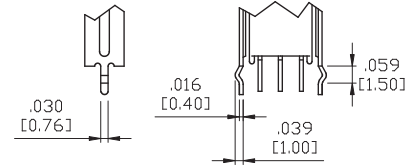

* PC Mounting for M61,M71,VS21 refer to M6,M7,VS2 respectively.

CONTACT MATERIAL OPTIONS

Coding	Contact Material	Terminal Plating	Rating	Agency Approvals
G	Silver ¹	Gold over silver ³	3Amps @ 125VAC or 28VDC 1.5Amps @ 250VAC	IP67
P		Tin plated ⁵ / ₇		
R	Gold ²	Gold plated ⁴	0.4VA max @ 20V max (AC or DC)	IP67
K		Tin plated ⁵ / ₆		

* Standard G plating for sealed product.

1. Movable Contact: Copper alloy, silver plated.
2. Movable Contact: Copper alloy with gold plated over nickel plated.
3. Terminals: Silver plated with outer layer in gold plating.
4. Terminals: Copper alloy, with gold plated over nickel plated.
5. Outer Terminals: Copper alloy with pure tin plated.
6. Terminal Contact: Gold plated over nickel plated.
7. Terminal Contact: Palladium nickel alloy (or Silver) plated.

* IP67 protection for series 400A only.