

Features

- Ultra-miniature, width-2.7mm, rating current load 0.1A~1A
- High precision spring plate construction to accomplish rapid switching, long life and excellent touch texture.
- Integrated moulding terminals structure preventing flux from not wicking.
- Multiple options of Plastic levers for use in the product structure design.
- Complied with ROHS requirements

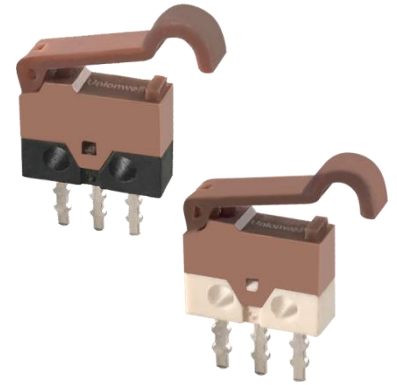

Ordering Instruction

G15E(Plastic Levers) Series Ultra-miniature Micro Switch:

G15E		Electrical Rating		Operating Force		Terminal Style		Lever Type		Base Color		Contact Material		Special Design Code		
Code	Electrical Rating	Code	Operating Force at pin Plunger	Code	Terminal Style	Graph	Code	Lever Type	Code	Base Color	Electrical Life	Mechanical Life	Code	Contact Material	Code	Special Designator
P1	DC30V 0.1A	60	60gf white base, no lever	P	Standard PCB Terminals		01		B	Black	20,000 cycles	20,000 cycles	Ag	Silver Alloy	T	Here means a special designator letter, Refer to products specification differences
01	DC15V 1A	110	110gf black base, no lever	D	Long PCB Terminals		02		W	White	20,000 cycles	300,000 cycles	Au	Gold Plated		
		30	30gf black base, with lever	L	Left Side PCB Terminals											
		15	15gf white base, with lever	R	Right Side PCB Terminals											

Model No.

Electrical Rating	0.1A				1A			
	Standard PCB Terminals	Left Side PCB Terminals	Right Side PCB Terminals	Long PCB Terminals	Standard PCB Terminals	Left Side PCB Terminals	Right Side PCB Terminals	Long PCB Terminals
Lever Type								
	G15E-01P	G15E-01CL	G15E-01CR	G15E-01PL	G15E-1-01P	G15E-1-01CL	G15E-1-01CR	G15E-1-01PL
	G15E-02P	G15E-02CL	G15E-02CR	G15E-02PL	G15E-1-02P	G15E-1-02CL	G15E-1-02CR	G15E-1-02PL

Circuit

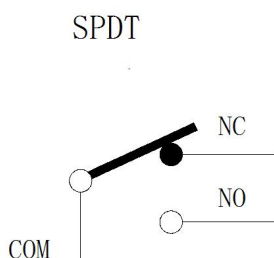

Contacts Specification

Item	Model	1A Series	0.1A Series
Contact	Specification	Contact	
	Materials	Gold Plated	Silver Alloy
	Space	0.35mm	
Min Electrical Rating (Reference Value)		DC5V 5mA	DC5V 50mA

Rating

Model No.	1A Series	0.1A Series
Load Type	Resistive Load	
Electrical Rating	DC15V 1A	DC30V 0.1A

Note: The above rating value under the test of following setting parameters

- (1) Storage Temperature: 20±2°C
- (2) Storage Humidity : 65±5%RH
- (3) Operating Frequency: 20 cycles/min

Parameters

Series No.	G15EP1		G15E01
Operating Force	60gf Max.		
Contacts	Silver Alloy	Gold Plated	
Electrical Rating	0.1A DC30V		1A DC15V
Contact Resistance(Initial value)	100mΩ Max		
Operating Frequency	Mechanical: 60 cycles max Electrical: 20 cycles max		
Insulation Resistance	100MΩ Min (DC 500V)		
Voltage Resistance	AC250V 50/60Hz 1min		
Mechanical Life	20,000 cycles	300,000 cycles	300,000 cycles
Electrical Life	20,000 cycles	300,000 cycles	10,000 cycles
Storage Humidity	85%RH Max at +40°C		
Operating Temperature Range	-40~+85°C		
Solder Ability	255±5°C 5s		
Protection Type	IP40		
Unit Net Weight	Approx 0.3g		

Note: Mechanical life simulation test under 150gf operating force

Switch Terminals Types (unit: mm)

● Standard PCB Terminals(Type P)

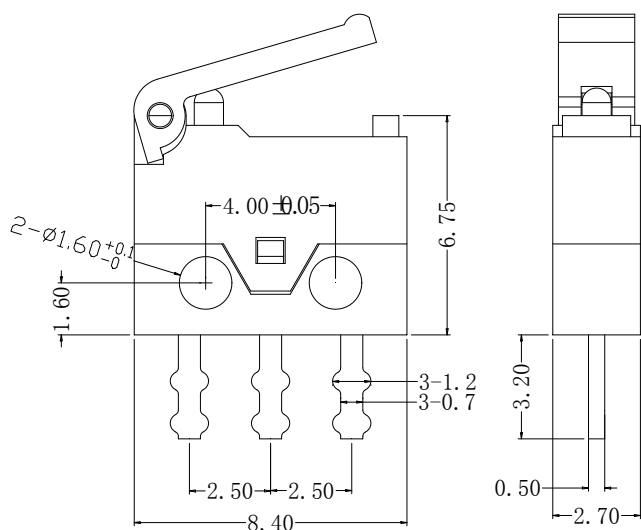

● Long PCB Terminals (Type D)

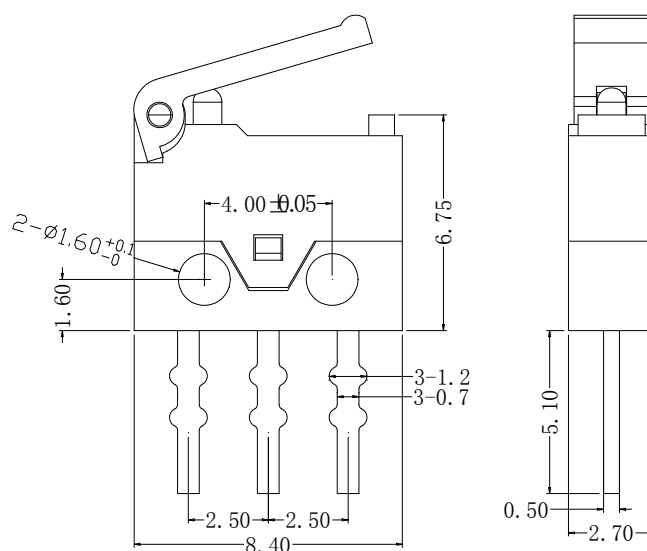

● Left Side PCB Terminals (Type L)

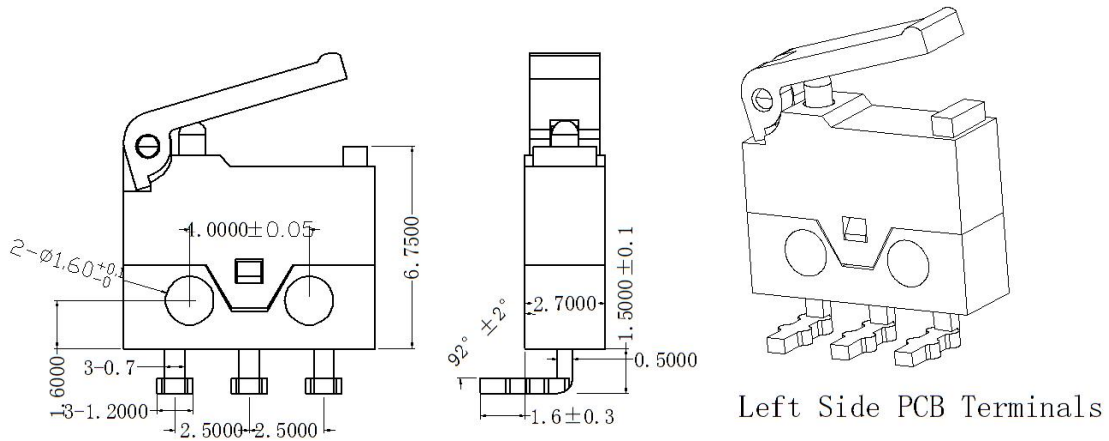

● Right Side PCB Terminals (Type R)

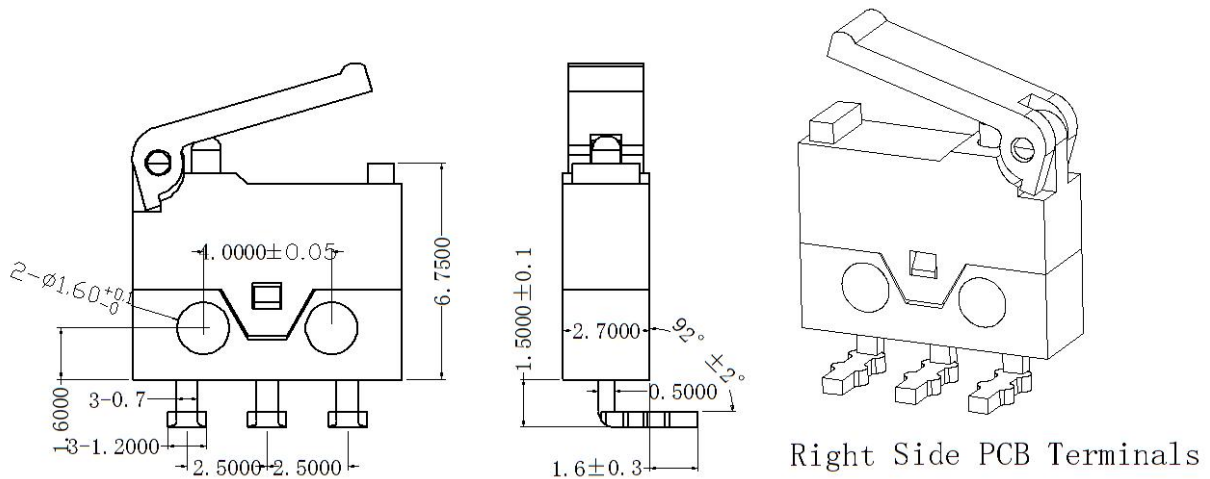

■ Mounting Holes Dimensions (mm)

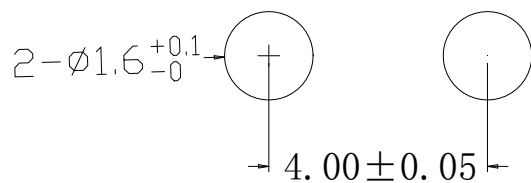

■ Dimensions (mm) And Operating Parameters

● 01# Hinge Lever

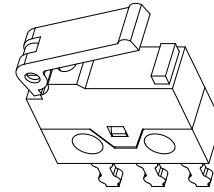
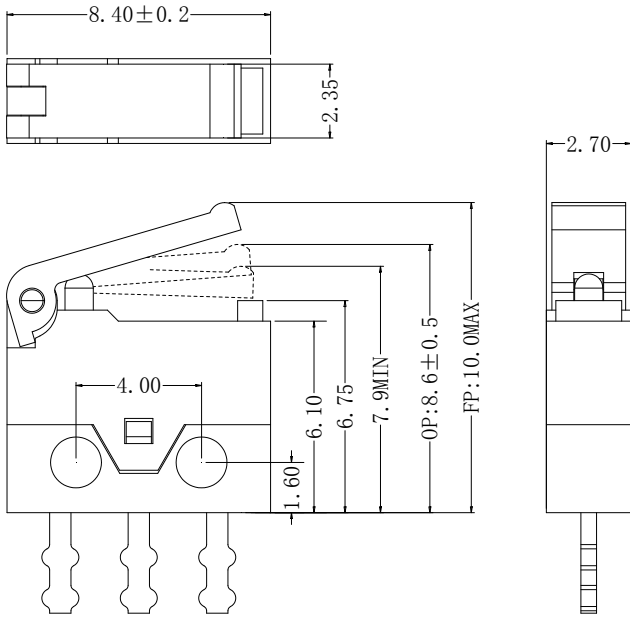

Operating Force (OF)	50gf Max	
Release Force (RF)	5gf Min	
Pre-travel (PT)	1.3 Max	
Over-travel (OT)	0.7 Max	
Movement-Differential (MD)	0.3 Max	
Free Position (FP)	10.0 Max	
Operating Position (OP)	8.6 ± 0.5	
Mechanical Life	20,000 cycles	300,000 cycles
	1A	10,000 cycles
	0.5A	20,000 cycles
Electrical Life	0.1A	30,000 cycles

● 02# Simulated Roller Lever

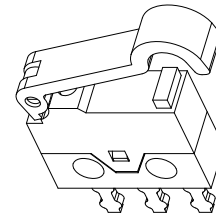
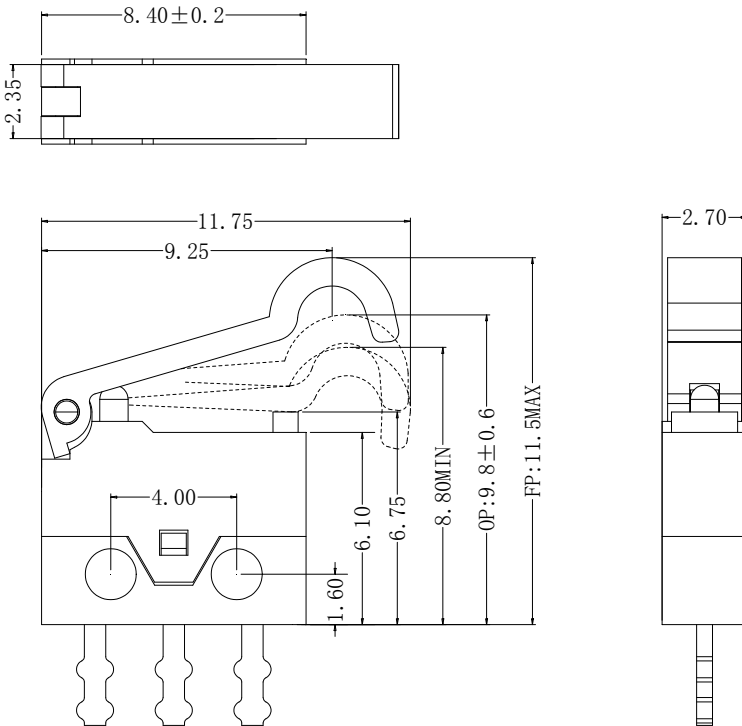

Operating Force (OF)	50gf Max	
Release Force (RF)	5gf Min	
Pre-travel (PT)	1.8 Max	
Over-travel (OT)	1.0 Max	
Movement-Differential (MD)	0.5 Max	
Free Position (FP)	11.5 Max	
Operating Position (OP)	9.8 ± 0.5	
Mechanical Life	20,000 cycles	300,000 cycles
	1A	10,000 cycles
	0.5A	20,000 cycles
Electrical Life	0.1A	30,000 cycles