

GQ series

Have installation aperture Φ 22mm, Φ 25mm, Φ 28mm, Φ 30mm, Φ 40mm.

- ☆ The switch is "fast action | SPDT/DPDT";
- ☆ The appearance of the product is elegant and fashionable, the configuration is rich and diverse, and the performance is stable and reliable.
The self-locking device of this series is of "gear bite" structure, and the self-locking performance is very reliable;
- ☆ The waterproof grade of the product is IP65/IP67.



GQ series model description

GQ - $\diamond/\triangle/\blacktriangle/\bigcirc$

Symbol	Symbol name	Specify
	Mounting hole diameter	22: 22mm / 25: 25mm / 28: 28mm / 30: 30mm / 40: 40mm
	Contact Structure	11 :1NO1NC / 22 :2NO2NC / No digital means indicator
	Operation type	Z: Latching / M: Mushroom button / No letter means momentary
\diamond	Illuminated Type	D \odot Dot illuminated / E \odot Ring illuminated / ET \odot Ring+power symbol illuminated / No letters mean no lights
	Color	R: Red / G: Green / Y: Yellow / B: Blue / W: White
	Voltage	6V / 12V / 24V / 110V / 220V other voltage levels can be customized.
	Housing Material	S: Stainless steel / A: Aluminium alloy (Black)

Note: Please read the catalog carefully, and choose the right part-number according to the sign.

Switch Rating

Rated Insulation Voltage U_i		250V				
Thermal Current I_{th}		5A				
Rated voltage		12V	24V	110V	220V	
Rated Operation Current	AC 50/60Hz	Resistive load	—	—	5A	3A
		Inductive load	—	—	3A	2A
	DC	Resistive load	5A	5A	1A	0.5A
		Inductive load	2A	2A	0.2A	0.1A
Contact material		Silver Alloy				

Minimum load: 3V AC/DC, 5mA (Reference)

Application scope depends on operating environment and load type.

Performance Characteristic

Operating Temp	-25°C~+55°C (Non freezing) Keep the switch air circulating well
Operating Humidity	45~85% RH(Non condensing)
Contact Resistance	50m
Insulation Resistance	100M (500VDC)
Max. withstanding voltage	1500VAC, 50Hz, 1min
Vibration resistance	50Hz, The amplitude is about 1.2mm
Solder heat resistance	320 3s
Switch rating	2A/220VAC
Mechanical Life	1,000,000 cycles
Electrical Life	50,000 cycles
Base material	PA
Nut torque	About 0.6Nm
Torque	About 4N(1NO1NC)
	About 7.5N(2NO2NC)
Operation Travel	About 2.5mm
Protection class	IP65 (momentary IP67 can be customized)IK10

Standards and certification

Corresponding standard	Certification mark	Certification authority / certification number
GB/T 14048.5-2017		2020970305003358
GB/T 14048.5-2017		2020970305003358
EN61058-1:2018		UDEM M 2021 206 C62197

Switch structure description

Type	Diagram	Symbol
Za		

LED Specifications

LED life	Current	Allowable voltage fluctuation range	Circuit diagram
≥ 40000 hours	$\leq 24V$ about 15mA $\geq 110V$ about 2mA	DC: $\pm 10\%$ AC: $\pm 20\%$	 <small>The product has built-in protective resistance, and the lamp bead wiring has no distinction between positive and negative poles.</small>

Pin Description

GQ22	GQ25, GQ28, GQ30
1, 2, 3 and 4 are a group of switches; 1, 2 is normally closed contact NC, 3 and 4 are normally open contact NO. There is no difference between positive and negative poles for the lamp beads in the conventional configuration. The lamp bead is relatively independent of the switch, and the lamp bead status can be controlled by the switch or peripheral circuit.	

GQ22

Super flat head can be customized



GQ22-11 ■ / S

Contact Structure 11: 1NO1NC
 Operation type ■ Z: Latching / No letter means momentary
 Housing Material S: Stainless steel
 Protection class IP65(momentary IP67can be customized),IK10
 Applicable accessories Sealing cover M12-22F / Protection cover T21-22 / Solder socket M11 / PCB socket M11-A / Quick connect socket M22

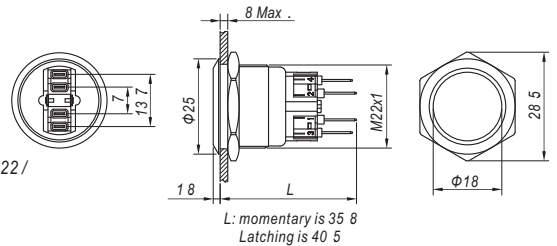

Super flat head can be customized



GQ22-11 ■ D / Δ / ▲ / S

Contact Structure 11: 1NO1NC
 Operation type ■ Z: Latching / No letter means momentary
 Color R G Y B W
 Voltage 6V/12V/24V/110V/220V
 Housing Material S: Stainless steel
 Protection class IP65(momentary IP67can be customized),IK10
 Applicable accessories Sealing cover M12-22F / Protection cover T21-22 / Solder socket M11 / PCB socket M11-A / Quick connect socket M22

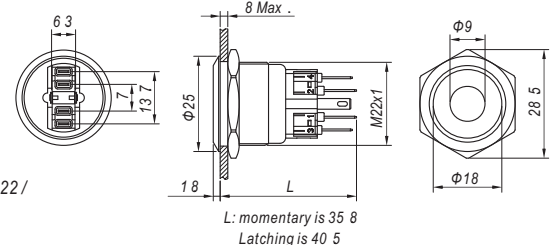

Super flat head can be customized



GQ22-11 ■ E / Δ / ▲ / ○

Contact Structure 11: 1NO1NC
 Operation type ■ Z: Latching / No letter means momentary
 Color R G Y B W
 Voltage 6V/12V/24V/110V/220V
 Housing Material S: Stainless steel / A: Aluminium alloy (Black)
 Protection class IP65(momentary IP67can be customized),IK10
 Applicable accessories Sealing cover M12-22F / Protection cover T21-22 / Solder socket M11 / PCB socket M11-A / Quick connect socket M22

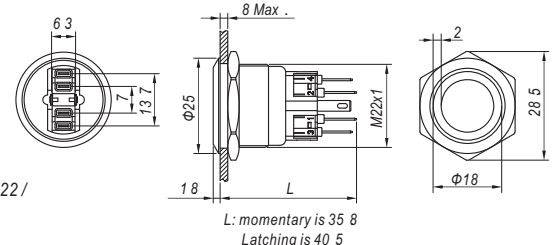

Super flat head can be customized



GQ22-11 ■ ET / Δ / ▲ / S

Contact Structure 11: 1NO1NC
 Operation type ■ Z: Latching / No letter means momentary
 Color R G Y B W
 Voltage 6V/12V/24V/110V/220V
 Housing Material S: Stainless steel
 Protection class IP65(momentary IP67can be customized),IK10
 Applicable accessories Sealing cover M12-22F / Protection cover T21-22 / Solder socket M11 / PCB socket M11-A / Quick connect socket M22

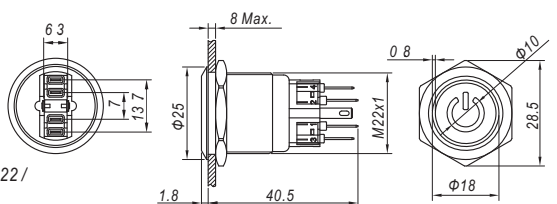

Super flat head can be customized



GQ22-11 E / Δ / ▲ / PC

Contact Structure 11: 1NO1NC
 Color R G Y B W
 Voltage 6V/12V/24V/110V/220V
 Housing Material PC: engineering plastic
 Protection class IP65(momentary IP67can be customized),IK10
 Applicable accessories Sealing cover M12-22F / Protection cover T21-22 / Solder socket M11 / PCB socket M11-A / Quick connect socket M22

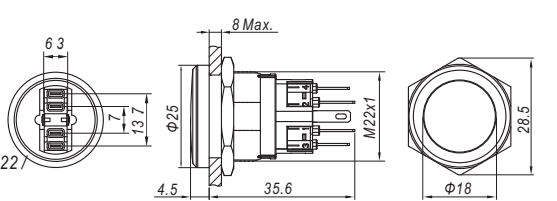

Super flat head can be customized



GQ22-11 ■ M

Contact Structure 11: 1NO1NC
 Operation type ■ Z: Latching / No letter means momentary
 Housing Material aluminium alloy
 Protection class IP65(momentary IP67can be customized),IK10
 Applicable accessories Sealing cover M12-22F / Solder socket M11 / PCB socket M11-A / Quick connect socket M22

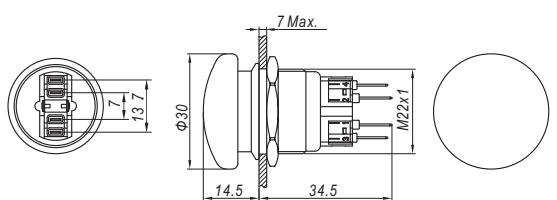

GQ25,28



GQ25-□■/S

Contact Structure □ 11: 1NO1NC 22 :2NO2NC
 Operation type ■ Z: Latching / No letter means momentary
 Housing Material S: Stainless steel
 Protection class IP65(momentary IP67can be customized),IK10
 Applicable accessories Sealing cover M12-25F / Quick connect socket M23

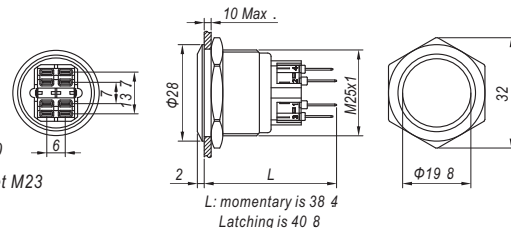

L: momentary is 38.4
 Latching is 40.8



GQ25-□■D/▲/S

Contact Structure 11: 1NO1NC 22 :2NO2NC
 Operation type ■ Z: Latching / No letter means momentary
 Color R G Y B W
 Voltage 6V/12V/24V/110V/220V
 Housing Material S: Stainless steel
 Protection class IP65(momentary IP67can be customized),IK10
 Applicable accessories Sealing cover M12-25F / Quick connect socket M23

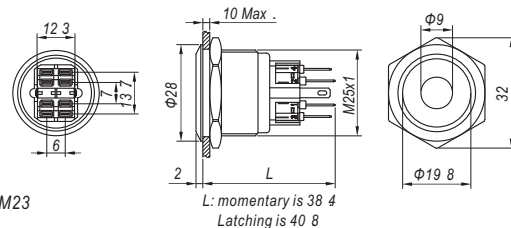

L: momentary is 38.4
 Latching is 40.8



GQ25-□■E/▲/S

Contact Structure 11: 1NO1NC 22 :2NO2NC
 Operation type ■ Z: Latching / No letter means momentary
 Color R G Y B W
 Voltage 6V/12V/24V/110V/220V
 Housing Material © S: Stainless steel / A: Aluminium alloy (Black)
 Protection class IP65(momentary IP67can be customized),IK10
 Applicable accessories Sealing cover M12-25F / Quick connect socket M23

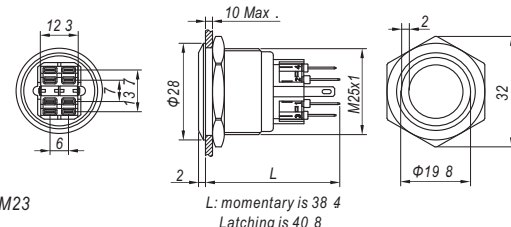

L: momentary is 38.4
 Latching is 40.8



GQ25-□■ET/▲/S

Contact Structure 11: 1NO1NC 22 :2NO2NC
 Operation type ■ Z: Latching / No letter means momentary
 Color R G Y B W
 Voltage 6V/12V/24V/110V/220V
 Housing Material S: Stainless steel
 Protection class IP65(momentary IP67can be customized),IK10
 Applicable accessories Sealing cover M12-25F / Quick connect socket M23

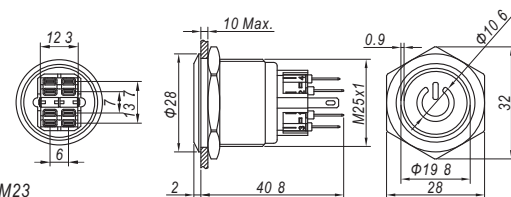

L: momentary is 38.4
 Latching is 40.8



GQ28-□■/S

Contact Structure □ 11: 1NO1NC 22 :2NO2NC
 Operation type ■ Z: Latching / No letter means momentary
 Housing Material S: Stainless steel
 Protection class IP65(momentary IP67can be customized),IK10

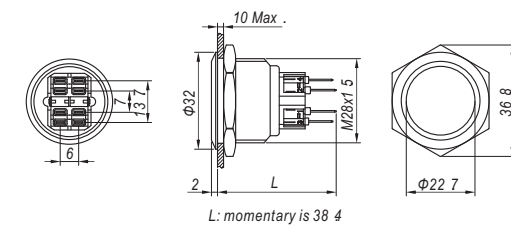

L: momentary is 38.4
 Latching is 40.8



GQ28-□■D/▲/S

Contact Structure 11: 1NO1NC 22 :2NO2NC
 Operation type ■ Z: Latching / No letter means momentary
 Color R G Y B W
 Voltage 6V/12V/24V/110V/220V
 Housing Material S: Stainless steel
 Protection class IP65(momentary IP67can be customized),IK10

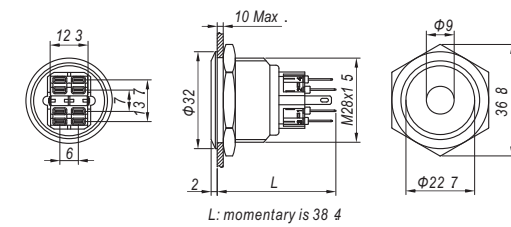

L: momentary is 38.4
 Latching is 40.8



Sealing cover
M12-25F



Quick connect socket
M23



Panel plug
M04

Φ25

GQ28,30,40



Contact Structure 11: 1NO1NC / 22 :2NO2NC
Operation type ■ Z: Latching / No letter means momentary
Color R G Y B W
Voltage 6V/12V/24V/110V/220V
Housing Material S: Stainless steel
Protection class IP65(momentary IP67can be customized),IK10

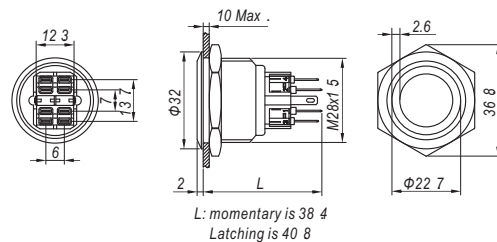

Contact Structure □ 11: 1NO1NC / 22 :2NO2NC
Operation type ■ Z: Latching / No letter means momentary
Housing Material S: Stainless steel
Protection class IP65(momentary IP67can be customized),IK10

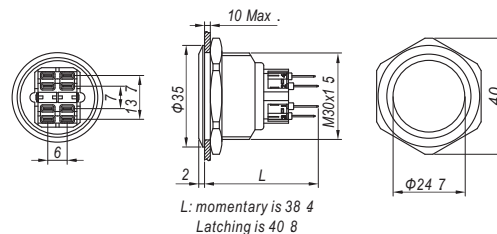

Contact Structure 11: 1NO1NC / 22 :2NO2NC
Operation type ■ Z: Latching / No letter means momentary
Color R G Y B W
Voltage 6V/12V/24V/110V/220V
Housing Material S: Stainless steel
Protection class IP65(momentary IP67can be customized),IK10

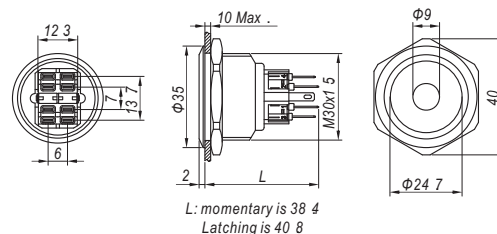

Contact Structure 11: 1NO1NC / 22 :2NO2NC
Operation type ■ Z: Latching / No letter means momentary
Color R G Y B W
Voltage 6V/12V/24V/110V/220V
Housing Material S: Stainless steel
Protection class IP65(momentary IP67can be customized),IK10

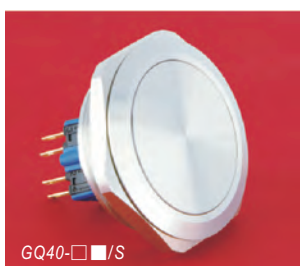
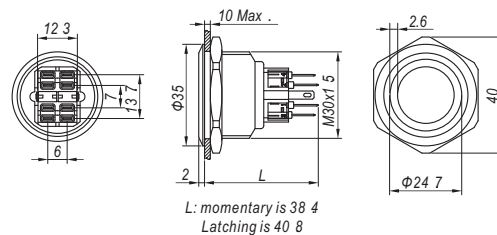

Contact Structure □ 11: 1NO1NC / 22 :2NO2NC
Operation type ■ Z: Latching / No letter means momentary
Housing Material S: Stainless steel
Protection class IP65(momentary IP67can be customized),IK10

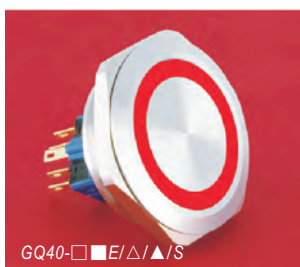
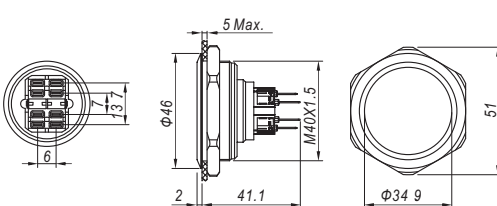

Contact Structure 11: 1NO1NC / 22 :2NO2NC
Operation type ■ Z: Latching / No letter means momentary
Color R G Y B W
Voltage 6V/12V/24V/110V/220V
Housing Material S: Stainless steel
Protection class IP65(momentary IP67can be customized),IK10

