

# ROTARY DIP SWITCH 10x10 Size, Height: 4.5mm, 4x1 Terminal

NEW

H  
HA  
Series



## General Specification

- 1. Rating :** 25mA, 12V DC (Switching)  
25mA, 24V DC (None-Switching)
- 2. Contact Resistance :** 100mΩ Max.
- 3. Insulation Resistance :** 100MΩ Min at DC 250V
- 4. Operating Force :** 700gf Max.
- 5. Life Cycle :** 10,000 steps
- 6. Sealing :** IP67 (Dust & Water proof)

## GENERAL DIMENSION

### Through Hole Type Layout

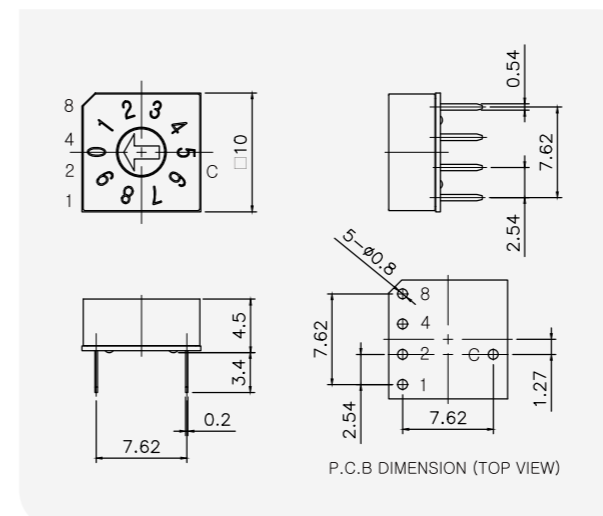

### SMD Gull Wing Type Layout

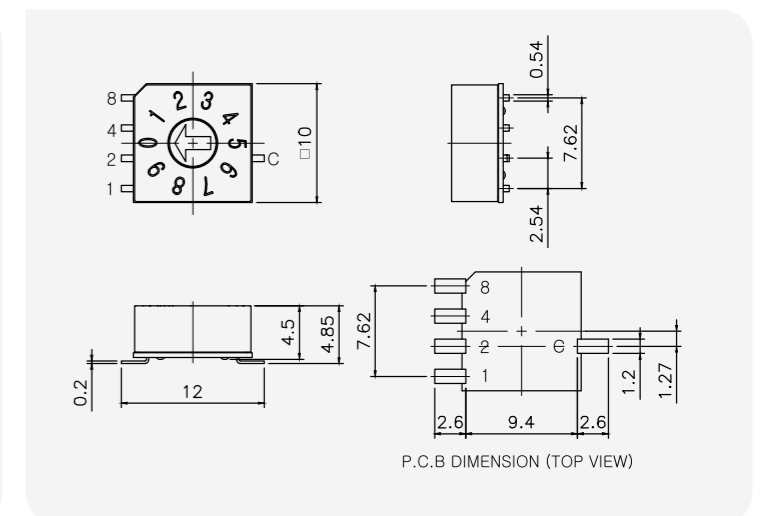

### Climped Type Layout

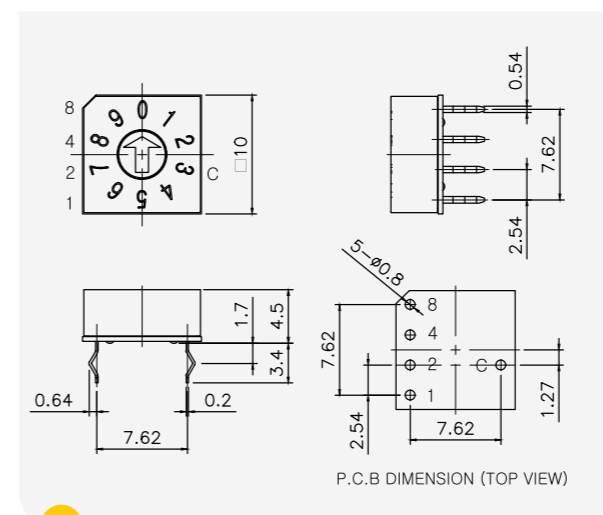

# ROTARY DIP SWITCH 10x10 Size, Height : 4.5mm, 4x1 Terminal

## HOW TO ORDER

<b>H</b>	<b>D</b>	<b>R</b>	<b>10</b>	<b>S</b>	<b>TR</b>
<b>Cover Type</b>	<b>Actuator</b>	<b>Code</b>	<b>Position</b>	<b>Terminal</b>	<b>Packing</b>
<b>H</b> Square (Ter' 4x1) Position of Number 0 = 0° <b>HA</b> Square (Ter' 4x1) Position of Number 0 = -90°	<b>D</b> Arrow (Height = 0mm) <b>E</b> Cross (Height = 0mm) <b>M</b> Slotted spindle (Height = 3.2mm) <b>S</b> Slotted spindle (Height = 7.3mm)	<b>R</b> Real Code <b>C</b> Complement Code <b>G</b> Gray Code  *Other special codes are available upon the request.	<b>04</b> 4 Position <b>06</b> 6 Position <b>08</b> 8 Position <b>10</b> 10 Position <b>16</b> 16 Position	<b>-</b> Through-Hole (Ter' 4x1) <b>S</b> SMD Gull Wing (Ter' 4x1) <b>K</b> Crimped	<b>-</b> Tube Packing <b>TR</b> Reel Packing

## 1. Cover Type

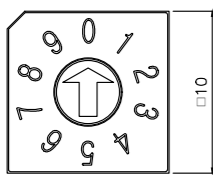

H Type

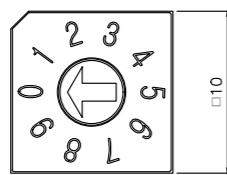

HA Type

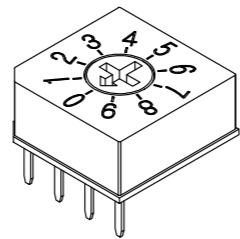

## 2. Actuator

### D Arrow (Height = 0mm)

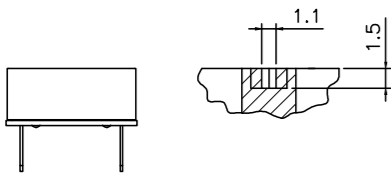
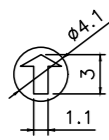
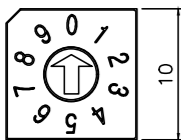

### E Cross (Height = 0mm)

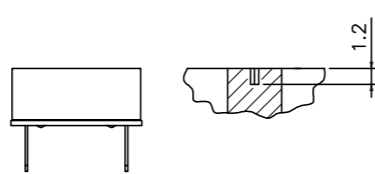
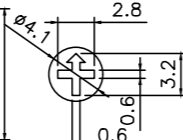
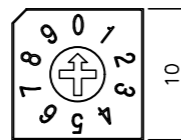

### M Slotted Spindle (Height = 3.2mm)

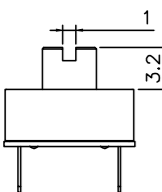
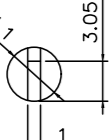
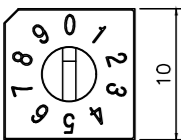

### S Slotted spindle (Height = 7.3mm)

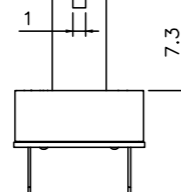
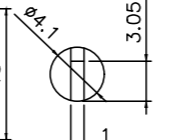
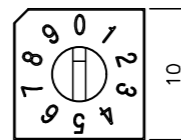

# ROTARY DIP SWITCH 10x10 Size, Height: 4.5mm, 4x1 Terminal

## 3. Code & Position

### R Real Code

16 Position	10 Position	08 Position	06 Position	04 Position	Real Code
					C 1 2 4 8
0					0
1					1
2					2
3					3
4					4
5					5
6					6
7					7
8					8
9					9
10					A
11					B
12					C
13					D
14					E
15					F

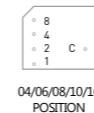

### C Complement Code

16 Position	10 Position	08 Position	06 Position	04 Position	Complement Code
					C 1 2 4 8
0					1
1					2
2					3
3					4
4					5
5					6
6					7
7					8
8					9
9					A
10					B
11					C
12					D
13					E
14					F
15					

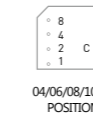

### S Decimal Code

04 Position	Decimal Code
	C 1 2 3 4
1	1
2	2
3	3
4	4

\* Special Codes are available upon the request.

## 4. Terminal

### - Through-Hole (Ter' 4x1)

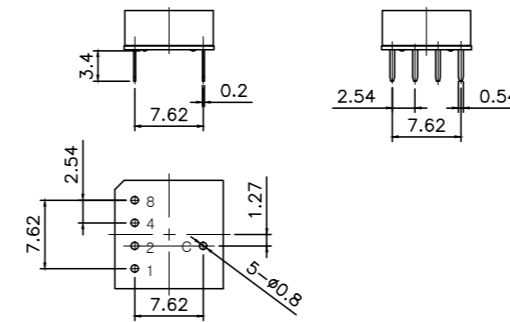

P.C.B DIMENSION (TOP VIEW)

### S SMD Type (Ter' 4x1)

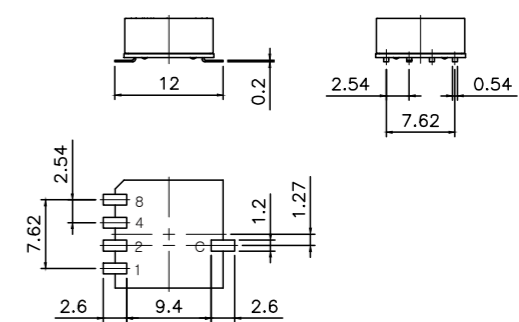

P.C.B DIMENSION (TOP VIEW)

### K Crimped (Ter' 4x1)

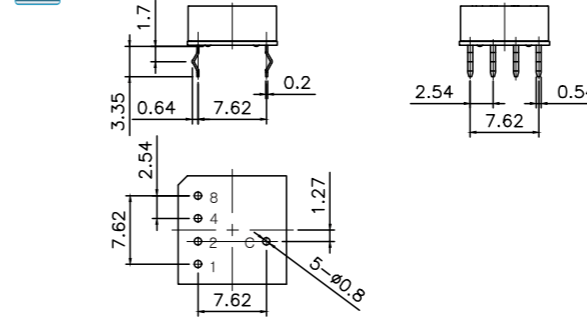

P.C.B DIMENSION (TOP VIEW)

## 5. Packing

### - Tube Packing (Q'ty: 50Pcs/Tube)

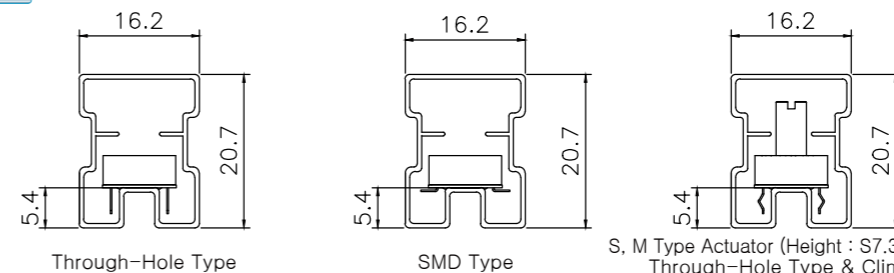

### TR Tape Reel Packing

Apply to only SMD types  
(See Page 31)