

R-4 SERIES ROCKER SWITCHES



R-4-210-C5N-BB



R-4-210-F5N-BB



R-4-230-C0N-BB



R-4-210-C5L-BR



R-4-210-C5L-BG+防水帽

SPECIFICATIONS

Rating	:20A 125V AC(UL CUL) 22A 250V AC(ENEC CB CQC)
Contact Resistance	:50mΩ Max
Insulation Resistance	:DC 500V 100MΩ Min
Dielectric Strength	::AC 1500V 1 minute
Operating Force	:350±150gf
Mechanical Life	:Over 30,000cycles
Electrcal Life	:Over10,000 Cycles
Operating Temperature	::-20°C~ +85°C
Safety Approval	UL US CE CCC

	X	Y
0.75~1.25	28.0+0.10	22.0+0.10
1.25~2.00	28.2+0.10	22.0+0.10
2.00~3.00	28.4+0.10	22.0+0.10

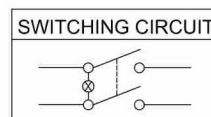
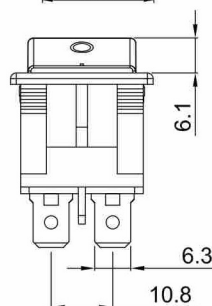
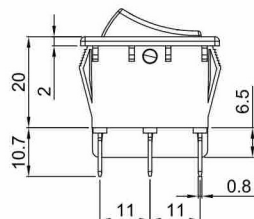
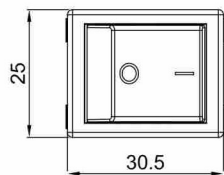
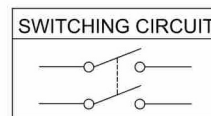
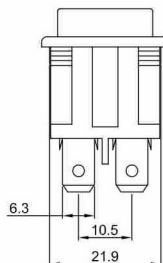
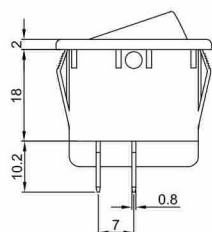
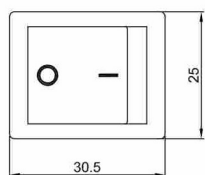
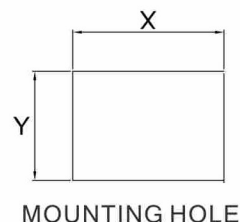

R-4 2 1 0 C 5 N B B - 110

Model 型号	Function 功能	Terminal type 端子种类	Actuator shape 柄形状	Marking 印字	Illuminated 带灯指示	Body color 底座颜色	Actuator color 柄颜色	Current Rating 电流	Light Voltage 灯电压
21	ON-OFF 4P	0	C	0 None	N None 不带灯	B Black 黑色	B Black 黑色	- 16A	- None
22	ON-ON 6P	0	C	1 •	L Neon 氖灯	A Gray 灰色	R Red 红色	BB 20A	110 110V
23	ON-OFF-ON 6P	1	F	2 OFF	E LED	W White 白色	G Green 绿色		220 220V
24	OFF -(ON) 4P	1	F	3 ON			Y Yellow 黄色		
25	ON-(OFF) 4P	1	F	4 ON			U Blue 蓝色		
26	(ON)-ON 6P	2	F	5 ON-OFF			W White 白色		
				6 ON-OFF			O Orange 桔色		
				7 Front					
				8 Back					

R-2 SERIES ROCKER SWITCHES



R-2-110-C0N-BB



R-2-110-C2L-BG



R-2-110-D5N-BG



R-2-110-D5N-BR



二合一开关 2 in1 switch
开关+过载保护

SPECIFICATIONS

Rating :20A 125V AC (UL CUL)
:22A 250V AC (ENEC CB CQC)

Contact Resistance :50mΩ Max

Insulation Resistance :DC 500V 100MΩ Min

Dielectric Strength :AC 1500V 1 minute

Electrical Life :600± 150gf

Operating Temperature :Over 10,000cycles;

Safety Approval :-20°C~ +85°C

Funtion



	X	Y
0.75~1.25	28.6-0.1	13.8+0.1
1.25~2.00	28.8-0.1	13.8+0.1
2.00~3.00	29.2-0.1	13.8+0.1

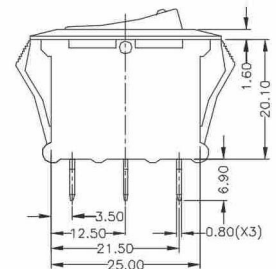
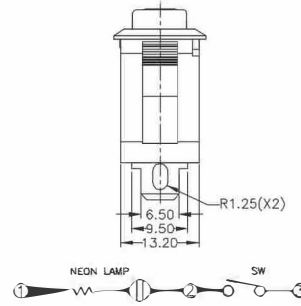
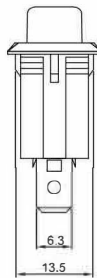
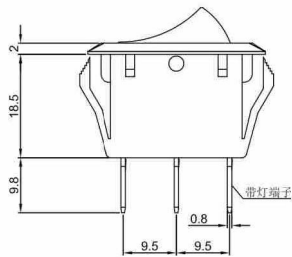
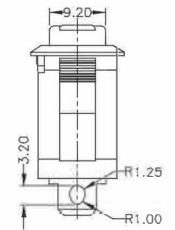
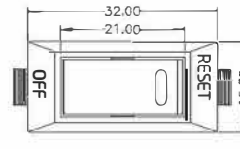
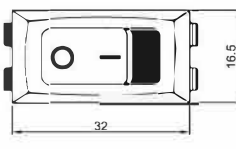
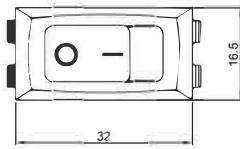
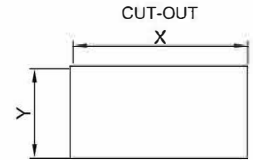

CIRCUIT DIAGRAM

Model 型号	Function 功能	Terminal type 端子种类	Actuator shape 柄形状	Marking 印字	Illuminated 带灯指示	Body color 基座颜色	Actuator color 柄颜色	Light Voltage 灯电压
R-2								
110								
11	ON-OFF	2P	C	0 None	N None 不带灯	B Black 黑色	B Black 黑色	None
12	ON-ON	3P	D	1	L Neon 氖灯	A Gray 灰色	R Red 红色	12 12V
13	ON-OFF-ON	3P		2	E LED	W White 白色	G Green 绿色	110 110V
				3			Y Yellow 黄色	220 220V
				4			U Blue 蓝色	
				5			W White 白色	
				6			BR Black/Red 双色	
				7			O Orange 桔色	
				8				

带灯轻触开关

带灯按钮开关

按钮开关

金属按钮开关

翘板开关

保险丝座

光电触摸开关

旋转开关



R-1-110-C5N-BB



R-1-130-C6N-BB



R-1-110-R0L-BR



R-1-110-C5L-WG



防水帽

SPECIFICATIONS

Rating :20A 125V AC (UL CUL)
22A 250V AC (ENEC CB CQC)

Contact Resistance :50mΩ Max

Insulation Resistance :DC 500V 100MΩ Min

Dielectric Strength :AC 1500V 1 minute

Electrical Life :600±150gf

Operating Temperature :Over 10,000cycles;

Safety Approval :-20°C ~ +85°C

Function



	X	Y
0.75~1.25	30.0±0.1	11.0±0.1
1.25~2.00	30.2±0.1	11.0±0.1
2.00~3.00	30.4±0.1	11.0±0.1

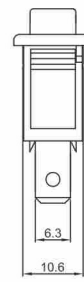
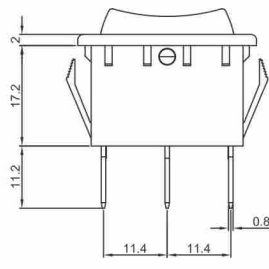
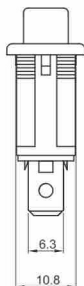
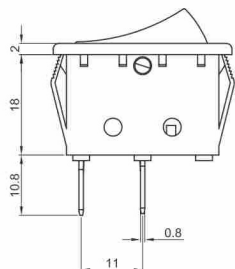
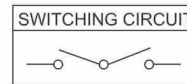
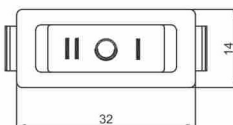
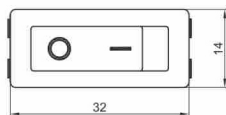
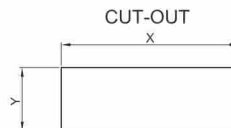

Model 型号	Function 功能	Terminal type 端子种类	Actuator shape 柄形状	Marking 印字	Illuminated 带灯指示	Body color 底座颜色	Actuator color 柄颜色	Current Rating 电流	Light Voltage 灯电压
R-1									
1 1 0									
C 5 N									
B B -									
110									
11	ON-OFF	2P	C	0	N	B	B	-	None
12	ON-ON	3P	F	1	L	A	R	16A	12V
13	ON-OFF-ON	3P	R	2	W	W	G	20A	110V
14	OFF-(ON)	2P		3			Y		220V
15	ON-(OFF)	2P		4			A		
16	(ON)-OFF-(ON)	3P		5			U		
17	(ON)-OFF-ON	3P		6			W		
18	(ON)-ON	3P		7	D		T		
				8	E				
				9	F				
				A	+SPEED				
				B	I O I				
				C	关开				

带灯轻触开关

带灯按钮开关

按钮开关

金属按钮开关

翘板开关

保险丝座

光电触摸开关

旋转开关

R SERIES ROCKER SWITCHES



R-210-C5N-BB



R-210-C5L-BG



R-230-C6N-BB



R-210-D0L-BR



R-210-D5L-BB+防水帽

SPECIFICATIONS

Rating	:20A 125V AC (UL CUL) 22A 250V AC (ENEC CB CQC)
Contact Resistance	:50mΩ Max
Insulation Resistance	:DC 500V 100MΩ Min
Dielectric Strength	:AC 1500V 1 minute
Electrical Life	:600±150gf
Operating Temperature	:Over 10,000cycles;
Safety Approval	:-20°C~+85°C
Function	

CUT-OUT

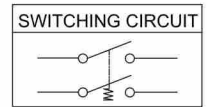
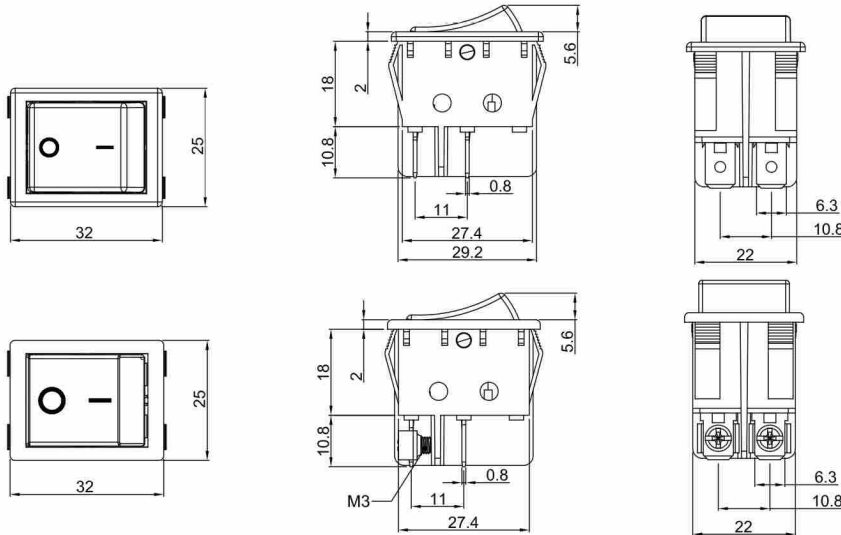
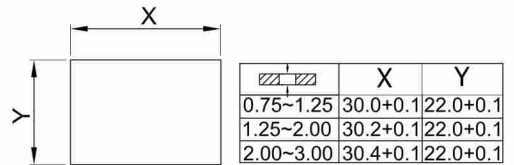

Model 型号	Function 功能	Terminal type 端子种类	Actuator shape 柄形状	Marking 印字	Illuminated 带灯指示	Body color 底座颜色	Actuator color 柄颜色	Current Rating 电流	Light Voltage 灯电压
R-210-C5N-BB-110	21 ON-OFF 4P	0	C	0 None	N None 不带灯	B Black 黑色	B Black 黑色	- 16A	None
	22 ON-ON 6P	1	R	1	L Neon 氖灯	A Gray 灰色	R Red 红色	BB 20A	12 12V
	23 ON-OFF-ON 6P	3	D	2	E LED	W White 白色	G Green 绿色		110 110V
	24 OFF-(ON) 4P		DR	3			Y Yellow 黄色		220 220V
	25 ON-(OFF) 4P		F	4			U Blue 蓝色		
	26 (ON)-ON 6P		H	5			W White 白色		
	27 (ON)-OFF-(ON) 6P		P	6			O Orange 桔色		
	28 (ON)-OFF-ON 6P		B	7			T Transparency 透明		
			W	8					
			S	9					

带灯轻触开关

带灯按钮开关

按钮开关

金属按钮开关

翘板开关

保险丝座

光电触摸开关

旋转开关

R SERIES ROCKER SWITCHES



R-210-W5L-BR



R-210-B5L-BR



R-210-S5L-BG



R-210-F5N-WW



R-210-H0N-BB

