

# TS12 SERIES LED TACT SWITCHES

带灯轻触开关



TS12-1G1-G-4A-S



TS12-1W1-W-P



## SPECIFICATIONS

Circuit	:SPST
Current Rating	:50mA
Voltage Rating	:12VDC
Dielectric withstanding voltage	:250VAC for 1 minute
Contact Resistance	:100mΩ Max .(initial)
Insulation Resistance	:100MΩ Min.
Operating Force	:250±50gf
Total Travel	:0.4±0.15mm
Operating life	:500,000 Cycles Min
Solder Specifications	:260°C for 5 Seconds
Function	:Momentary
Operating Temperature	:-20°C~ +70°C



TS12-1R2-R-1A-S



TS12-1W1-U-Q2A-S

带灯按钮开关

按钮开关

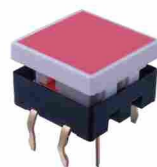

TS12-1R0-R-S

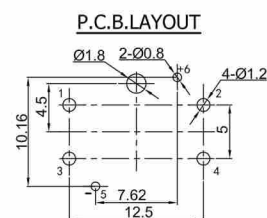
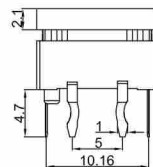
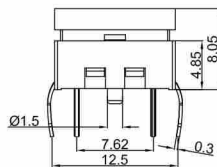
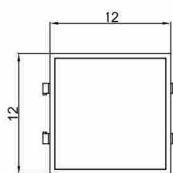

金属按钮开关



TS12-1G1-G-6A-S

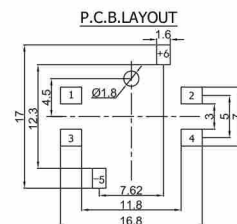
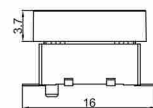
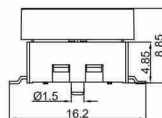
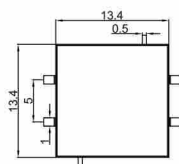

翘板开关

保险丝座

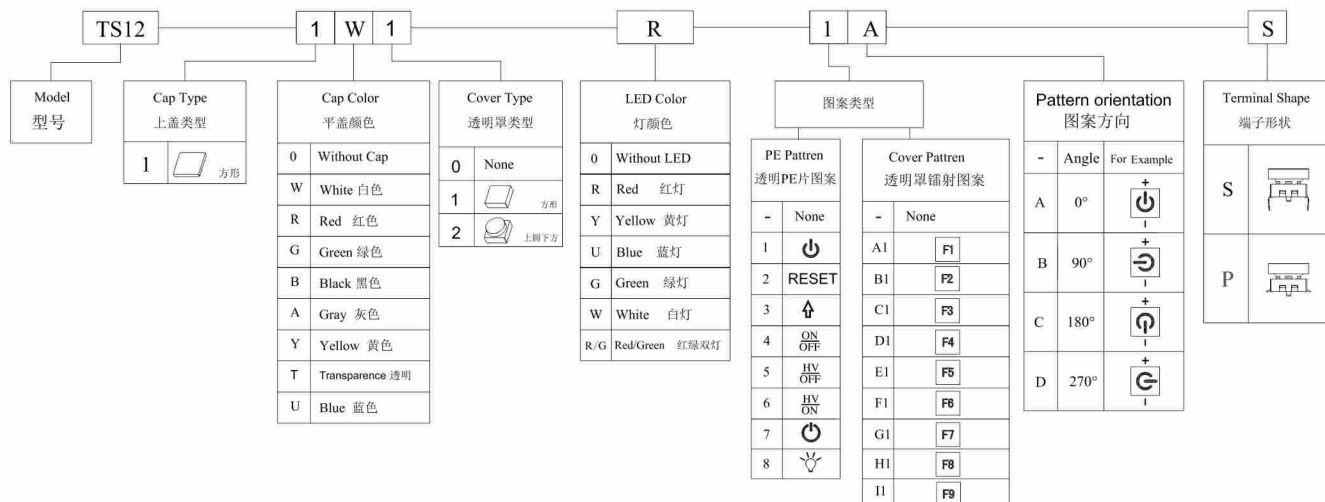

光电触摸开关

旋转开关

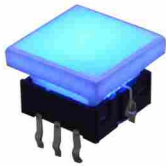

TS22-NU-U-0S



TS22-TW-R-1P



TS22-TW-Y-0S



## SPECIFICATIONS

Circuit	: SPST with LED
Current Rating	: 50mA
Voltage Rating	: 12VDC
Dielectric withstanding voltage	: 250VAC for 1 minute
Contact Resistance	: 100mΩ Max .(initial)
Insulation Resistance	: 100MΩ Min.
Operating Force	: 220±50gf
Total Travel	: 0.3±0.1mm
Operating Force	: 100,000 Cycles Min
Solder Specifications	: 260°C for 3 Seconds
Function	: Momentary
Operating Temperature	: -20°C ~ +70°C
Sealing	: IP67



TS22-NW-W-0S

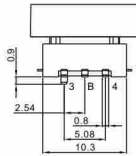
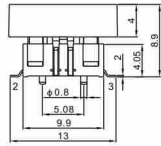
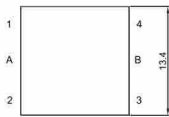

### SMT TYPE

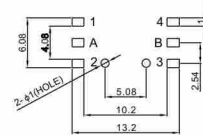

### SINGLE COLOR

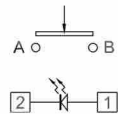

TS22-TW-W-1P

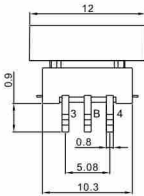
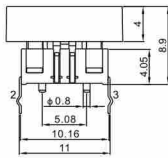

### P.C.B TYPE

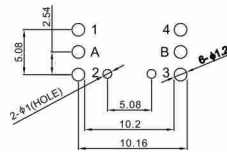

### TWO COLOR

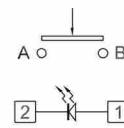

### RGB COLOR

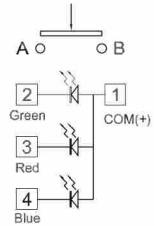

TS22	T	W	R	1	S
<b>Model</b> 型号	<b>Cap Color</b> 上盖颜色	<b>Diffuser Color</b> 散光片颜色	<b>LED Color</b> 灯颜色	<b>Legend</b> 图案	<b>Terminal Shape</b> 端子形状
T	Transparent 透明	W White 白色	N Without LED	0 None	S
R	Red 红色	R Red 红色	R Red 红灯	1	P
G	Green 绿色	G Green 绿色	Y Yellow 黄灯	2	SMT
Y	Yellow 黄色	Y Yellow 黄色	G Green 绿灯		
U	Blue 蓝色	U Blue 蓝色	U Blue 蓝灯		
0	None 无		W White 白灯		
			RG Red+Green 红+绿		
			RU Red+Blue 红+蓝		
			RGB Red+Green+Blue 红+绿+蓝		

带灯轻触开关

带灯按钮开关

按钮开关

金属按钮开关

翘板开关

保险丝座

光电触摸开关

旋转开关

# TS26 SERIES LED TACT SWITCHES

带灯轻触开关



TS26-4-TW-R-S



TS26-1-TW-G-S



TS26-1-TW-U-S



TS26-2-TW-Y-3A-S

## SPECIFICATIONS

Circuit	: SPST 1P1T with LED
Current Rating	: 50mA
Voltage Rating	: 12VDC
Dielectric withstanding voltage	: 250VAC for 1 minute
Contact Resistance	: 100mΩ Max. (initial)
Insulation Resistance	: 100MΩ Min.
Operating Force	: 250±50gf
Total Travel	: 0.4±0.15mm
Operating life	: 200,000 Cycles Min
Solder Specifications	: 260°C for 3 Seconds
Function	: Momentary
Operating Temperature	: -20°C ~ +70°C

带灯按钮开关

按钮开关



TS26-1-TW-G-S

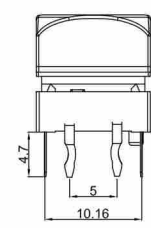
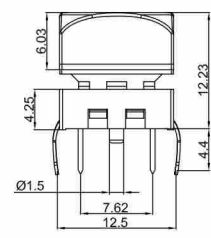
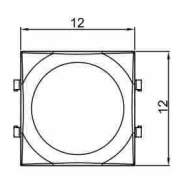

### CIRCUIT

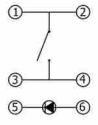

金属按钮开关



TS26-2-TW-R-2A-S

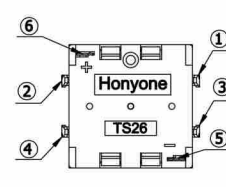
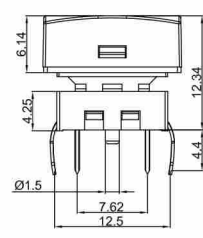
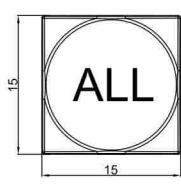

### P.C.B.LAYOUT

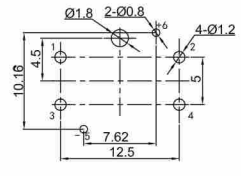

翘板开关

保险丝座

TS26	1	T W	R	0 A	S		
Model 型号	Cap Type 上盖形状	Cap Color 上盖颜色	Diffuser Color 散光片颜色	LED Color 灯颜色	Legend 图案	Pattern orientation 图案方向	Terminal Shape 端子形状
1		T Transparent 透明 R Red 红色 G Green 绿色 Y Yellow 黄色 U Blue 蓝色	W White 白色 R Red 红色 G Green 绿色 Y Yellow 黄色 U Blue 蓝色	N Without LED R Red 红灯 Y Yellow 黄灯 G Green 绿灯 U Blue 蓝灯 W White 白灯 R/G Red/Green 红/绿 R/U Red/Blue 红/蓝	- None 1 2 ALL 3 MUTE 4 DVI 1 5 HDMI 2	Angle For Example A 0° B 90° C 180° D 270°	S P

光电触摸开关

旋转开关



TS27-1-RW-R

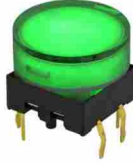

TS27-1-TW-G



TS27-1-TW-O-7A



TS27-1-TW-28A



## SPECIFICATIONS

Circuit	:SPDT
Current Rating	:50mA
Voltage Rating	:12VDC
Dielectric withstanding voltage	:250VAC for 1 minute
Contact Resistance	:100mΩ Max .(initial)
Insulation Resistance	:100MΩ Min.
Operating Force	:250±50gf
Total Travel	:0.4±0.15mm
Operating life	:200,000 Cycles Min
Solder Specifications	:260°C for 3 Seconds
Function	:Momentary
Operating Temperature	:-20°C~+70°C



TS27-1-TW-W

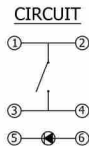
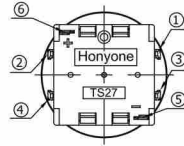
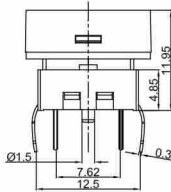
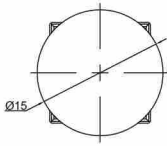

TS27-1-BW-U-1A

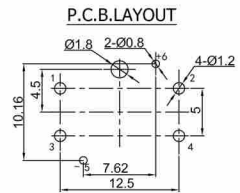
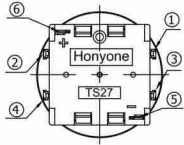
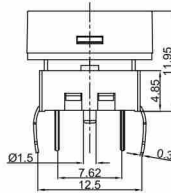
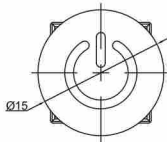

TS27	1	T	W	R	0	A	S				
<b>Model</b> 型号	<b>Cap Type</b> 上盖形状	<b>Cap Color</b> 上盖颜色		<b>Diffuser Color</b> 散光片颜色		<b>LED Color</b> 灯颜色		<b>Legend</b> 图案	<b>Pattern orientation</b> 图案方向		<b>Terminal Shape</b> 端子形状
1		T Transparent 透明	W White 白色	N Without LED	- None	1	A 0°	S	P  SMT		
		R Red 红色	R Red 红色	R Red 红灯	1	B 90°					
		G Green 绿色	G Green 绿色	Y Yellow 黄灯	3	C 180°					
		Y Yellow 黄色	Y Yellow 黄色	G Green 绿灯	4	D 270°					
		U Blue 蓝色	U Blue 蓝色	U Blue 蓝灯	5						
		B Black 黑色	B Black 黑色	W White 白灯	6						
				R/G Red/Green 红/绿							
				R/U Red/Blue 红/蓝							

见附表一

带灯轻触开关

带灯按钮开关

按钮开关

金属按钮开关

翘板开关

保险丝座

光电触摸开关

旋转开关